

T.36S.,R.1W.,W.M.





RECEIVED

APR 26 1999

WATER RESOURCES DEPT.  
SALEM, OREGON



SCALE 1" = 400'

-  = T-7662 (EPID)
-  = Cert. 75427 (No change from Permit No. 15987)
-  = Cert. 72476 (No change from Permit No. 17621)
-  = T-7661

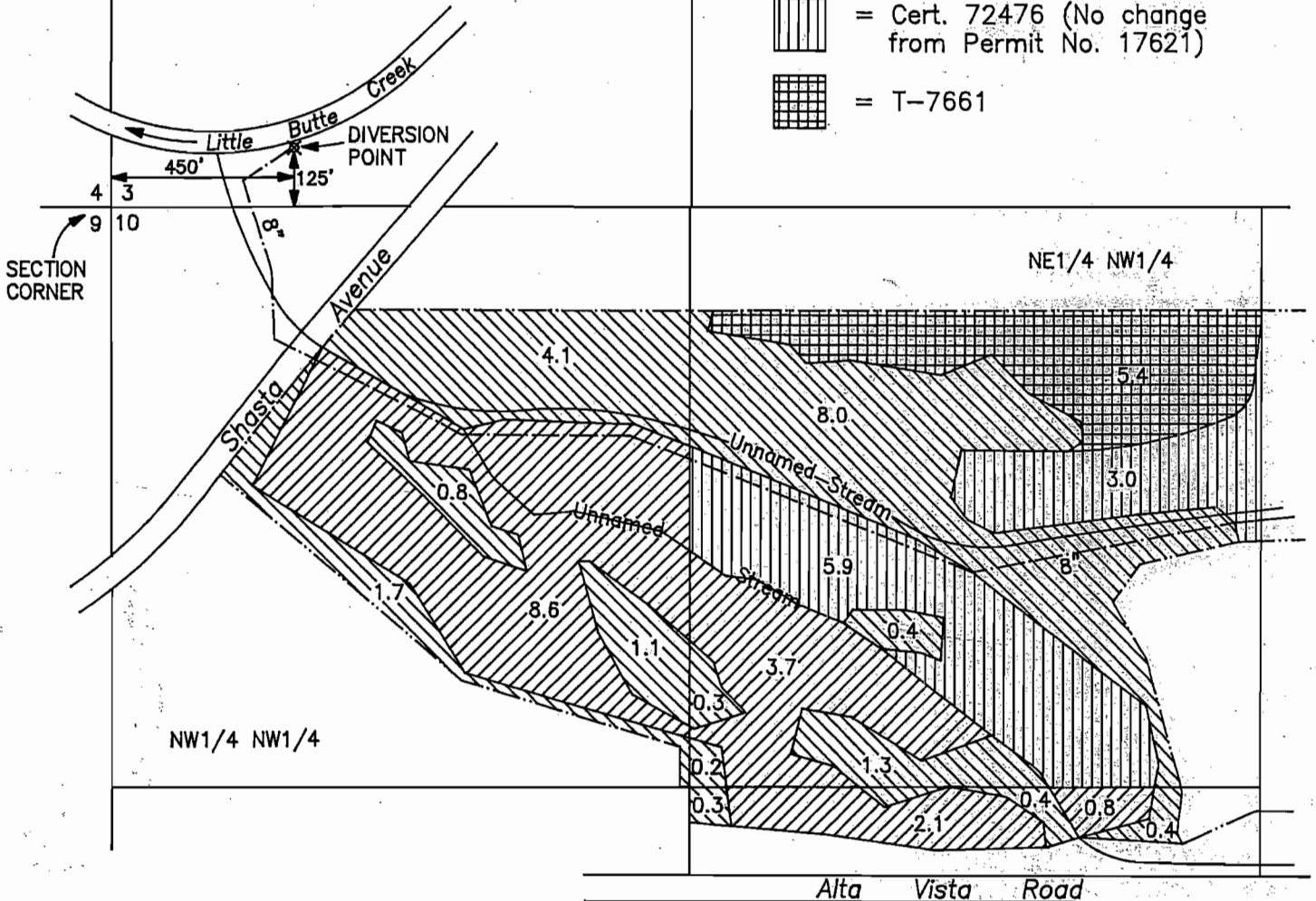

FINAL PROOF MAP

APPLICATION No. T-7660, T-7661,  
T-7662, T-7663 & T-7664

IN THE NAME OF  
EAGLE POINT GOLF CLUB, L.L.C.

MAP PREPARED MARCH 1, 1999  
BY GARY D. KAISER

SE1/4 NW1/4

NOTE: MAP PREPARED FOR  
WATER RIGHT PURPOSES ONLY,  
NOT FOR PROPERTY BOUNDARY  
LOCATIONS.

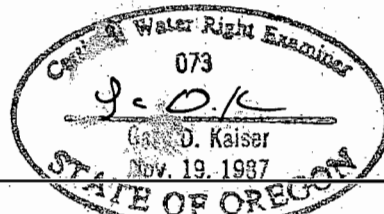

RECEIVED

APR 26 1999

WATER RESOURCES DEPT.  
SALEM, OREGON

T.36S., R.1W., W.M.

SHEET 2 OF 4

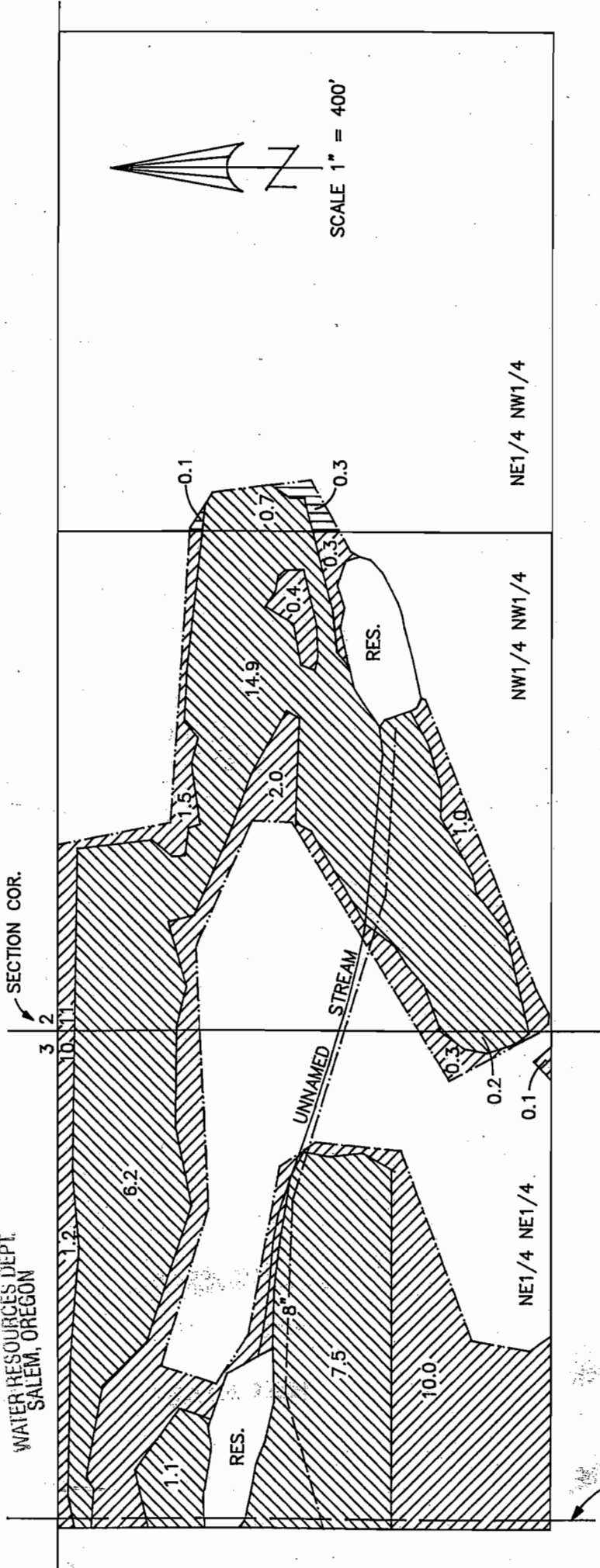

EAST BOUNDARY  
D.L.C. NO. 47



FINAL PROOF MAP

APPLICATION No. T-7660, T-7661,  
T-7662, T-7663 & T-7664

IN THE NAME OF  
EAGLE POINT GOLF CLUB, L.L.C.

NOTE: 1. MAP PREPARED FOR  
WATER RIGHT PURPOSES ONLY,  
NOT FOR PROPERTY BOUNDARY  
LOCATIONS.

2. FOR POINT OF DIVERSION  
T-7664 SEE SHEET 1 OF 4

-  = Cert. 75429 (EPID, No Change)
-  = T-7662 (EPID)
-  = T-7664 (Little Butte Irrigation Co.)

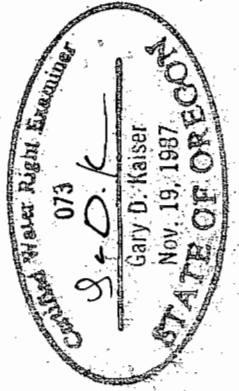

MAP PREPARED MARCH 1, 1999 BY GARY D. KAISER

T.36S.,R.1W.,W.M.



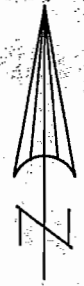

RECEIVED

APR 26 1999

WATER RESOURCES DEPT.  
SALEM, OREGON



SCALE 1" = 400'

-  = Cert. 75429 (EPID, NO Change)
-  = T-7662 (EPID)
-  = T-7660
-  = Cert. 75427 (No change from Permit No. 15987)

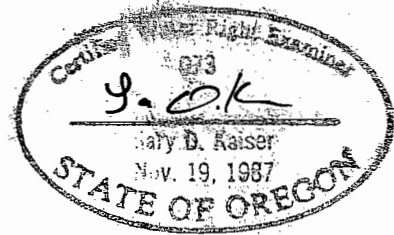

NOTE: 1. MAP PREPARED FOR WATER RIGHT PURPOSES ONLY, NOT FOR PROPERTY BOUNDARY LOCATIONS.

2. FOR POINT OF DIVERSION T-7660 AND CERT. 75427 SEE SHEET 1 OF 4

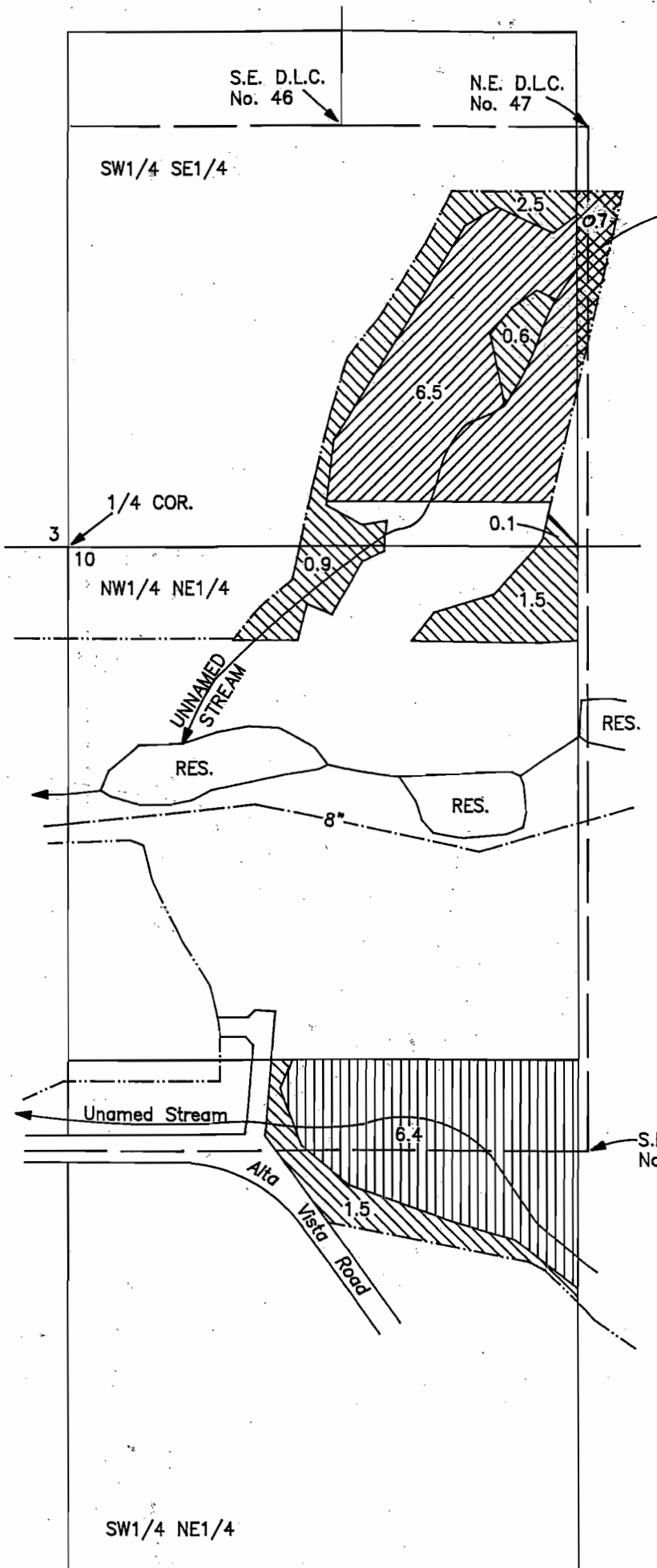

FINAL PROOF MAP

APPLICATION No. T-7660, T-7661,  
T-7662, T-7663 & T-7664

IN THE NAME OF  
EAGLE POINT GOLF CLUB, L.L.C.

MAP PREPARED MARCH 1, 1999  
BY GARY D. KAISER

T.36S.,R.1W.,W.M.

RECEIVED

APR 26 1999

WATER RESOURCES DEPT.  
SALEM, OREGON





SCALE 1" = 400'

3 2  
10 11  
SECTION COR.

NE1/4 NE1/4

SE1/4 NE1/4

-  = Cert. 75429 (EPID, No Change)
-  = T-7663

NOTE: 1. MAP PREPARED FOR WATER RIGHT PURPOSES ONLY, NOT FOR PROPERTY BOUNDARY LOCATIONS.

2. FOR POINT OF DIVERSION T-7663 SEE SHEET 1 OF 4.

S.E. COR.  
D.L.C.  
No. 47

2.0

11.0

3.9

Unnamed Stream

Alta Vista Road

FINAL PROOF MAP

APPLICATION No. T-7660, T-7661,  
T-7662, T-7663 & T-7664

IN THE NAME OF  
EAGLE POINT GOLF CLUB, L.L.C.

MAP PREPARED MARCH 1, 1999 BY GARY D. KAISER

