

# FINAL PROOF MAP

TO SHOW WATER RIGHTS AND  
POINTS OF APPROPRIATION  
FOR APPLICATION G-16257  
ANDY ROOT

**RECEIVED**

DEC 30 2011

TOWNSHIP 23 SOUTH, RANGE 32 EAST, SECTION 18, W.M.  
TAX LOT: 2500 HARNEY COUNTY, OREGON

WATER RESOURCES DEPT  
SALEM, OREGON

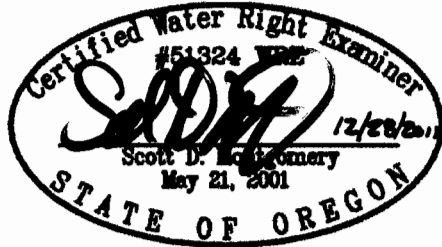

RENEWAL DATE: 12/31/2012

THIS MAP IS FOR THE PURPOSE OF LOCATING A WATER  
RIGHT ONLY AND HAS NO INTENT TO PROVIDE LEGAL  
DIMENSIONS OR THE LOCATION OF PROPERTY LINES

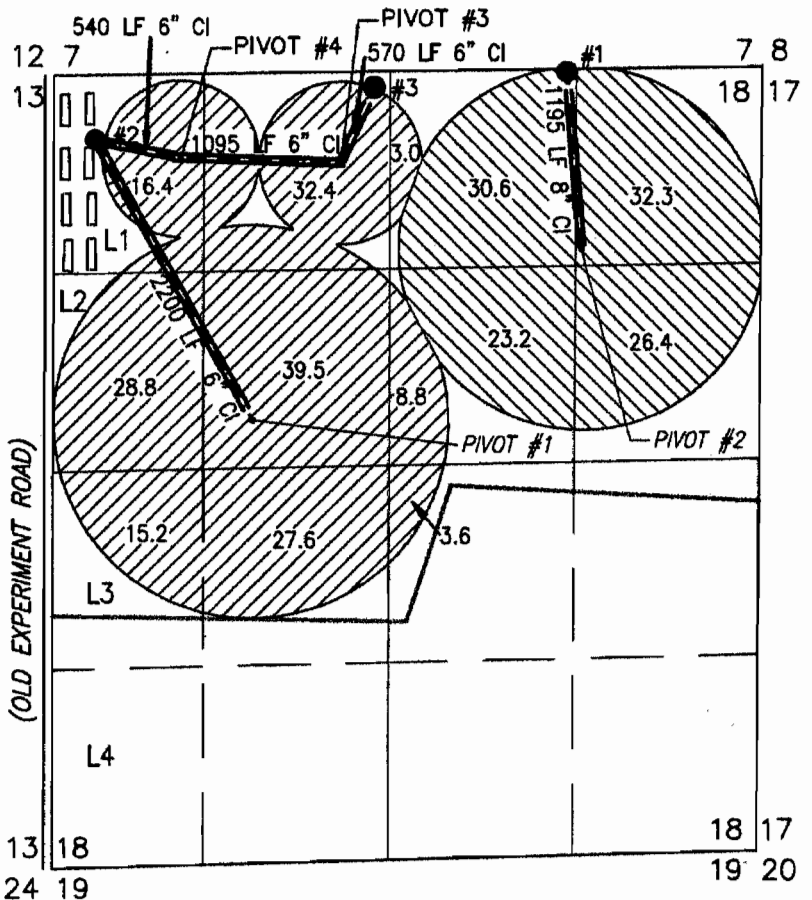

- #1  
WELL #1 (HARN 50927) PERMIT: G-15942  
50' SOUTH & 3520' EAST FROM THE NW  
CORNER SECTION 18
- #2  
WELL #2 (HARN 51150) PERMIT: G-15942  
410' SOUTH & 300' EAST FROM THE NW  
CORNER SECTION 18.
- #3  
WELL #3 (HARN 51157) PERMIT: G-15942  
140' SOUTH & 2200' EAST FROM THE NW  
CORNER SECTION 18.

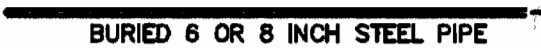

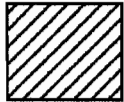
 175.3 ACRES PRIMARY IRRIGATION FROM  
WELLS 2 & 3, G-15942, AS SHOWN

 112.5 ACRES PRIMARY IRRIGATION  
FROM WELL 1, G-15942, AS SHOWN

PREPARED FOR:  
ANDY ROOT  
524 HIGHWAY 20 N  
HINES, OR 97738

PREPARED BY:  
 ALL POINTS ENGINEERING AND SURVEYING, INC.  
P.O. BOX 767 (CRR) TERREBONNE, OR 97760  
(541) 548-5833 [www.APEandS.com](http://www.APEandS.com)