

# T 25 S, R 30 E, WM

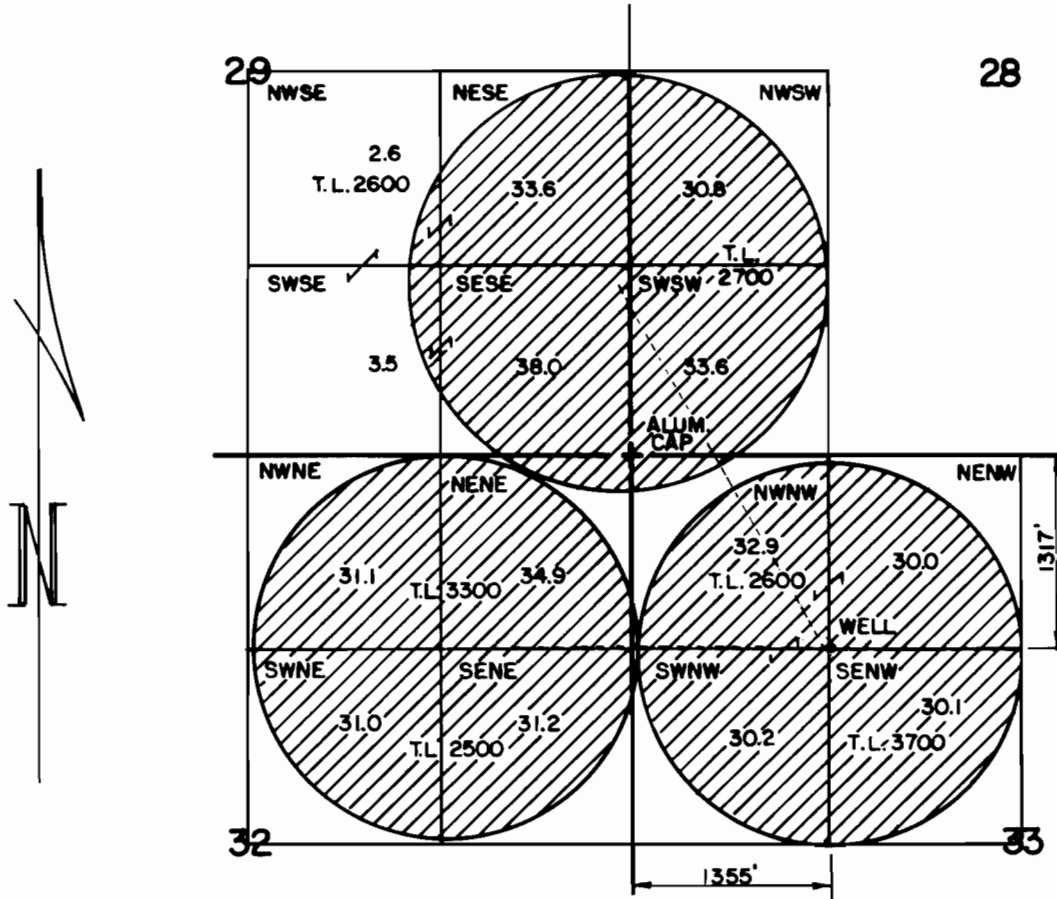

THE PURPOSE OF THIS MAP IS TO IDENTIFY THE LOCATION OF THE WATER RIGHT. IT IS NOT INTENDED TO PROVIDE INFORMATION RELATIVE TO THE LOCATION OF PROPERTY OWNERSHIP.

**RECEIVED**

JUL 02 2001

WATER RESOURCES DIVISION  
SALEM, OREGON

## FINAL PROOF SURVEY

UNDER APPLICATION NO. G-14136  
PERMIT NO. G-12841

IN THE NAME OF  
DENNY LAND & CATTLE  
CO, LLC

Scale: 4" = 1 MILE

Date: JUNE 2001

Job: 1990

Dsn:

Dm: CHRIS

Gkd:



M.A. PALMER & SONS, INC.  
ENGINEERING & SURVEYING  
711 Ponderosa Village • Box 61  
Burns, Oregon 97720

Sht. No.

of 1



RENEW 1-1-2003