

CLAIM OF BENEFICIAL USE AND FINAL PROOF MAP

**J H HERSCHER
FAMILY PARTNERSHIP,
JOAN LAMOREAUX**

T34S, R07E, Sec. 22, W.M.
KLAMATH COUNTY, OREGON

APPLICATION No. S-71135
PERMIT No. S-52790

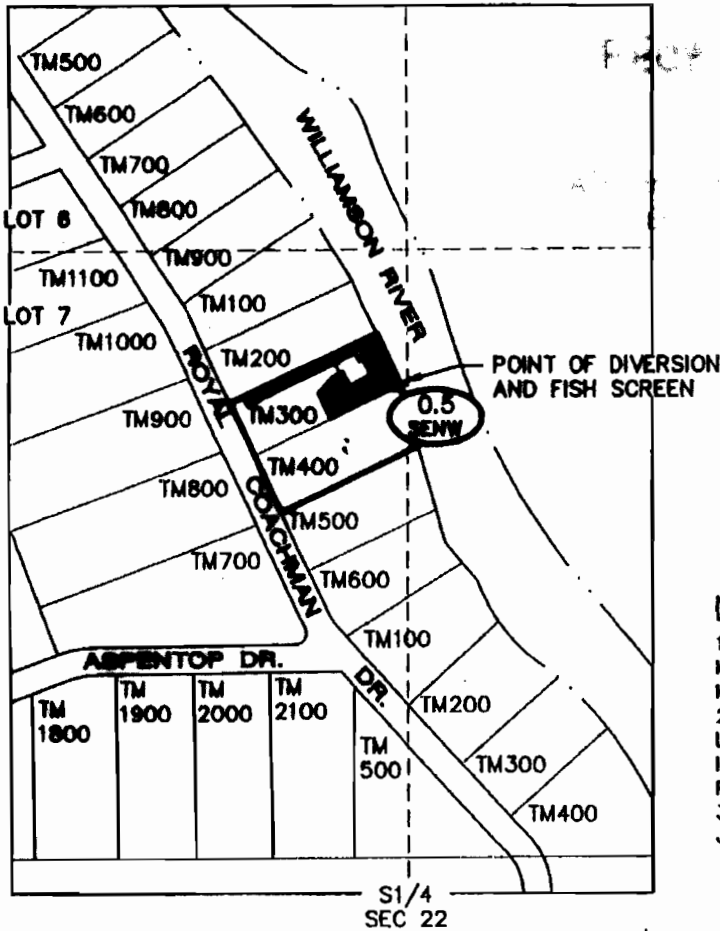

NOTES:

1. THIS MAP WAS PREPARED FROM FIELD MEASUREMENTS, NAIP 2005 AERIAL PHOTOGRAPH AND KLAMATH COUNTY TAX MAP 340722CD.
2. THE PURPOSE OF THIS MAP IS TO IDENTIFY THE LOCATION OF THE WATER RIGHT ONLY, AND IS NOT INTENDED TO PROVIDE DIMENSIONS OR LOCATION OF PROPERTY LINES.
3. DATE OF PRIORITY FOR THIS APPLICATION IS JANUARY 18, 1991.

TOTAL ACRES IRRIGATED
THIS CLAIM: 0.5Ac.

LEGEND

- TOTAL ACRES IRRIGATED PER 1/4 1/4
- IRRIGATED LANDS THIS CLAIM OF BENEFICIAL USE
- 1/4 1/4 SECTION
- TM300 TAX MAP NUMBER
- LOT 3 GOVERNMENT LOT NUMBER
- 16 SECTION DESIGNATION

P.O.D. BE:
1,030' NORTH, 30' WEST FROM
THE SOUTH 1/4 CORNER SECTION
22.

Joan Lamoreaux
Applicant signature

- IRRIGATION PIPE
- 1/4 1/4 LINE
- SECTION LINE
- ROADS

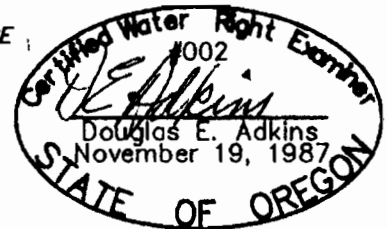

RENEWAL 1/1/13

ADKINS
SINCE 1983
CONSULTING ENGINEERS, INC. Engineers ▲ Planners ▲ Surveyors
2950 Shasta Way · Klamath Falls, Oregon 97603 · (541) 884-4888 · FAX (541) 864-5335
Klamath Falls, Oregon
3/15/11 Lamoreaux-base 3008-01

**Claim of Beneficial Use
and Final Proof Map**
for
**J H HERSCHER FAMILY PARTNERSHIP,
JOAN LAMOREAUX**
Klamath County, Oregon