

Authorized Div. Pt. is 2150' S. and 3000' E. of the NW Cor. Sec. 29 - C-63763

SCALE 1"=1320'

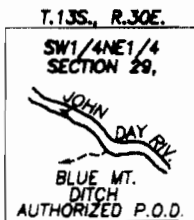

FINAL PROOF SURVEY
 UNDER TRANSFER NO. T-8603
 SPECIAL ORDER VOL. 57, PAGE 118
 FOR
TRANSFER OF PLACE OF USE

IN NAME OF

NEIL J. BAUER





BY

ROBERT D. BAGETT
 BAGETT, GRIFFITH & BLACKMAN
 P.O. BOX 476
 JOHN DAY, OR. 97845
 (541) 575-1251

SEPTEMBER 15, 2005

- FOUND BRASS CAP MONUMENT
- EXISTING PUMP
- (XXX) TAX LOT NO.
- EXISTING MAINLINE

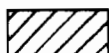
PLACE OF USE

-  C-63763
-  C-25540
-  C-25540 REMAINING RIGHTS
-  PERMIT 47938 REMAINING RIGHTS
C-63763

NOTE: THE PREPARATION OF THIS MAP WAS FOR THE PURPOSE OF IDENTIFYING THE LOCATION OF THE PROPOSED WATER RIGHT AND HAS NO INTENT TO PROVIDE DIMENSIONS OR LOCATION OF PROPERTY OWNERSHIP LINES.

RECEIVED

SEP 30 2005

WATER RESOURCES DEPT
 SALEM, OREGON

