

T. 5N. R. 28E., W.M.,  
UMATILLA COUNTY, OREGON

FINAL PROOF SURVEY

UNDER

Application No. G-13624 Permit No. G-12292  
IN NAME OF

**MONTE D. BURMESTER**

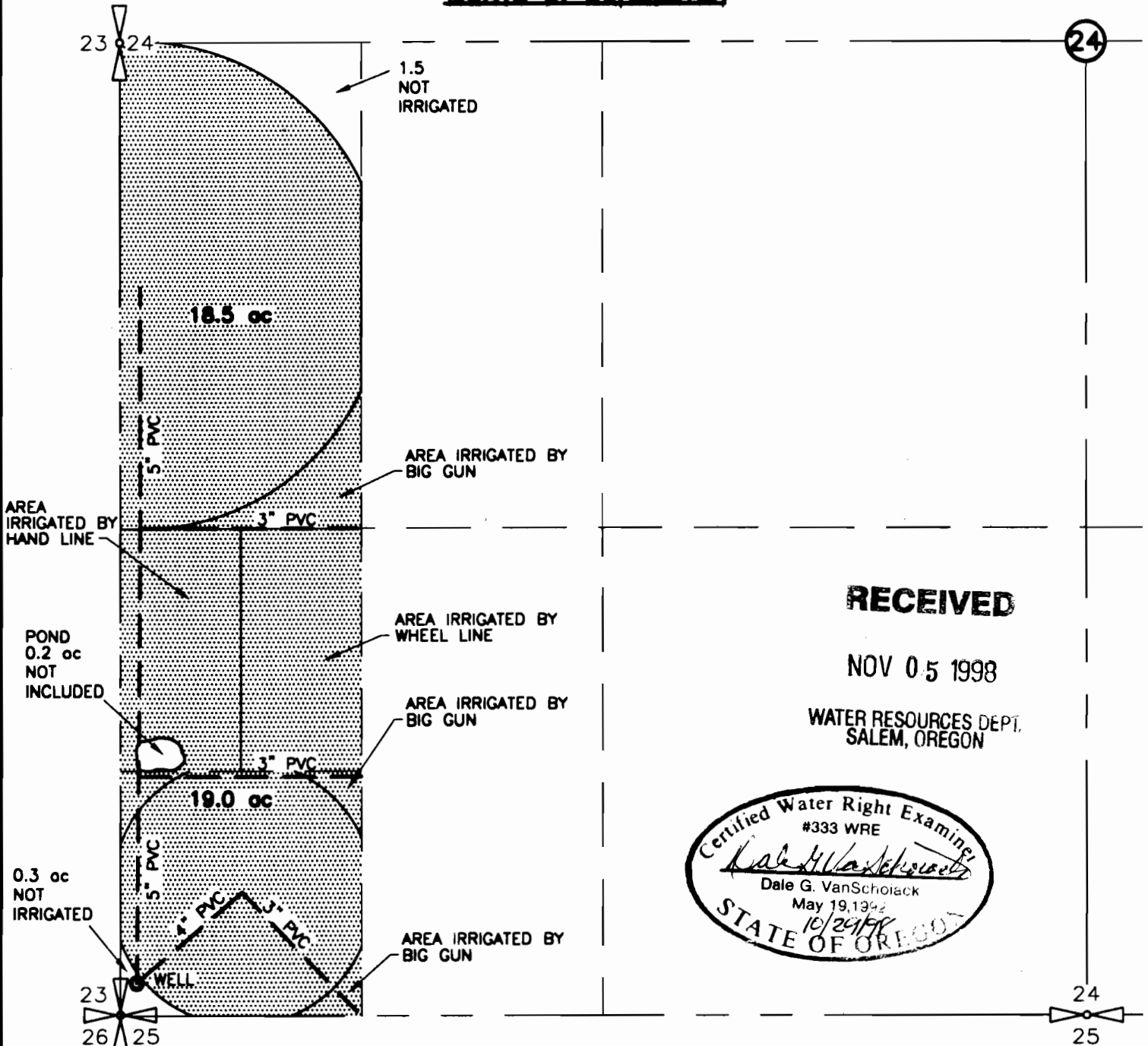
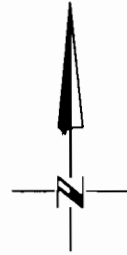

**RECEIVED**

NOV 05 1998

WATER RESOURCES DEPT.  
SALEM, OREGON

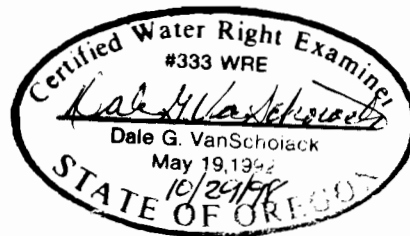

P.O.A. WELL IS LOCATED AT 90' N & 45'E OF  
S.W. CORNER OF SECTION 24

 AREA IRRIGATED

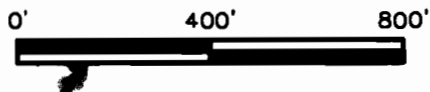

NOTE: THE PURPOSE OF THIS MAP IS TO IDENTIFY THE APPROXIMATE LOCATION OF THE WATER RIGHT. IT IS NOT INTENDED TO PROVIDE INFORMATION RELATIVE TO THE LOCATION OF PROPERTY OWNERSHIP BOUNDARY LINES.

 Architects & Engineers  
Kennewick, WA 98336

3522.019  
3522-019.DWG  
09/15/98