

0 660 1,320 2,640 3,960 5,280 Feet

# T 16 S, R 19 E, WM SECTIONS 19 & 30

1" = 1320'

## CROOK COUNTY, OREGON

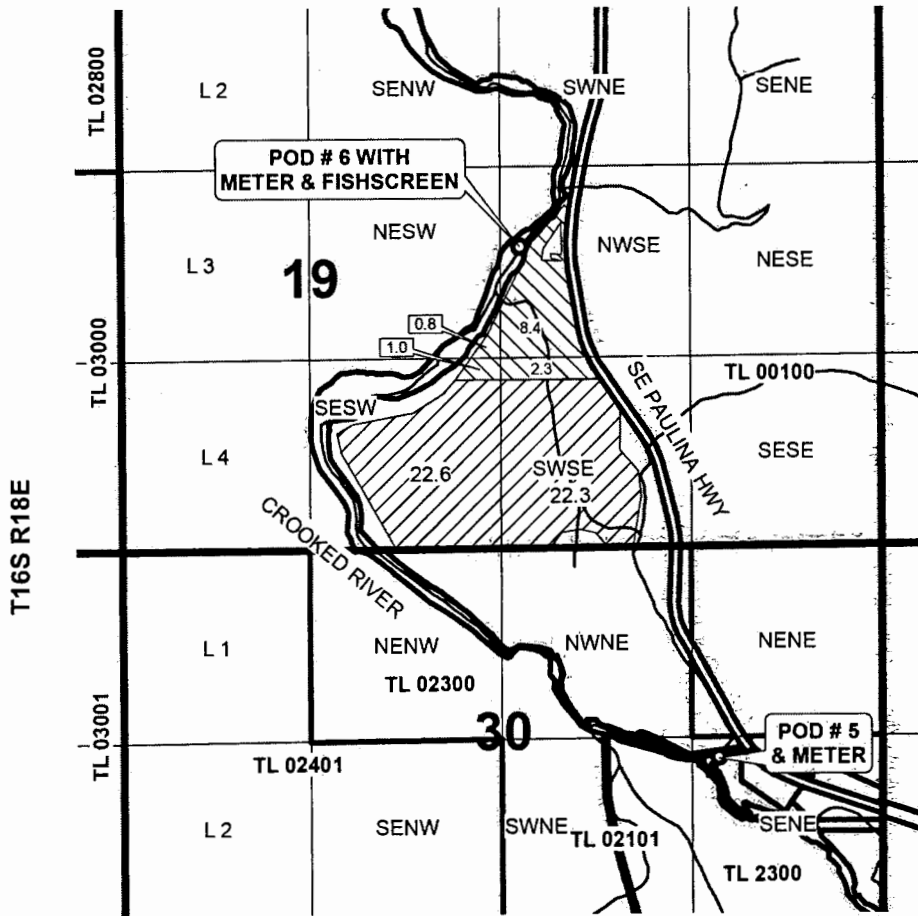





RECEIVED BY OWRD

SEP 30 2013

SALEM, OR

POD # 5 - 1470' S, 1120' W OF SE CORNER, SECTION 19  
POD # 6 - 2050' N, 2490' W OF SE CORNER, SECTION 19

-  CERT SUPERCEDING CANCELLED CERT 86200
-  CERT SUPERCEDING CANCELLED CERT 86197
-  TAX LOTS
-  SECTIONS

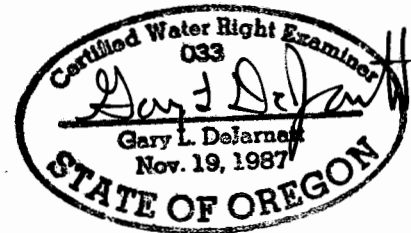

RENEWAL DATE: 12-31-2013

### CLAIM of BENEFICIAL USE MAP for BONNIEVIEW RANCH

JOB # 13076    TRANSFER T-11150

This map is not intended  
to provide legal dimensions  
or locations of property  
ownership lines.

SEPT 20, 2013

### WATER RIGHT SERVICES, LLC

PO BOX 1830, BEND, OR 97709

WWW.OREGONWATER.US 541-389-2837

johnshort@usa.com    CCB # 197221