

App 48890  
Per 36629

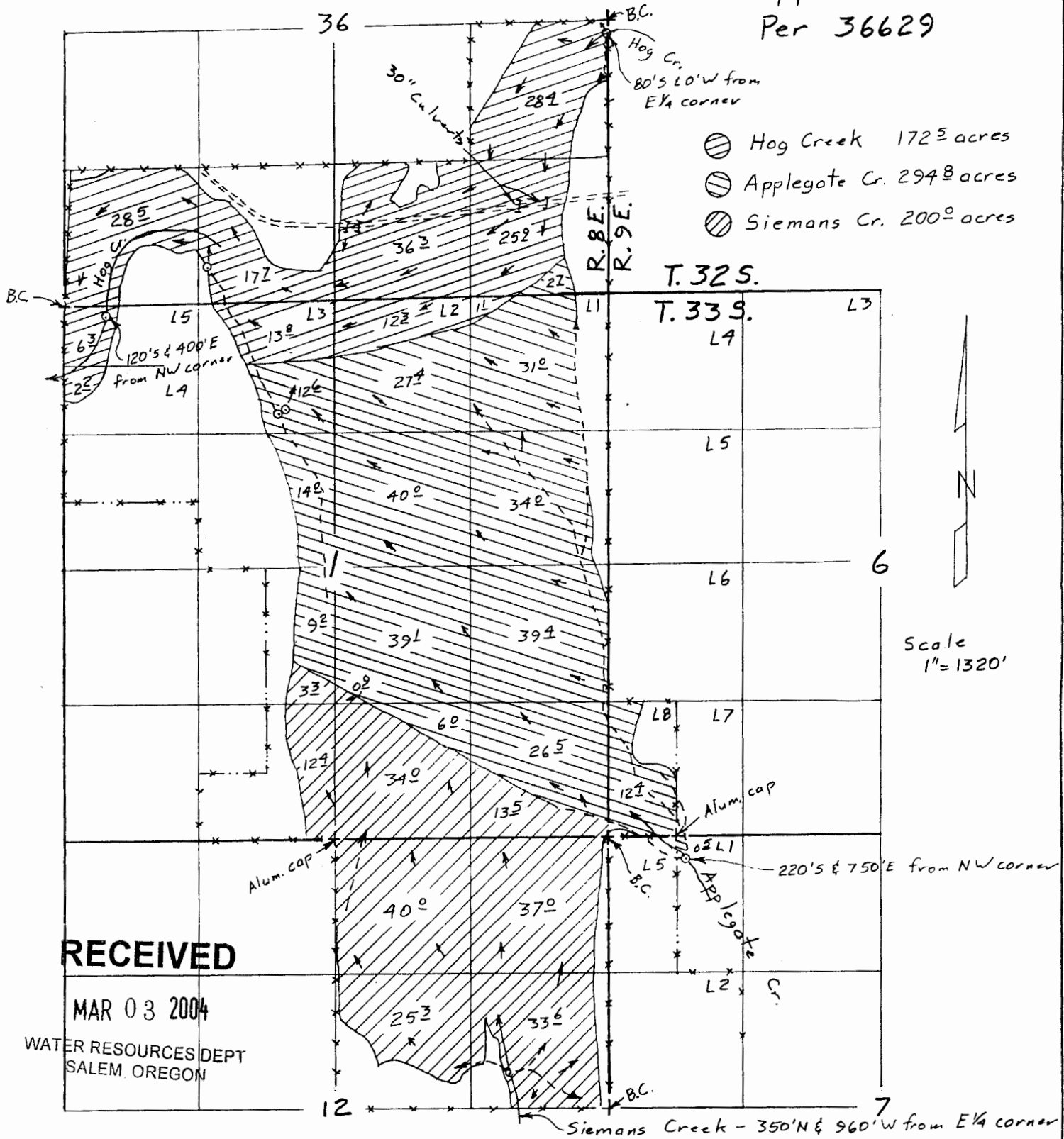

**RECEIVED**

MAR 03 2004

WATER RESOURCES DEPT  
SALEM, OREGON

Claim of Beneficial Use Map  
for Badger Almond Company

c/o Agriculture Industries, Inc.

Surveyed Oct 10, 2003

This map is for the purpose of  
locating a water right only  
and has no intent to provide  
legal dimensions or the location  
of property lines.

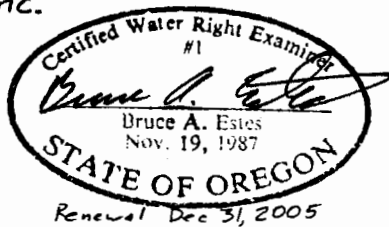

**ESTES SURVEYS, LLC**  
 PO Box 17519      60382 Arnold Rd  
 Salem, OR 97305-7519      Bend, OR 97702  
 (503) 585-7593      (541) 382-7391