

SCALE: 1" = 1320'

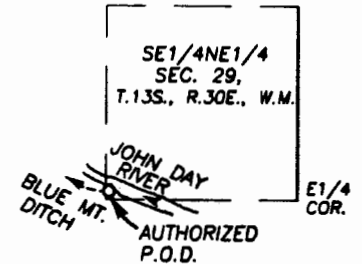

ADDITIONAL DIV. PT. IS 740' S. AND 1260' W. OF THE NE COR. SEC. 26
 AUTHORIZED DIV. PT. IS 80' N. AND 1310' W. OF THE E 1/4 COR. SEC. 29, T13S, R30E - C-65852

FINAL PROOF SURVEY
 UNDER TRANSFER NO. T-9332
 SPECIAL ORDER VOL. 60, PAGE 839
 FOR
ADDITIONAL POINT OF DIVERSION
 IN NAME OF
STEVE & CAROL WALKER

SURVEYED BY ROBERT D. BAGETT
 BAGETT-GRIFFITH & BLACKMAN
 217 N. CANYON BLVD.
 JOHN DAY, OREGON
 (541) 575-1251

SEPTEMBER 7, 2005

- T.L. TAX LOT
- FOUND BRASS CAP MONUMENT
- EXISTING PUMP
- EXISTING MAINLINE
-  PLACE OF USE C-65852

NOTE: THE PREPARATION OF THIS MAP WAS FOR THE PURPOSE OF IDENTIFYING THE LOCATION OF THE PROPOSED WATER RIGHT AND HAS NO INTENT TO PROVIDE DIMENSIONS OR LOCATION OF PROPERTY OWNERSHIP LINES.

RECEIVED

SEP 28 2005

WATER RESOURCES DEPT
 SALEM, OREGON

