

T6N, R35E, S33 WM
UMATILLA COUNTY

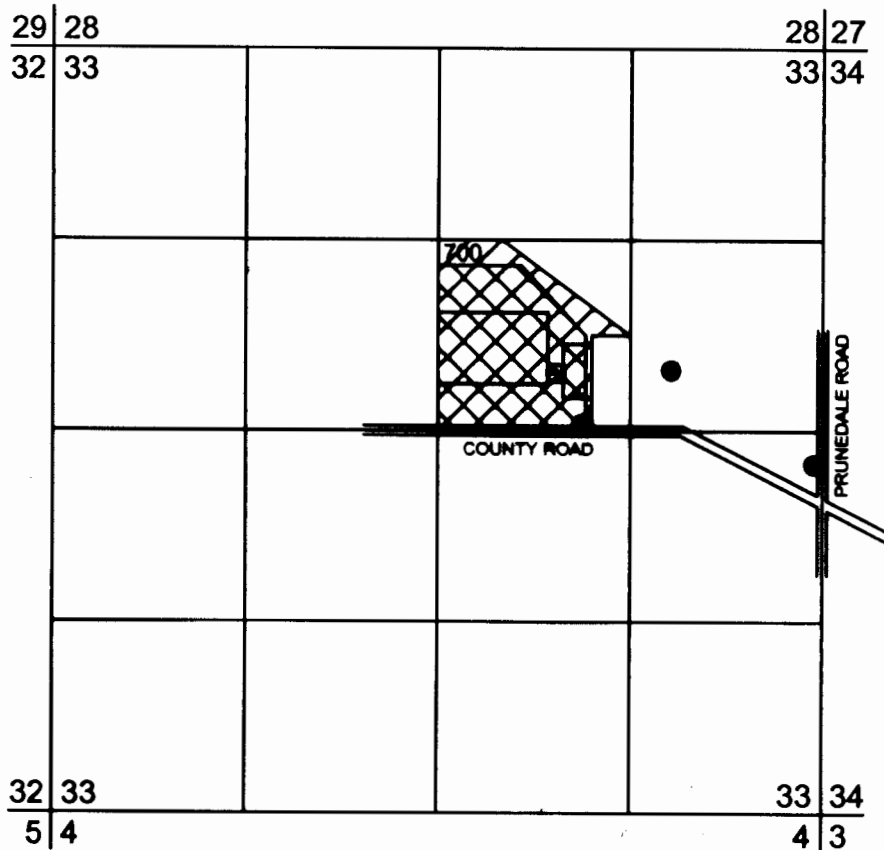

1 in = 1320 ft



POA is well, 10-inch diameter, 200 feet deep with 25 horsepower submersible pump, located in the SW/4, NE/4 Section 33, 405 feet North and 810 feet East from the Center of Section 33.



Former POAs are no longer used to supply water to this place of use.



PLACE OF USE authorized under G-4900 and G-5000 is 5.24 acres in Tax Lot 700 in the SW/4, NE/4 Sec 33.



PLACE OF USE authorized under G-4998, G4900 and G-5000 is 24.00 acres in Tax Lot 700 located in SW/4, NE/4 of Section 33.



WATER CONVEYANCE
Water distributed from well with buried PVC mainlines (6-inch to west and 4-inch to east), and applied to orchard (west) with undertree & overhead sprinklers and vineyard (east) with drip lines & overhead sprinklers.

CWRE Stamp & Signature

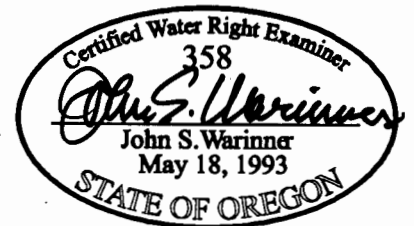

The purpose of this map is to identify the location of a water right. It is not intended to provide information regarding the location of property ownership boundary lines.

FOUNTAINHEAD

1860 Blue Creek Road - Walla Walla, WA 99362

Phone: 509.529.2646 Fax: 509.522.5251

FINAL PROOF SURVEY MAP

TRANSFER T-8500

in the name of

Premiere Partners IV Ltd Partnership

PO Box 3009

Champaign, Illinois 61926-3009

Revised by John Warinner 10 MAR 2006