

T6N, R35E, S33 WM
UMATILLA COUNTY

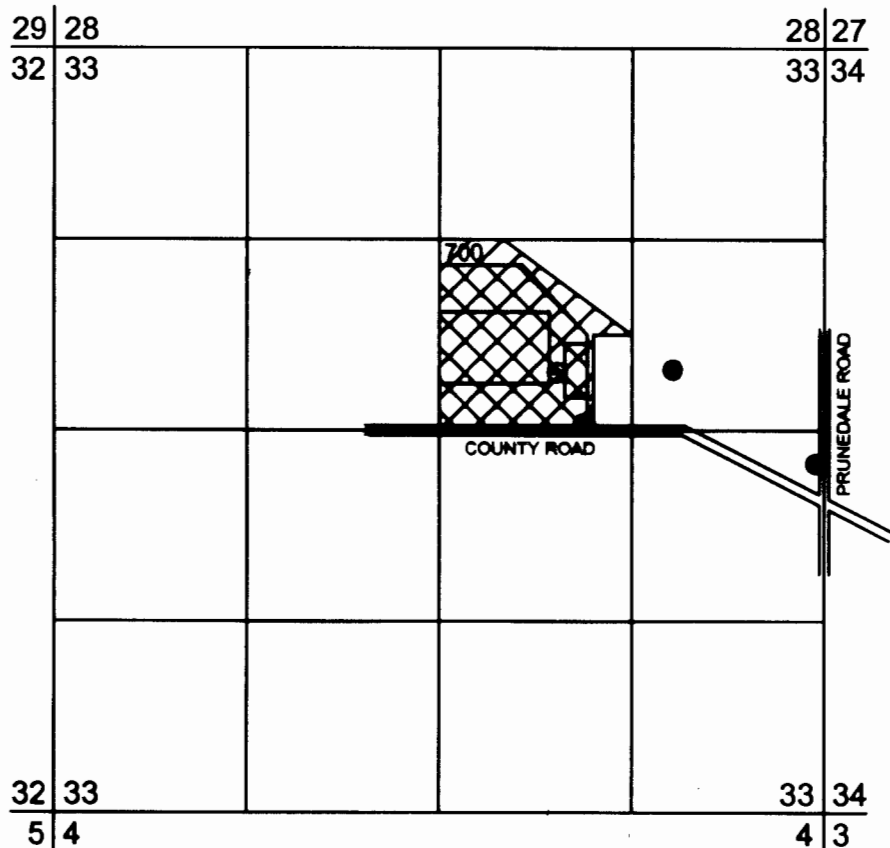



1 in = 1320 ft



○ POA is well, 10-inch diameter, 200 feet deep with 25 horsepower submersible pump, located in the SW/4, NE/4 Section 33, 405 feet North and 810 feet East from the Center of Section 33.

● Former POAs are no longer used to supply water to this place of use.

 PLACE OF USE authorized under G-4900 and G-5000 is 5.24 acres in Tax Lot 700 in the SW/4, NE/4 Sec 33.

 PLACE OF USE authorized under G-4998, G4900 and G-5000 is 24.00 acres in Tax Lot 700 located in SW/4, NE/4 of Section 33.

--- WATER CONVEYANCE
Water distributed from well with buried PVC mainlines (6-inch to west and 4-inch to east), and applied to orchard (west) with undertree & overhead sprinklers and vineyard (east) with drip lines & overhead sprinklers.

CWRE Stamp & Signature

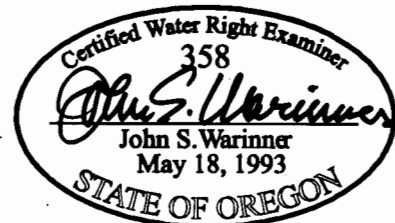

The purpose of this map is to identify the location of a water right. It is not intended to provide information regarding the location of property ownership boundary lines.

FOUNTAINHEAD

1860 Blue Creek Road - Walla Walla, WA 99362

Phone: 509.529.2646 Fax: 509.522.5251

FINAL PROOF SURVEY MAP

TRANSFER T-8500

in the name of

Premiere Partners IV Ltd Partnership

PO Box 3009

Champaign, Illinois 61926-3009

Revised by John Warinner 10 MAR 2006