

Final Proof Survey

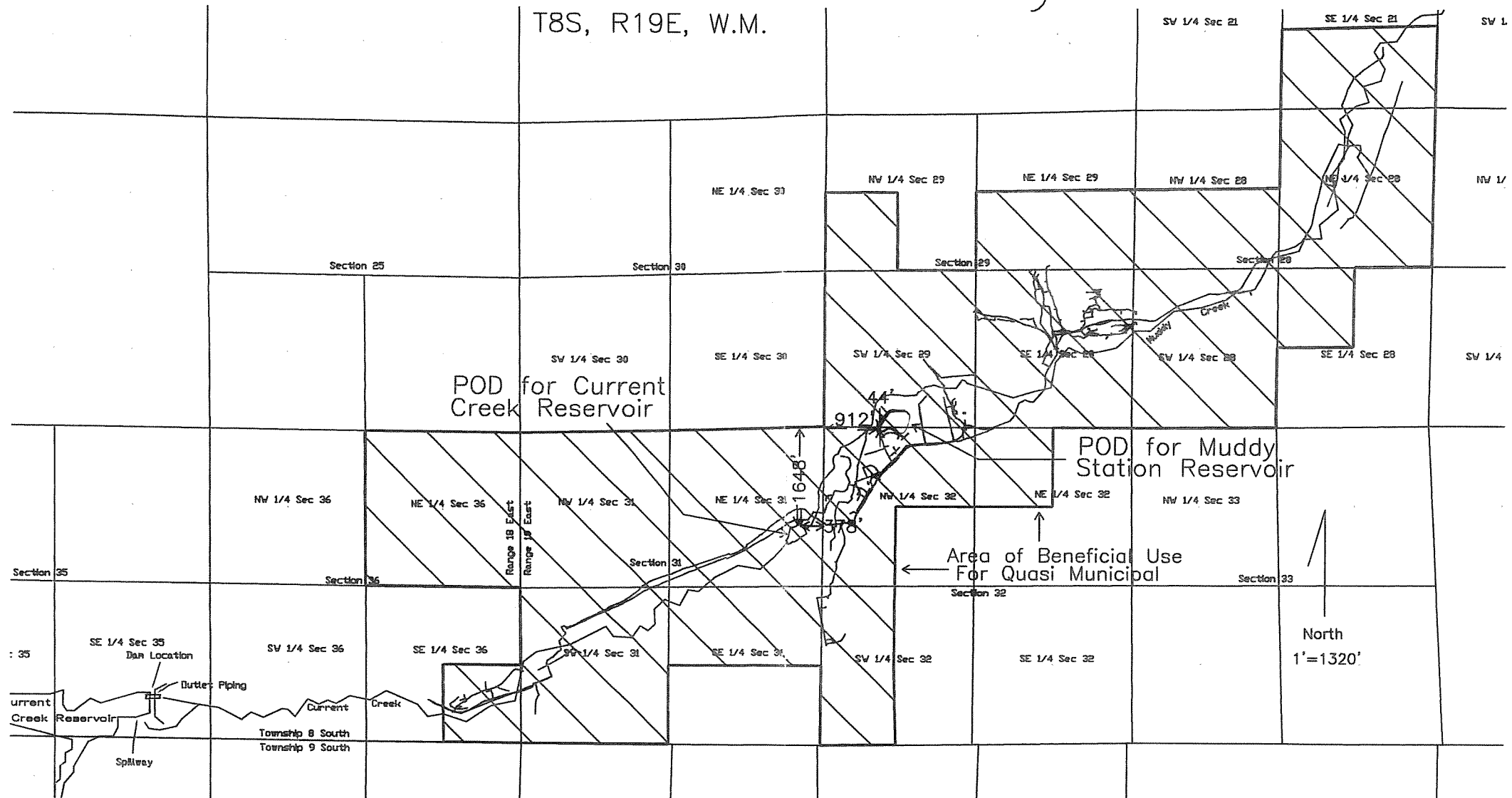

RECEIVED
 AUG 04 2005
 WATER RESOURCES DEPT
 SALEM, OREGON

Muddy Station POD Dimensions measured 912' E & 44' S of NW corner of Sect. 32, T8S, R19E, W.M.
 Current Creek POD Dimensions measured 1648' S & 378' W of NE corner of Sect 31, T8S, R19E, W.M.

- 3" to 10" Irrigation Water Main Lines Shown
- Muddy Station Reservoir POD located in the SW 1/4 of the SW 1/4 of Section 28, T8S, R19E, W.M.
- Current Creek Reservoir POD located in the SE 1/4 of the NE 1/4 of Section 31, T8S, R19E, W.M.

Application Number: S-83453
 Permit Number: S-53506
 Surface Right for Quasi-Municipal Use
 In the name of: Young Life
 Surveyed on May 3, 2005

This map was prepared for the purpose of identifying the location of the water right only. It is not intended to provide dimensions or location of property ownership lines.

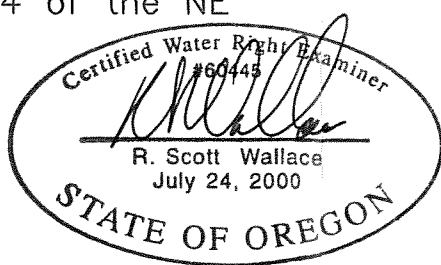

EXPIRATION DATE: 06/30/06