

FINAL PROOF SURVEY MAP

T 5 S R 1 W sections 21 & 22

RECORDED
SEP 15 2015
REGISTERED
CLERK OF COURTS

Prepared for: Fessler Family, LLC
transfer T-6992

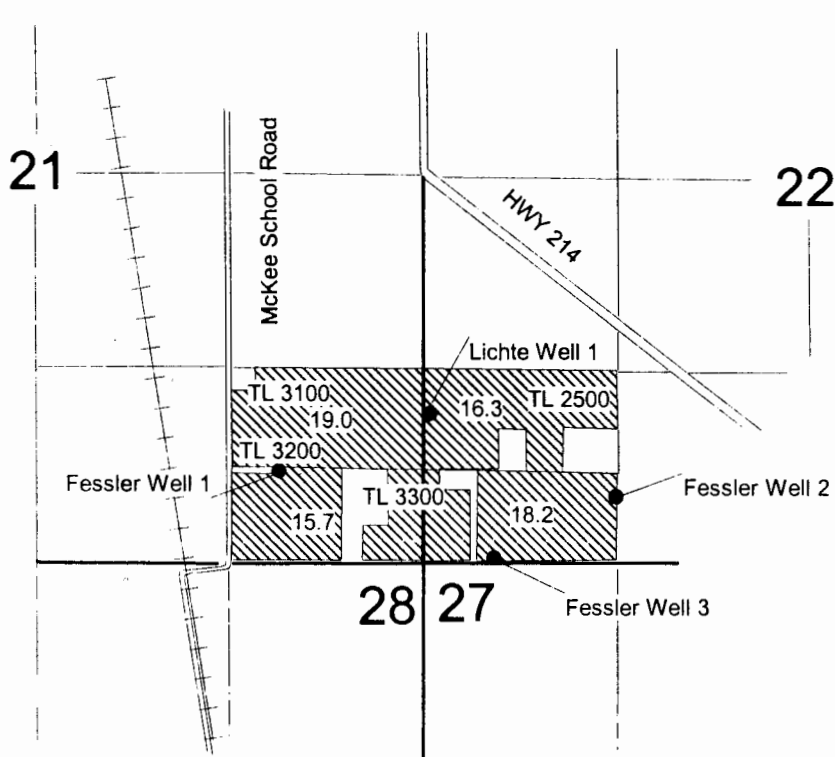

Lichte Well 1: 1040' N & 20' E
Fessler Well 1: 630' N & 1000' W
Fessler Well 2: 550' N & 1290' E
Fessler Well 3: 20' N & 460' E
all from the SW corner Section 22
(All wells have measuring devices at well site.)

1" = 1320'



This map is for water
right purposes only.

