

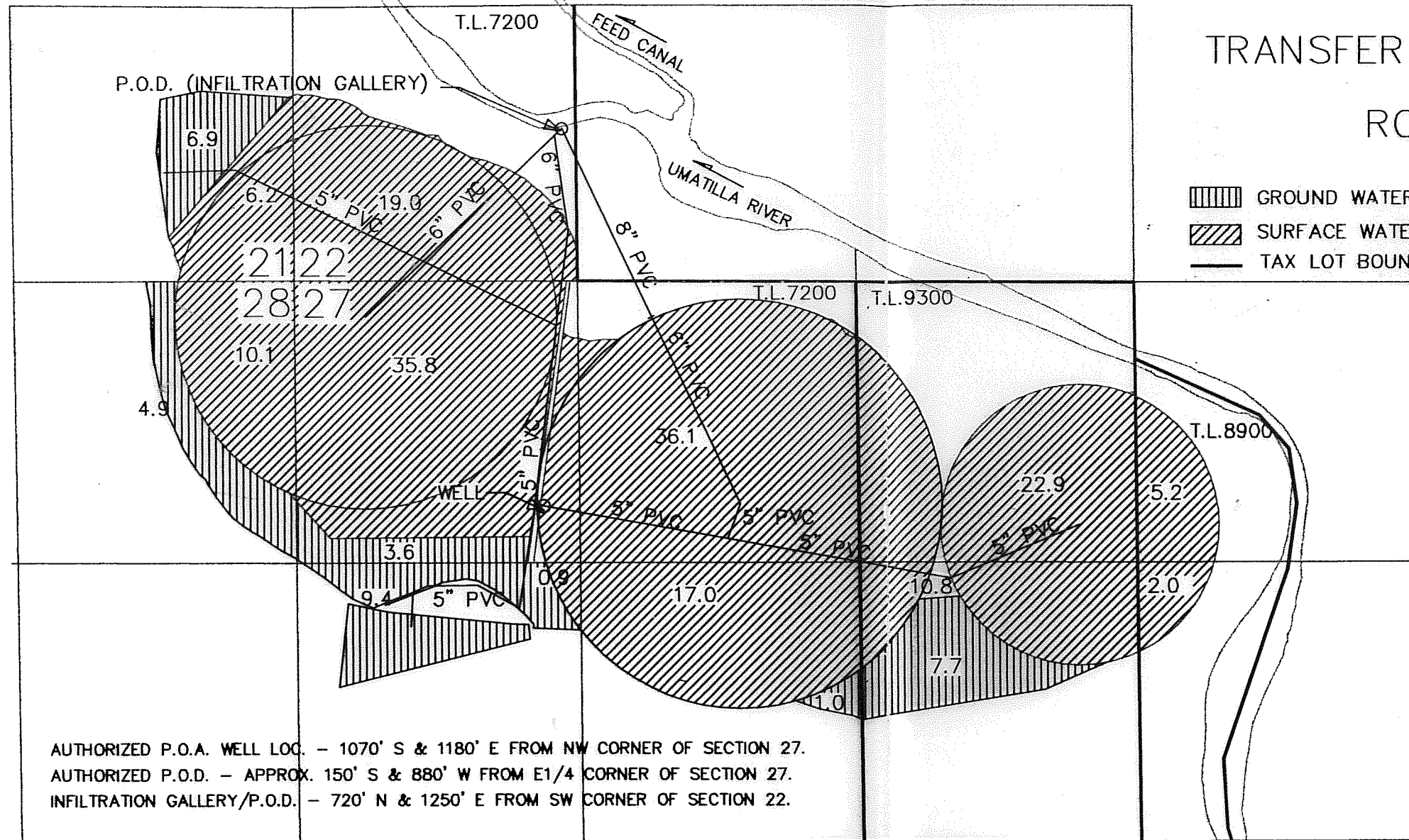



T. 3 N., R. 29 E., W.M.

FINAL PROOF SURVEY

UNDER
TRANSFER NOS. 7156 & 8431
IN NAME OF
RON HOLEMAN



-  GROUND WATER RIGHT
-  SURFACE WATER RIGHT
-  TAX LOT BOUNDARY



SCALE 1" = 660'

AUTHORIZED P.O.A. WELL LOC. - 1070' S & 1180' E FROM NW CORNER OF SECTION 27.
 AUTHORIZED P.O.D. - APPROX. 150' S & 880' W FROM E1/4 CORNER OF SECTION 27.
 INFILTRATION GALLERY/P.O.D. - 720' N & 1250' E FROM SW CORNER OF SECTION 22.

The preparation of this map is for the purpose of identifying the location of water rights only, and has no intent to provide dimensions or locations of property ownership lines.

AUTHORIZED P.O.D.

RECEIVED

SEP 11 5000

STATE OF OREGON
WATER RESOURCES DEPT.

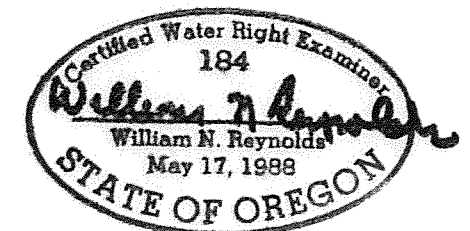

RECEIVED

APR 27 1993

WATER RESOURCES DEPT.
SALEM, OREGON

T. 3 N., R. 29 E., W.M.

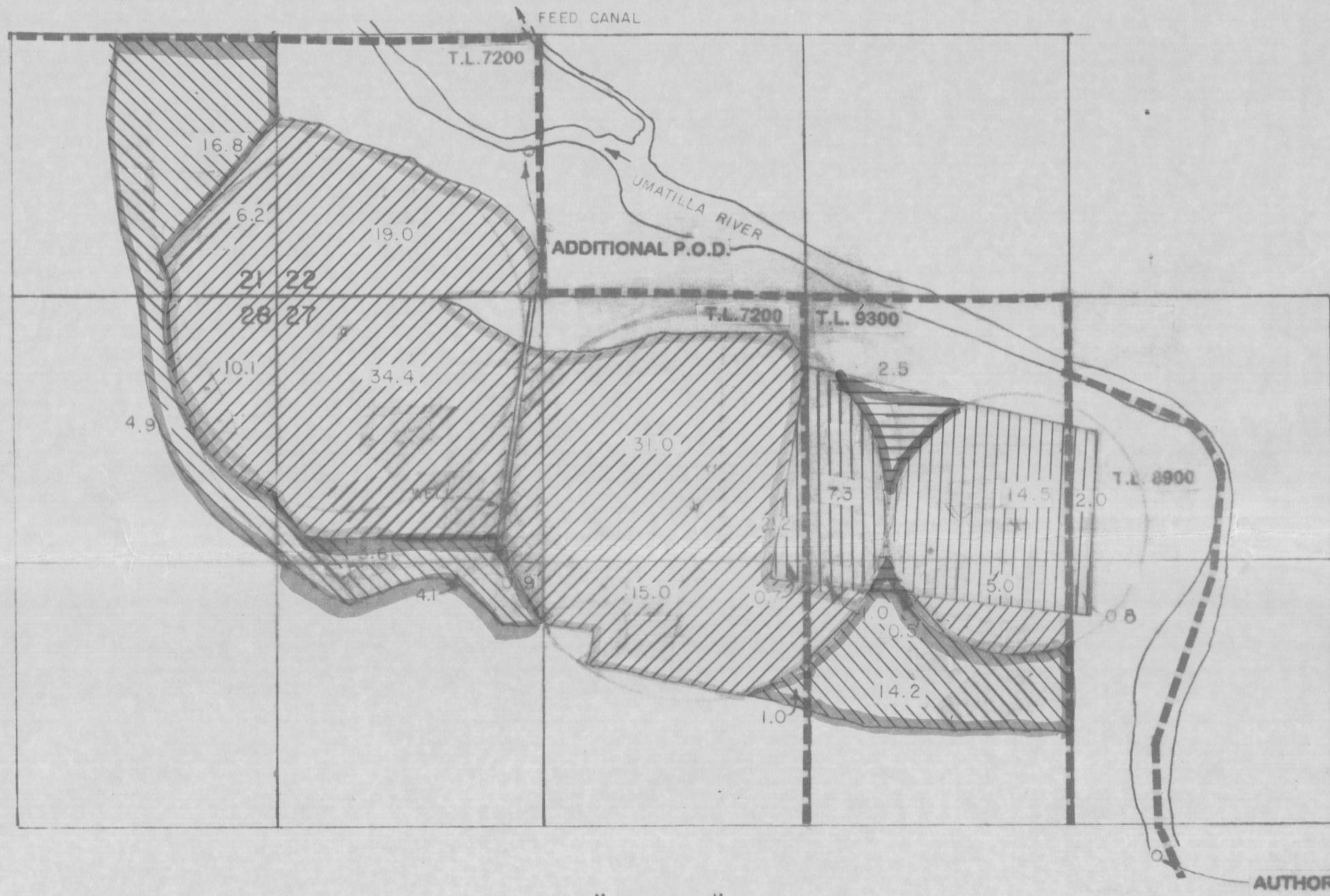



"FROM"

(1) AUTHORIZED P.O.D. - APPROX. 150' S & 880' W FROM E1/4 CORNER OF SECTION 27, T 3 N, R 29 E, W.M.

(2) WELL AUTHORIZED P.O.A. - 1070' S & 1180' E FROM NW CORNER OF SECTION 27, T 3 N, R 29 E, W.M.

 WATER RIGHT UNDER CERTIFICATE NO. 2507 - NOT SUBJECT TO THIS TRANSFER.

 WATER RIGHT UNDER CERTIFICATE NO. 2507 - SUBJECT TO THIS TRANSFER

 WATER RIGHT UNDER CERTIFICATE NO. 53080 - NOT SUBJECT TO THIS TRANSFER.

 WATER RIGHT UNDER CERTIFICATE NO. 53080 - SUBJECT TO THIS TRANSFER.

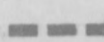
 TAX LOT BOUNDARY

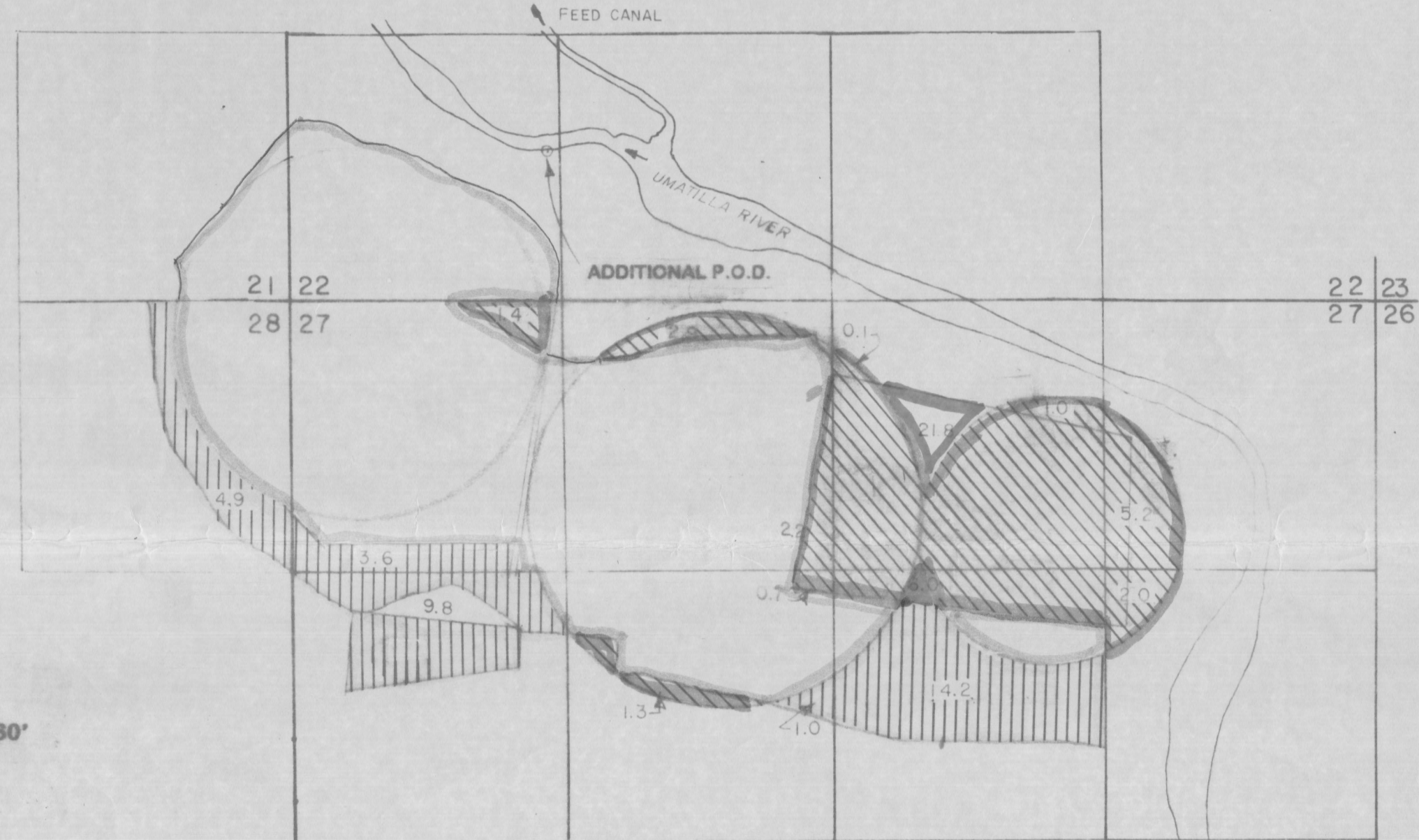

"TO"

(1) PROPOSED ADD'L P.O.D. - 720' N & 1250' E FROM SW CORNER, SECTION 22, T 3 N, R 29 E, W.M.

TRANSFER APPLICATION PLACE OF USE & POINT OF APPROPRIATION

UNDER

UMATILLA DECREE - V.3, PG.2507 (1)
Application No. G-7728 Permit No. G-7367 (2)

IN NAME OF

RON HOLEMAN

The preparation of this map is for the purpose of identifying the location of water rights only, and has no intent to provide dimensions or locations of property ownership lines.

William H. Regulator

REV. 4/21/98

4/21/94
REVISED - 11/8/94
REV. 10/3/96