

T.6S. R.1W. Section 24, W.M.

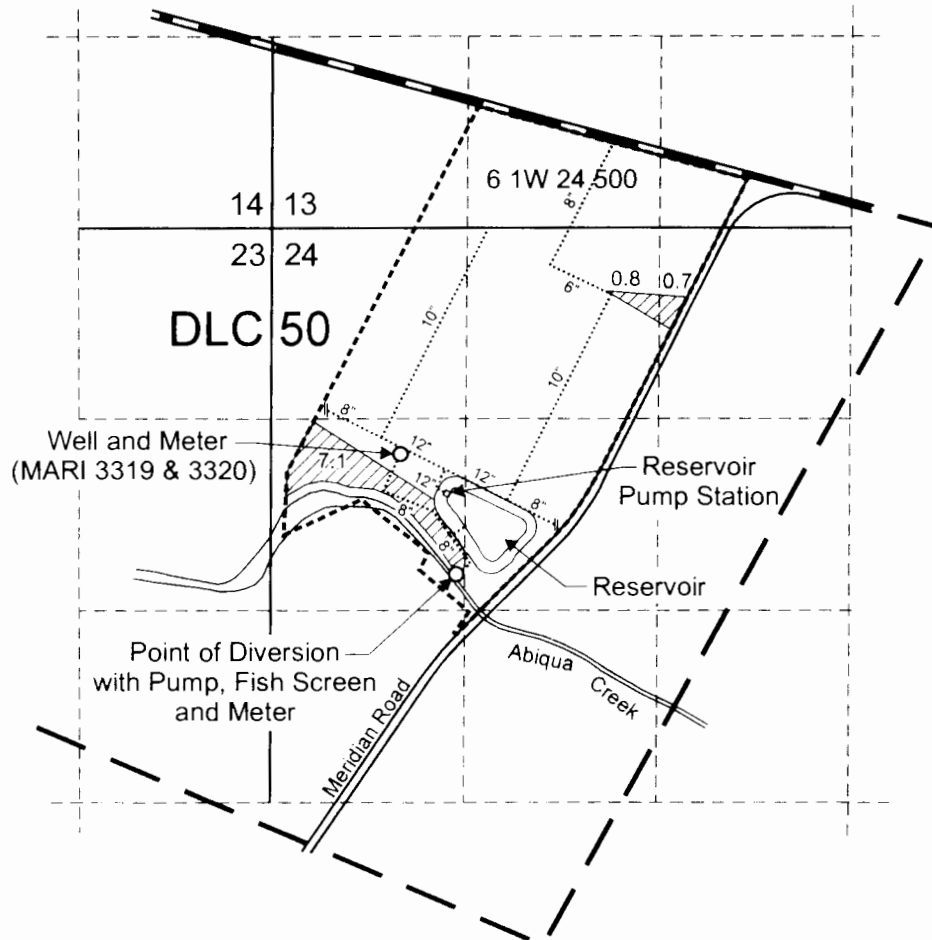

Well (MARI 3319 & 3320) is located 1,080 feet north and 890 feet east from the W 1/4 Corner, Section 24.

Point of diversion is located 250 feet north and 1,270 feet east from the W 1/4 Corner, Section 24.

Area (8.6 Acres) irrigated and subject to supplemental irrigation under Transfer 9906

Tax lot boundary

10" Irrigation mainline

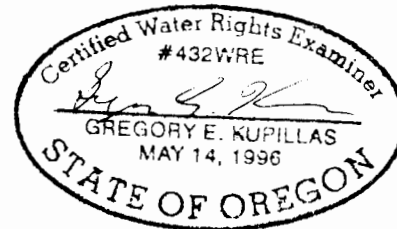

EXPIRATION DATE: 6/20/2011

Scale: 1" = 1,320'

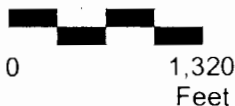

This map was prepared for the purpose of identifying the location of a water right only and is not intended to provide legal dimensions or location of property ownership lines.

Claim of Beneficial Use Map
T-9906

Paul Kraemer
T.6S. R.1W. Section 24, W.M.

Pacific Hydro-Geology Inc.

9/2009