

**PERMITTED AREA OF USE**

IN T.2.S., R.38 E., W.M., UNION COUNTY, OREGON

**SECTION 34**

S.W. 1/4  
W 1/2 OF THE S.E. 1/4

IN T.3 S., R.38 E., W.M. UNION COUNTY, OREGON

**SECTION 3**

W 1/2 OF THE N.E. 1/4  
N.W. 1/4  
S.W. 1/4  
W 1/2 OF THE S.E.1/4

**SECTION 4**

E 1/2 OF THE N.E. 1/4  
E 1/2 OF THE S.E. 1/4

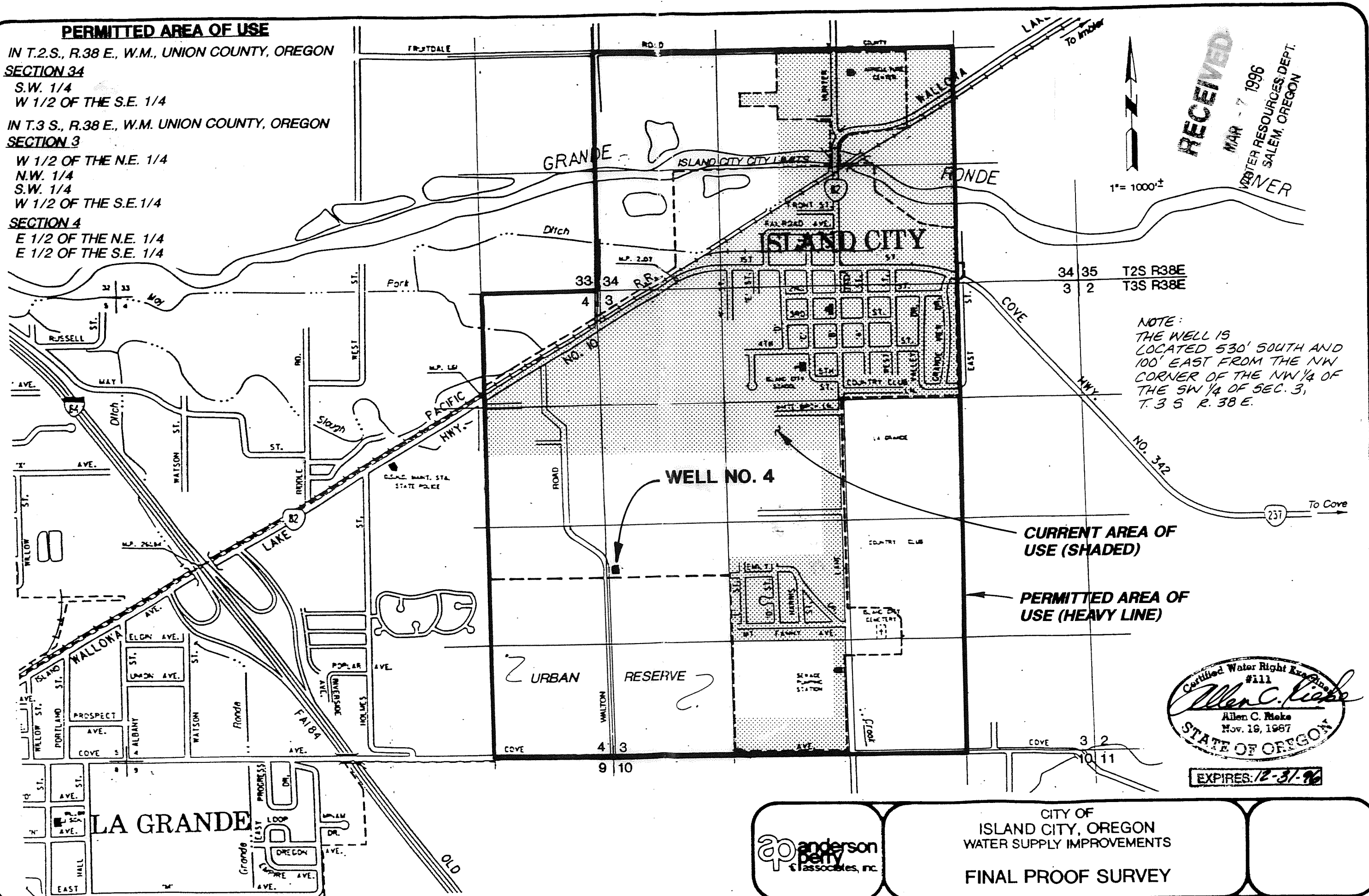

**RECEIVED**  
MAR - 7 1996  
WATER RESOURCES DEPT.  
SALEM, OREGON

1" = 1000'

34 35 T2S R38E  
3 2 T3S R38E

NOTE:  
THE WELL IS  
LOCATED 530' SOUTH AND  
100' EAST FROM THE NW  
CORNER OF THE NW 1/4 OF  
THE SW 1/4 OF SEC. 3,  
T.3 S. R. 38 E.

**CURRENT AREA OF  
USE (SHADED)**

**PERMITTED AREA OF  
USE (HEAVY LINE)**

Certified Water Right Examination  
#111  
*Allen C. Riels*  
Allen C. Riels  
Nov. 19, 1987  
STATE OF OREGON

EXPIRES: 12-31-96



CITY OF  
ISLAND CITY, OREGON  
WATER SUPPLY IMPROVEMENTS  
**FINAL PROOF SURVEY**