

Authorized Place of Use

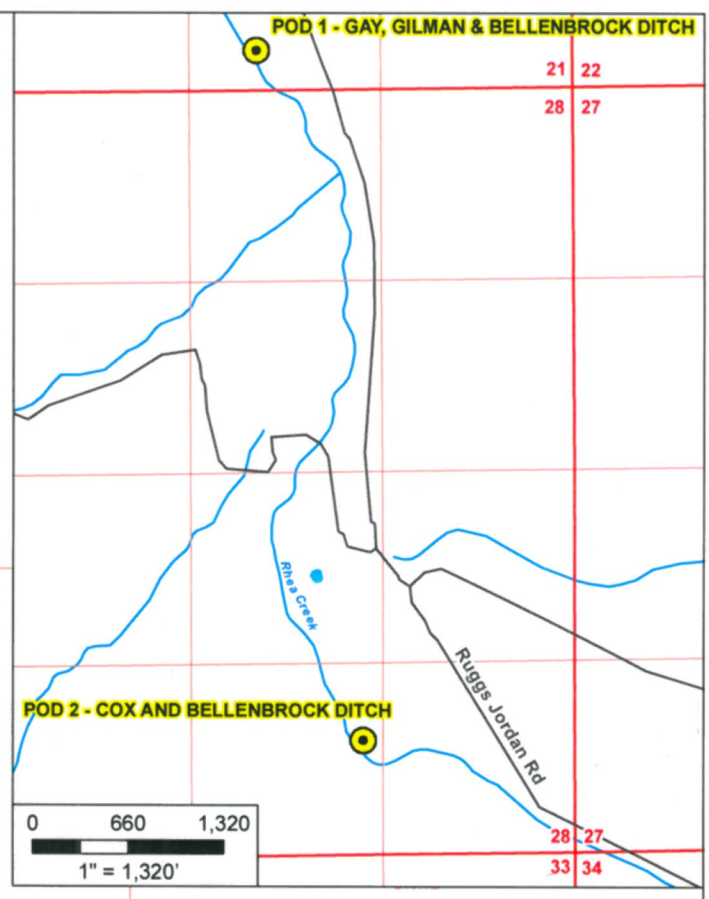

LOCATION DESCRIPTIONS:
 POD 1: Located 310 feet North and 2,220 feet West from the Southeast Corner of Section 21, Township 3 South, Range 25 East, (W.M.)
 POD 2: Located 800 feet North and 1,450 feet West from the Southeast Corner of Section 28, Township 3 South, Range 25 East (W.M.)

LEGEND
 Point of Diversion (POD)
Place of Use (POU)
 Priority 1874
 Priority 1879
 Remaining Right not Involved in Cert. 78513 Transfer, Priority 1874
 Road
 Watercourse
Disclaimer
 This map was prepared for the purpose of identifying the location of a water right only and it is not intended to provide legal dimensions or location of property ownership lines.
Map Notes
 Date: April 9, 2014
 Data Sources: BLM, OWRD, ORMAP

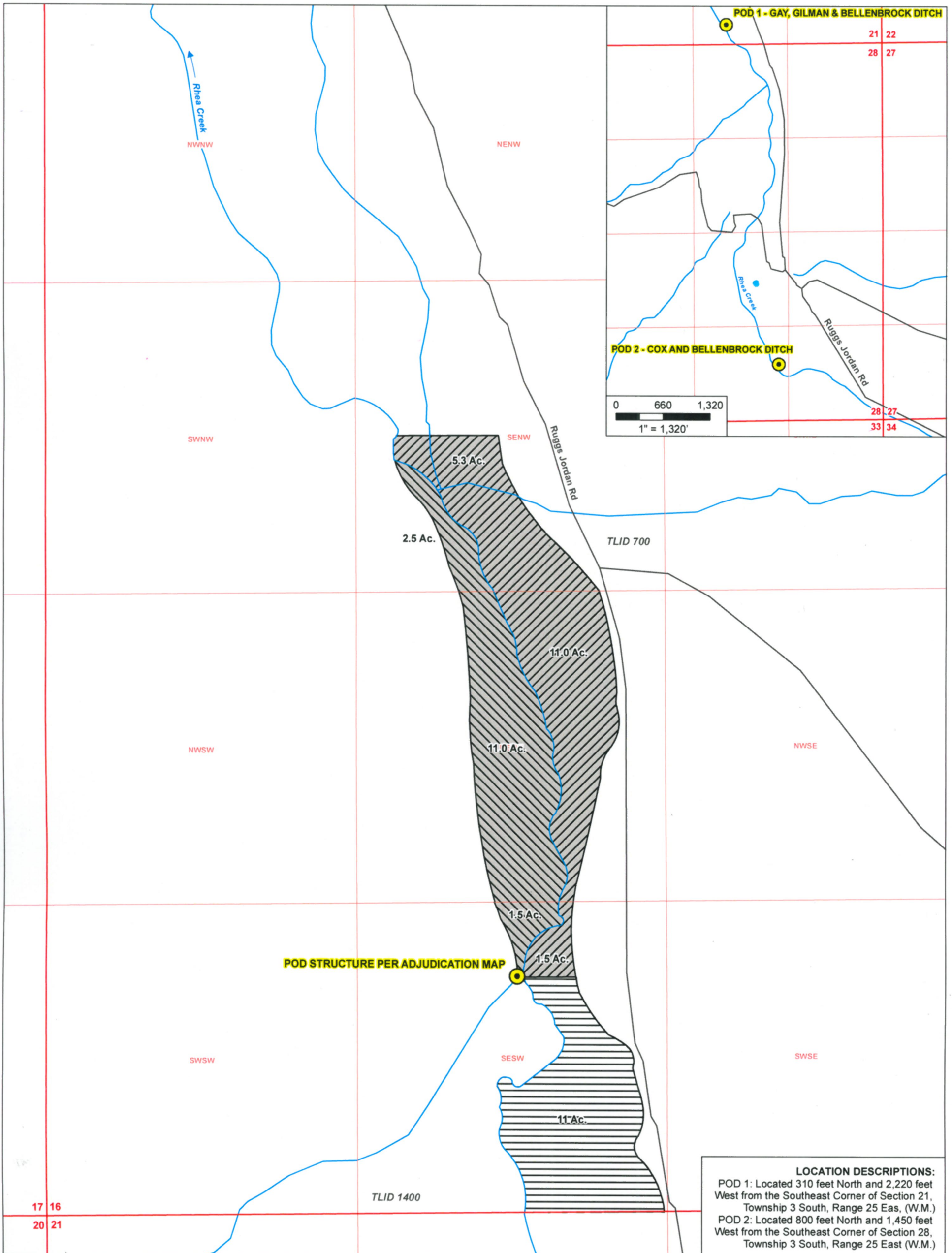

Proposed Point of Diversion and Place of Use Transfer
Certificate 78513, Jerry Nance
 Township 3 South, Range 25 East, Section 16 (W.M.)
 Morrow County
 Amended 04/07/14

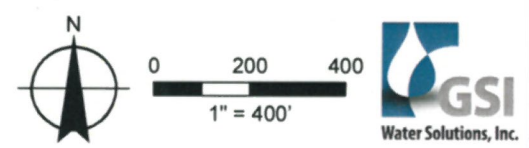

Proposed Place of Use

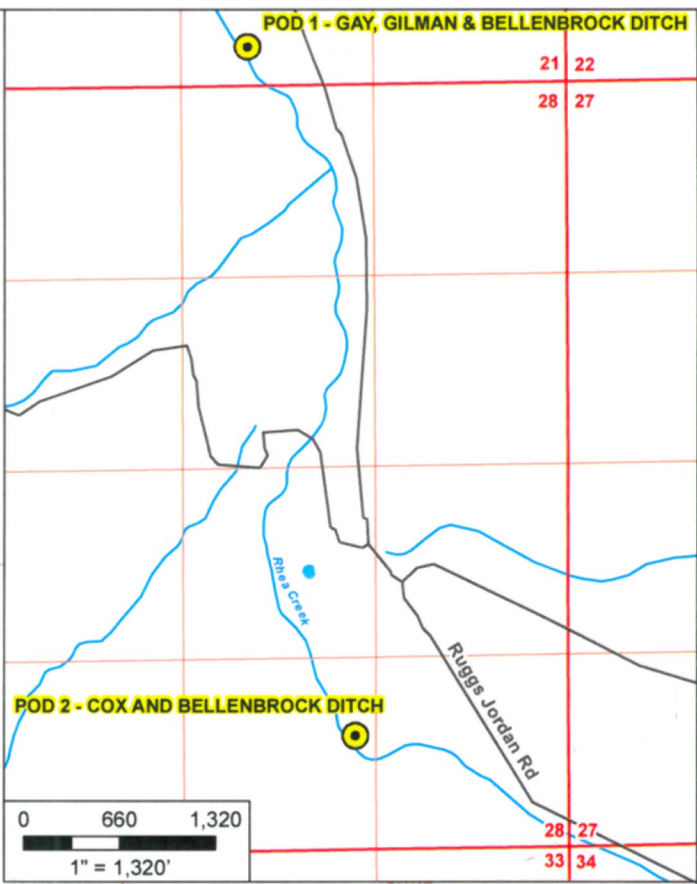
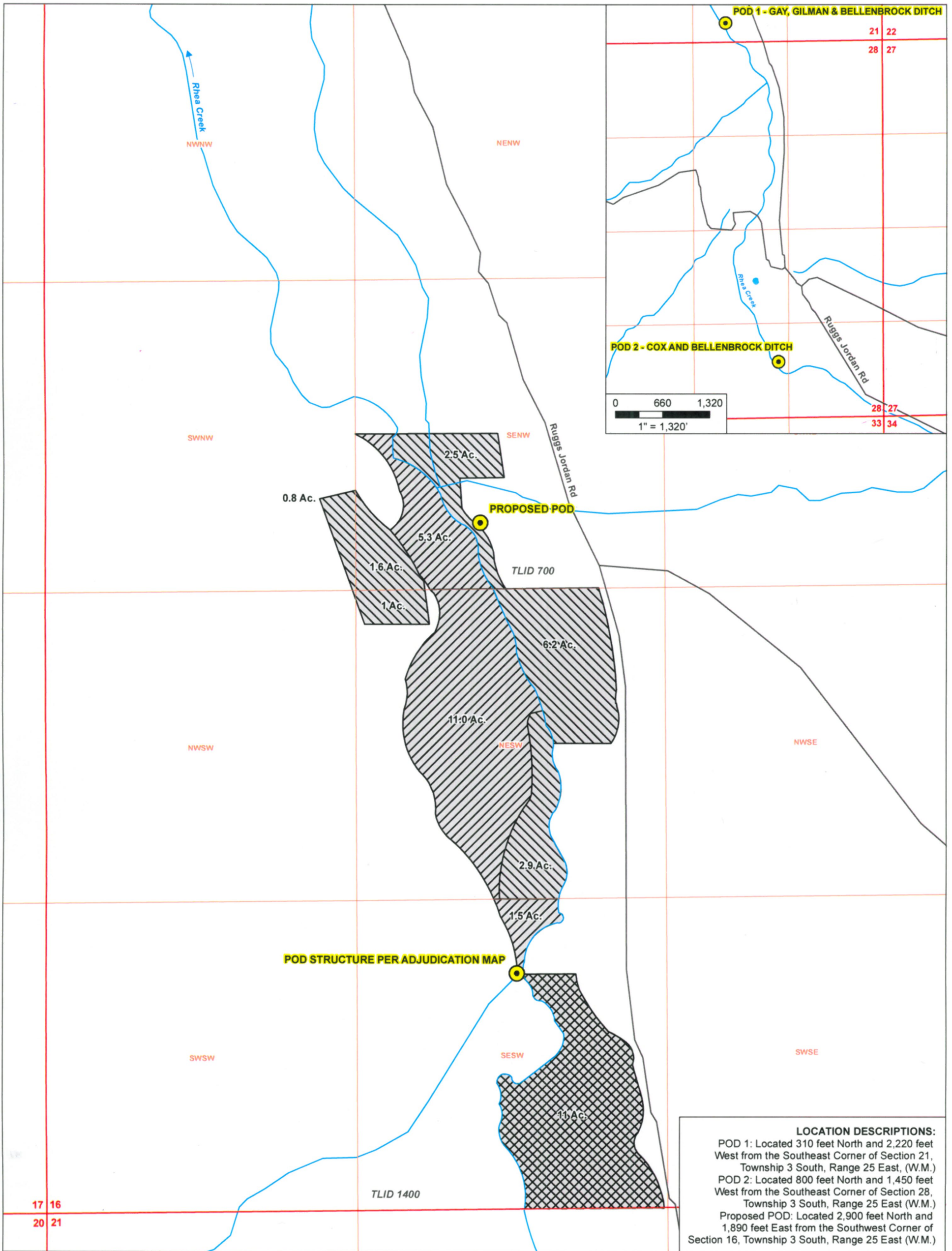

LOCATION DESCRIPTIONS:
 POD 1: Located 310 feet North and 2,220 feet West from the Southeast Corner of Section 21, Township 3 South, Range 25 East, (W.M.)
 POD 2: Located 800 feet North and 1,450 feet West from the Southeast Corner of Section 28, Township 3 South, Range 25 East (W.M.)
 Proposed POD: Located 2,900 feet North and 1,890 feet East from the Southwest Corner of Section 16, Township 3 South, Range 25 East (W.M.)

- LEGEND**
- Point of Diversion (POD)
 - Place of Use (POU)**
 - Priority 1874
 - Priority 1879
 - Remaining Right not Involved in Cert. 78513 Transfer, Priority 1874
 - All Other Features**
 - Road
 - Watercourse



Proposed Point of Diversion and Place of Use Transfer
Certificate 78513, Jerry Nance
 Township 3 South, Range 25 East, Section 16 (W.M.)
 Morrow County
 Amended 04/07/14

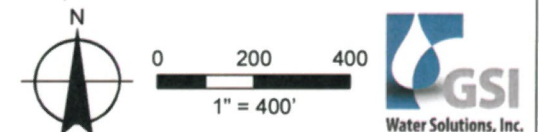

Disclaimer
 This map was prepared for the purpose of identifying the location of a water right only and it is not intended to provide legal dimensions or location of property ownership lines.

Map Notes
 Date: April 9, 2014
 Data Sources: BLM, OWRD, ORMAP