

**RECEIVED**

AUG 15 1999

WATER RESOURCES DEPT.  
SALEM, OREGON

# T. 12 S. R. 2 W. W.M.

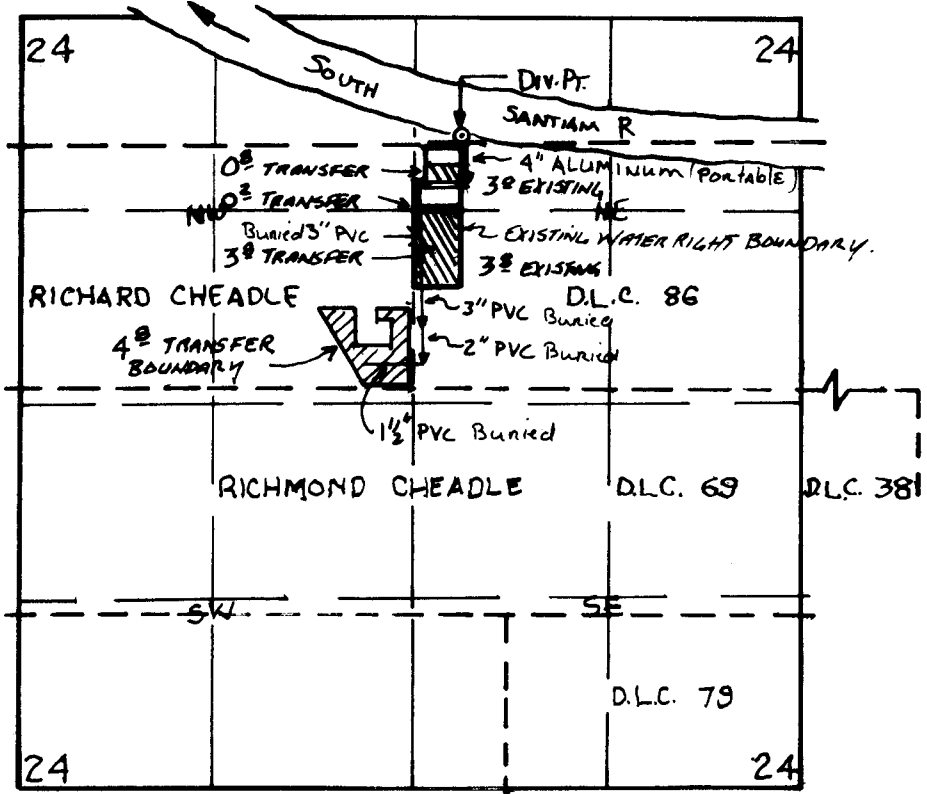

DIV. PT. LOC. 1,770' N & 4,800' W. FROM NE COR. RICHMOND CHEADLE D.L.C. 38



SCALE: 1"=1,320'

## FINAL PROOF MAP



EXISTING PERMIT No. 31835

WALTER W. & JO ANN POPE  
 31798 CHESTNUT LN.  
 LEBANON, OR 97355