

Claim of Beneficial Use Points of Appropriation Transfer T-11342 (Cancelled Certificate 86245) Township 15 South, Range 13 East (W.M.)

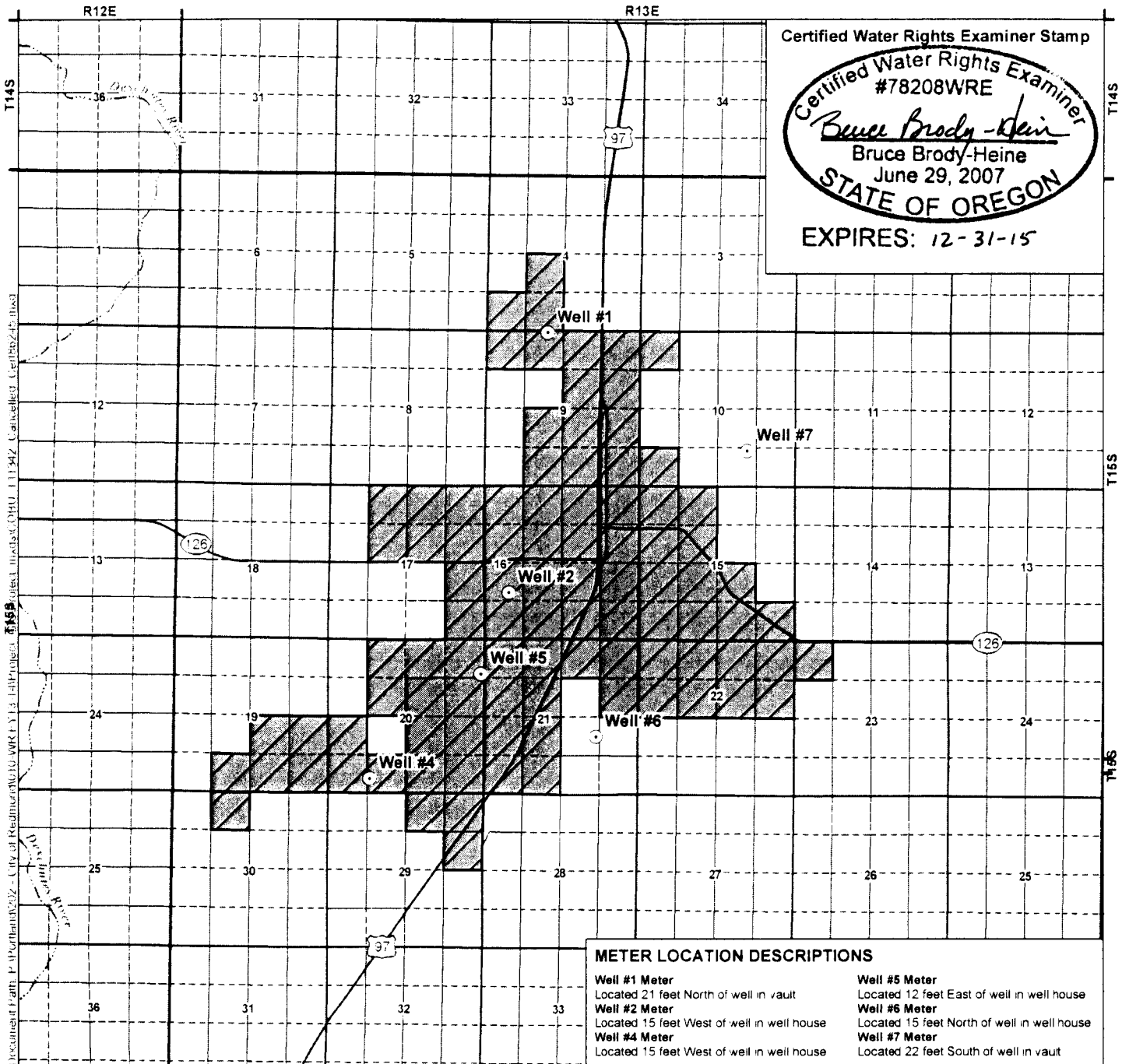

Certified Water Rights Examiner Stamp

Certified Water Rights Examiner
#78208WRE
Bruce Brody-Heine
Bruce Brody-Heine
June 29, 2007
STATE OF OREGON
EXPIRES: 12-31-15

METER LOCATION DESCRIPTIONS	
Well #1 Meter Located 21 feet North of well in vault	Well #5 Meter Located 12 feet East of well in well house
Well #2 Meter Located 15 feet West of well in well house	Well #6 Meter Located 15 feet North of well in well house
Well #4 Meter Located 15 feet West of well in well house	Well #7 Meter Located 22 feet South of well in vault

LEGEND

- Point of Appropriation (POA)
- Place of Use (POU)

POA LOCATION DESCRIPTIONS

Well #1
NE 1/4 NW 1/4 Section 9 Township 15 South Range 13 East (W.M.); South 83° 30' West 546 feet from the North 1/4 Corner of Section 9

Well #2
NW 1/4 SW 1/4 Section 16 Township 15 South Range 13 East (W.M.); North 27° 24' East 1 800 feet from the SW Corner of Section 16

Well #4
SE 1/4 SW 1/4 Section 20 Township 15 South Range 13 East (W.M.); North 82° 41' West 3 945 feet from the SE Corner of Section 20

Well #5
NE 1/4 NE 1/4 Section 20 Township 15 South Range 13 East (W.M.); South 5° 48' West 1 200 feet from the NE Corner of Section 20

Well #6
NW 1/4 SE 1/4 Section 21 Township 15 South Range 13 East (W.M.); North 35° 38' 4" West 2 443 94 feet from the SE Corner of Section 21

Well #7
SW 1/4 SE 1/4 Section 10 Township 15 South Range 13 East (W.M.); 1 210 feet North and 1 640 feet West from the SE Corner of Section 10

Disclaimer
This map was prepared for the purpose of identifying the location of a water right only and it is not intended to provide legal dimensions or location of property ownership lines

Map Notes
Date February 17 2014
Data Sources OWRD OGIC ESRI
Prepared By GSI Water Solutions Inc

