

# T20 S, R 34 E, WM

**RECEIVED**

SEP 08 1999

WATER RESOURCES DIVISION  
SALEM, OREGON

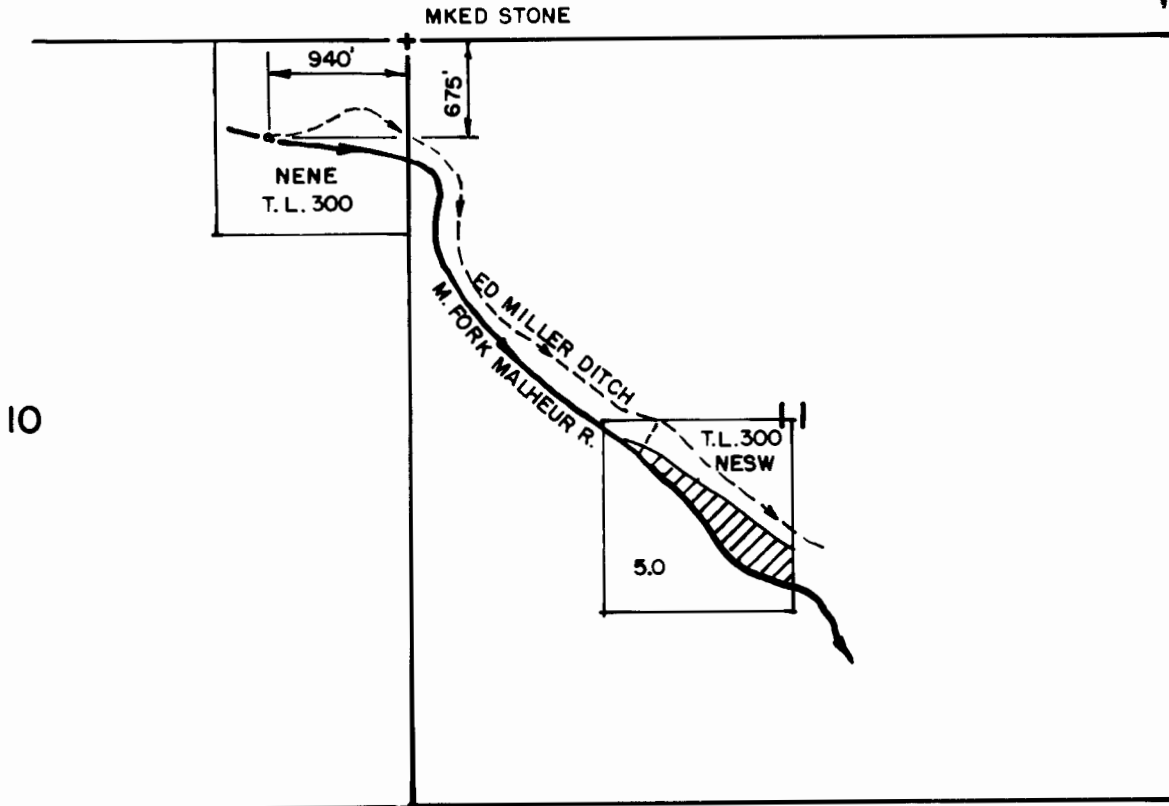

10

THE PURPOSE OF THIS MAP IS TO IDENTIFY THE LOCATION OF THE WATER RIGHT. IT IS NOT INTENDED TO PROVIDE INFORMATION RELATIVE TO THE LOCATION OF PROPERTY OWNERSHIP.

	<b>FINAL PROOF SURVEY</b>		IN THE NAME OF HARVEY J. CRONIN
	UNDER T- 6991		
	Scale: 4" = 1 MILE	Date: AUG. 1999	Job: 1451
	Dsn:		Sht. No.
Dwn: CHRIS	M.A. PALMER & SONS, INC. ENGINEERING & SURVEYING 711 Ponderosa Village • Box 61 Burns, Oregon 97720		of 1
Ckd:			