

T.9S., R.26E.

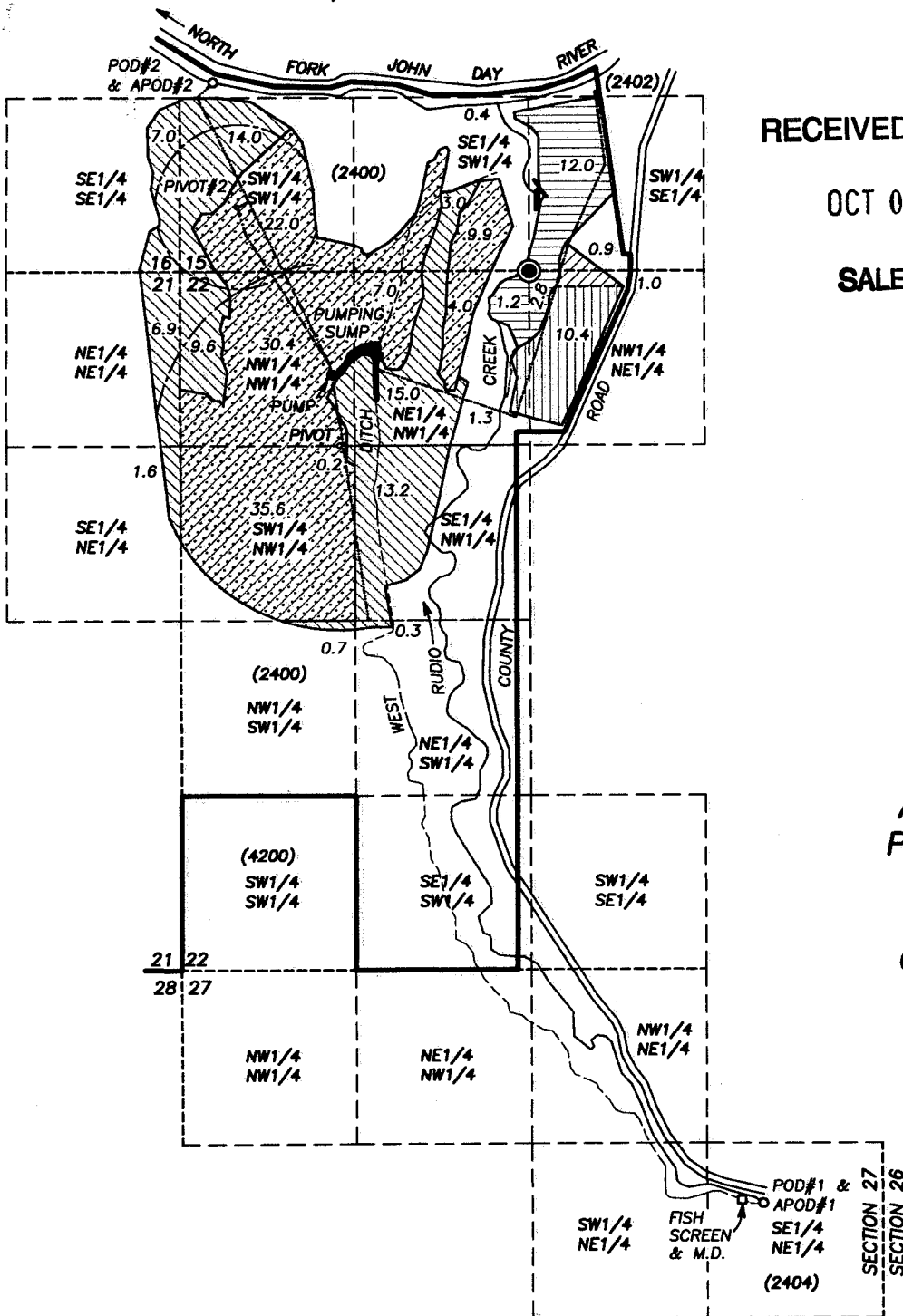

RECEIVED BY OWRD

OCT 01 2012

SALEM, OR

SCALE: 1" = 1320'

FINAL PROOF SURVEY
 UNDER
 APPLICATION NO. T-10904
 PERMIT NO. SPECIAL ORDER
 VOLUME 80, PAGE 322
 IN NAME OF
 CAMPBELL CROSSING, INC.

- AUTHORIZED POD#1 & ADDITIONAL POD #1
 7120 FT. SOUTH AND 4200 FT. EAST OF NW COR. SEC. 22
 FISH SCREEN AND MEASURING DEVICE 160 FT. FROM POD
- AUTHORIZED POD#2 & ADDITIONAL POD #2
 1440' NORTH AND 2370' WEST OF S1/4 COR. SEC 15
 FISH SCREEN, PUMP & FLOW METER

↑ MONITORING DEVICE ON WEST BANK RUDIO CREEK

----- MAIN LINE

----- DITCH

(2400) TAX LOT NO.

● FOUND 5/8" IRON PIN MON. AT S1/4 COR. SEC 15

▨ FIRST RIGHT

▨ SECOND RIGHT - PRIMARY ▨ ~~SECOND~~ ^{THIRD} RIGHT - SUPPLEMENTAL

▨ THIRD RIGHT

PREPARED BY
 ROBERT D. BAGETT
 217 N. CANYON BLVD.
 JOHN DAY, OREGON
 (541) 575-1251

MAY 18, 2011

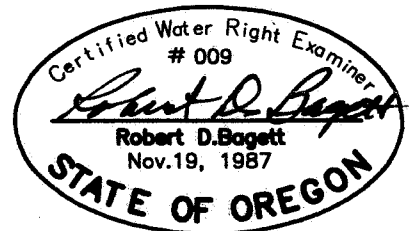

NOTE: THE PREPARATION OF THIS MAP WAS FOR THE PURPOSE OF IDENTIFYING THE LOCATION OF THE PROPOSED WATER RIGHT AND HAS NO INTENT TO PROVIDE DIMENSIONS OR LOCATION OF PROPERTY OWNERSHIP LINES.