

NOTE:
ALL FLOW METERS ARE
LOCATED AT WELL HEADS

CLAIM OF BENEFICIAL USE MAP
IN THE NAME OF:
TREASURE VALLEY COMMUNITY COLLEGE
T 18 S R 47 E SECTION 9 WM
LOCATION OF WELLS
TRANSFER NO. T-9383
CERTIFICATE NO. 22842
PERMIT NO. U-226

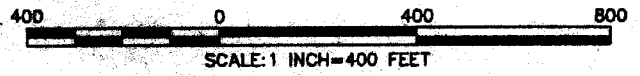
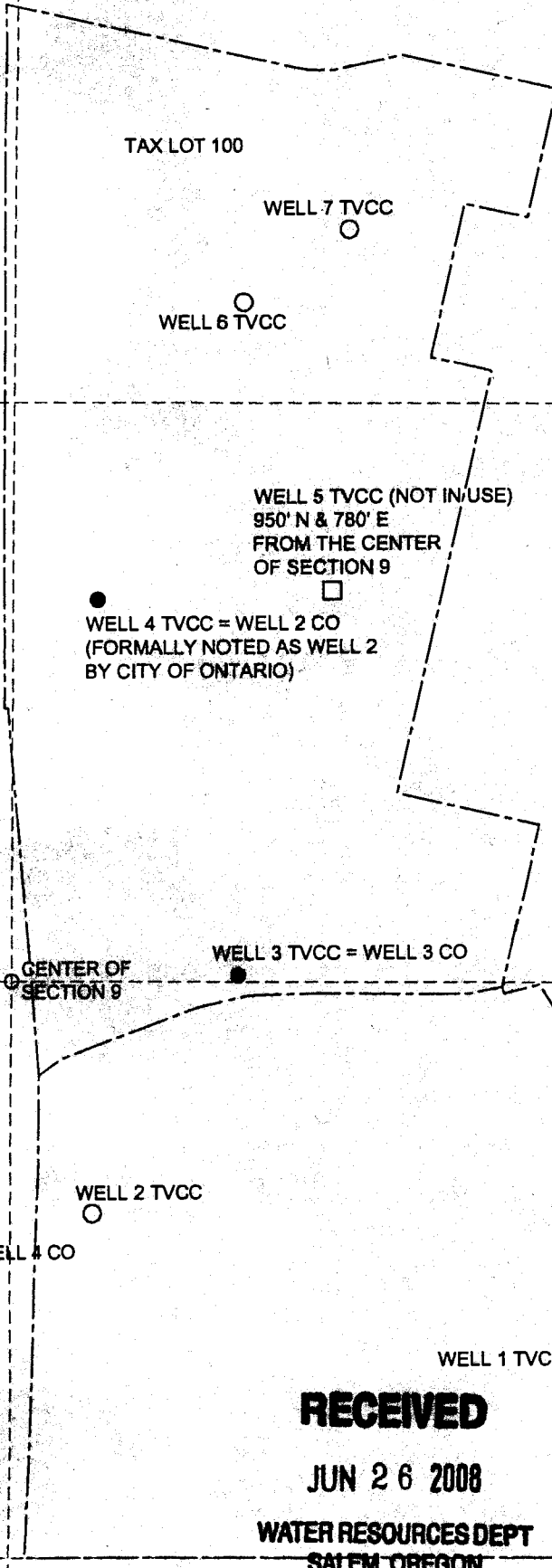

THIS IS FOR THE PURPOSE OF IDENTIFYING THE
LOCATION OF WATER RIGHTS ONLY AND IS NOT
INTENDED TO PROVIDE LEGAL DIMENSIONS OR
LOCATION OF PROPERTY LINES.

- AUTHORIZED POINTS OF APPROPRIATION:
- WELL 2 CO = WELL 4 TVCC: 920' N & 250' E
 - WELL 3 CO = WELL 3 TVCC: 30' N & 550' E
FROM THE CENTER OF SECTION 9
 - WELL 4 CO: NOT USED ON TVCC PROPERTY
LOCATED IN NE 1/4 SW 1/4 SECTION 9
IN EVERGREEN CEMETERY

- PROPOSED ADDITIONAL POINTS OF
APPROPRIATION: *8901*
- WELL 1: ~~980'~~ S & 1270' E
 - WELL 2: 510' S & 200' E
 - WELL 6: 1540' N & 560' E
 - WELL 7: 1680' N & 810' E
FROM THE CENTER OF SECTION 9

○ WELL 8 (NOT INCLUDED IN COBU
SEE ATTACHED LETTER)

TAX LOT 500

DATE: PR 071205
DRAWN BY: JEH
CHECKED BY: MEH
DATE: 1/22/07
DATE: 1/24/07

CLAIM OF BENEFICIAL USE MAP
TREASURE VALLEY COMMUNITY COLLEGE

HOUSE OF DOCUMENTS
FOR THE STATE OF OREGON
DIVISION OF LAND AND WATER
RECORDS AND CLERK OF COURTS
1000 NE Oregon Street, Suite 200
Salem, Oregon 97331-3800
PHONE: 503-945-3100
FAX: 503-945-3101
WWW: www.oregon.gov/landwater

HOLLADAY ENGINEERING CO.
ENGINEERS • CONSULTANTS
322 S. Main, P.O. Box 235, Rainier, ID 83461
(208) 336-3300 FAX (208) 842-2159
E-MAIL: holladay@holladayengineering.com

RECEIVED

JUN 26 2008

WATER RESOURCES DEPT
SALEM, OREGON

CLAIM OF BENEFICIAL USE MAP
 IN THE NAME OF:
TREASURE VALLEY COMMUNITY COLLEGE

T18S R47E SECTION 9 WM
IRRIGATED ACREAGE
TRANSFER NO T-9383
CERTIFICATE NO 22842
PERMIT NO U-226

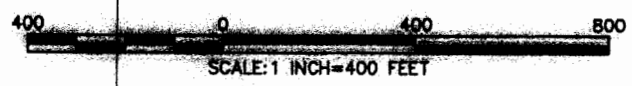
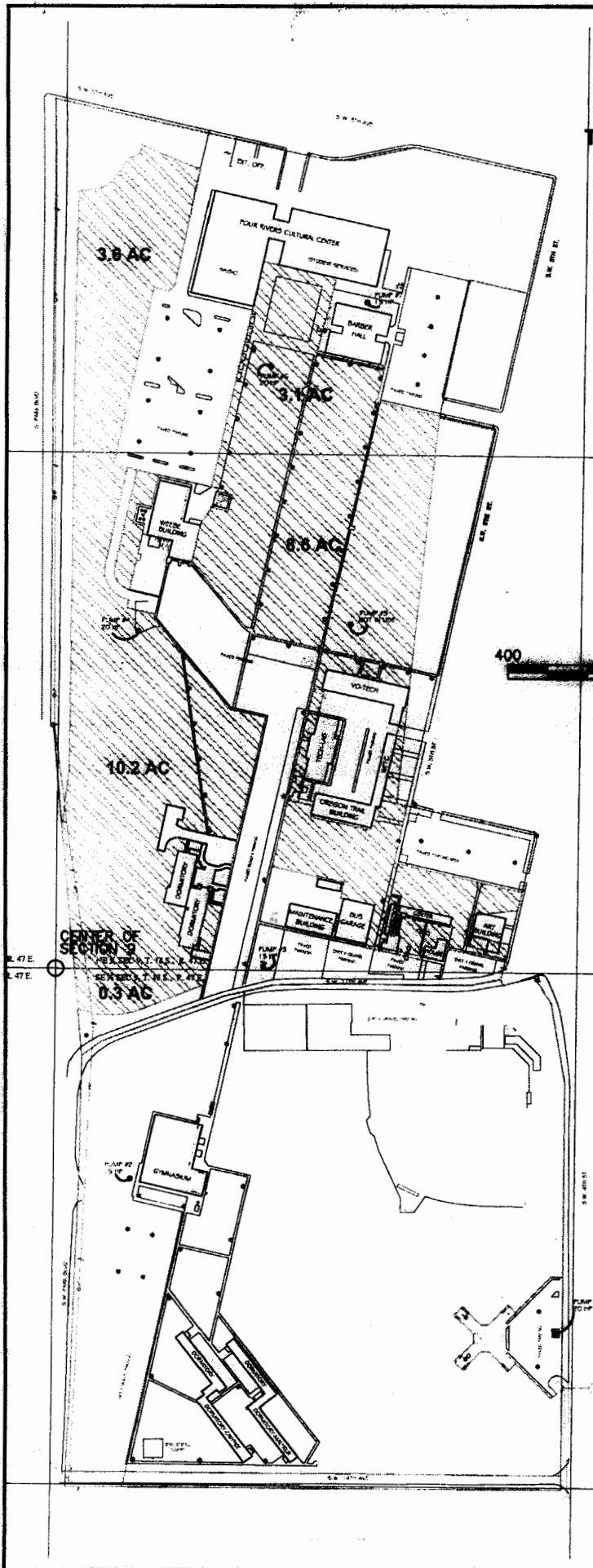

 **IRRIGATED AREAS**

THIS IS FOR THE PURPOSE
 OF IDENTIFYING THE
 LOCATION OF WATER
 RIGHTS ONLY AND IS NOT
 INTENDED TO PROVIDE
 LEGAL DIMENSIONS OR
 LOCATION OF PROPERTY
 LINES.

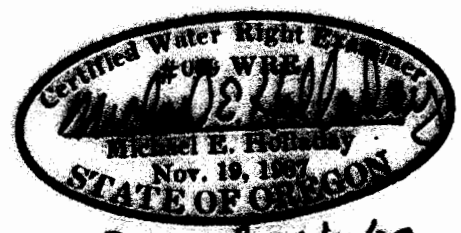

Renewal 06/30/09

REVISED 02/2008

RECEIVED

JUN 26 2008

WATER RESOURCES DEPT
SALEM, OREGON

G:\PR\071205\dwg\071205_REVISED