

RECEIVED

AUG 29 2005

WATER RESOURCES DEPT
SALEM, OREGON

TRANSFER T-8732



LOCATED IN
SECTIONS 25, 35 & 36, T. 13 S., R. 17 E., W.M.
CROOK COUNTY, OREGON

P.O.D.'S "C" AND "D"

P.O.D. "C" IS A PROPOSED LOCATION INTENDED FOR A PUMP STATION FOR THE LANDS SHOWN HEREON AND WILL BE ONLY USED WITH APPROVED O.D.F.W. FISH SCREENS.

P.O.D. "D" IS AN HISTORICALLY USED P.O.D. AS A RESULT OF CHANGES IN CREEK MORPHOLOGY, (PREVIOUSLY P.O.D. "I") P.O.D. "D" IS NO LONGER REQUIRED.

WATER RIGHTS TO BE TRANSFERRED ON

-  CERTIFICATE NO. 635, PRIORITY DATE: 1897
-  CERTIFICATE NO. 1173, PRIORITY DATE: 1914
-  CERTIFICATE NO. 23717, PRIORITY DATE: 1955

I, ROBERT E. BAXTER, CERTIFIED WATER RIGHT EXAMINER IN THE STATE OF OREGON, HEREBY CERTIFY THAT THIS WATER RIGHT SURVEY MAP WAS PREPARED BY ME.

THE PREPARATION OF THIS MAP IS FOR THE PURPOSE OF IDENTIFYING THE LOCATION OF THE WATER RIGHT ONLY AND HAS NO INTENT TO PROVIDE DIMENSIONS OR LOCATIONS OF PROPERTY OWNERSHIP LINES.

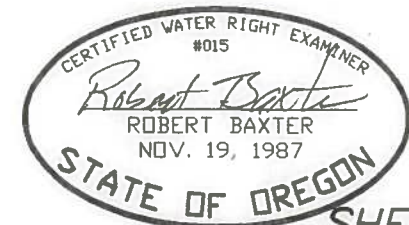

SHEET 2 OF 10

PREPARED BY
BAXTER LAND SURVEYING, INC.
20370 EMPIRE AVE. SUITE C3
BEND, ORE. 97701 (541) 382-1962

MILL CREEK CLAIM OF BENEFICIAL USE
WATER RIGHT MAP FOR
MARK AND GEORGETTE COPELAND

PREPARED FOR: MARK & GEORGETTE COPELAND
7900 NE MILL CREEK RD.
PRINEVILLE, OR 97754
SCALE: 1" = 1320'
DATE: 6/15/2005

0 660 1,320 2,640 3,960 5,280 Feet

T 14 S, R 17 E, WM

CROOK COUNTY, OREGON

1" = 1320'

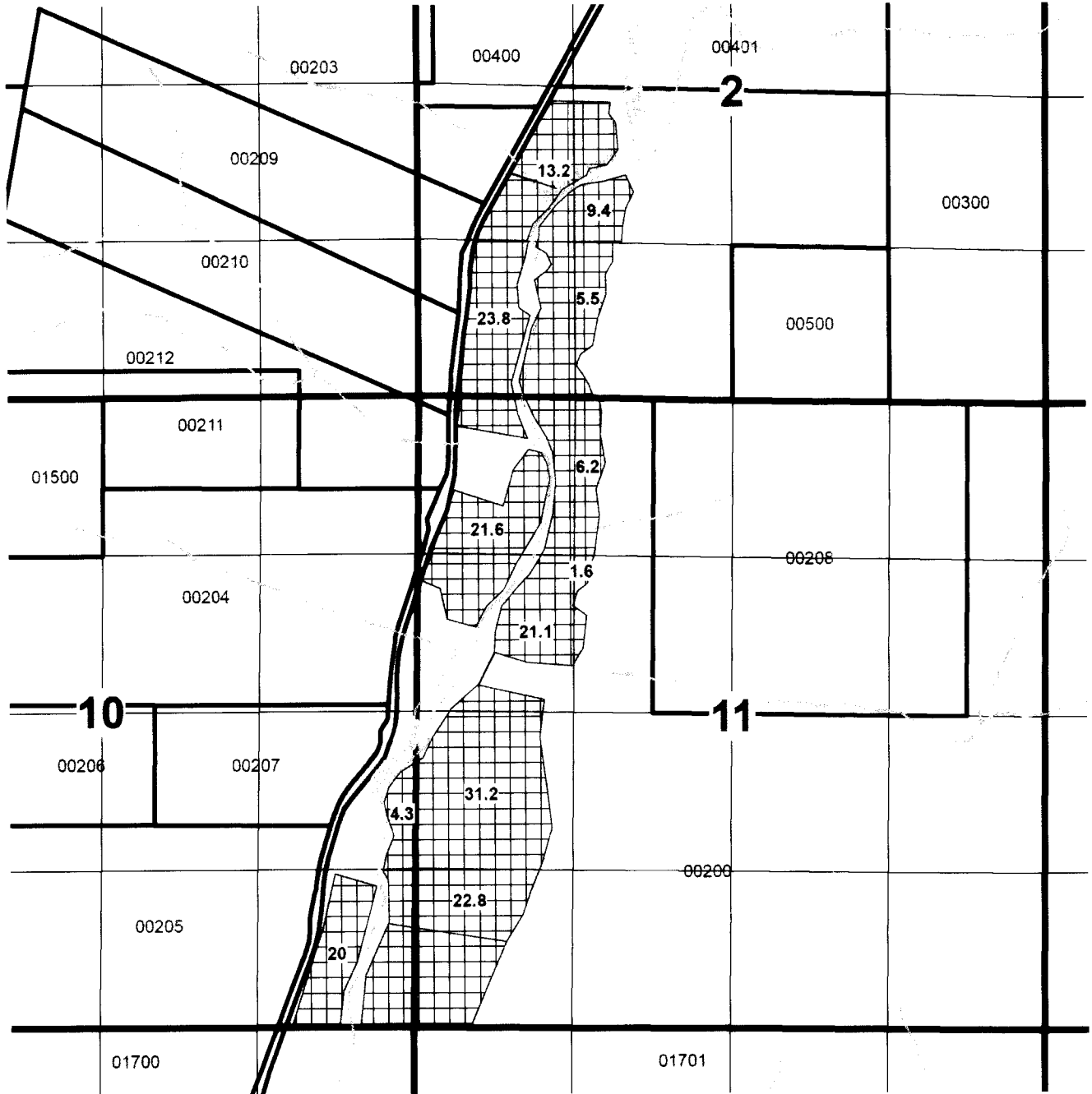

RECEIVED BY OWRD

JUN 30 2014

SALEM, OR

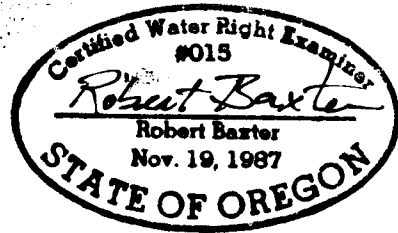

-  SECTIONS
-  TAX LOT LINES
-  SUPPLEMENTAL IRRIGATION BY QQ FROM CERT 23717

RENEWAL DATE: 12-31-2015



**CLAIM OF BENEFICIAL USE MAP
FOR MAHOGANY BUTTE RANCH
SUPPLEMENTAL IRRIGATION**

TRANSFER T - 8732 JUNE 26, 2014

This map is not intended
to provide legal dimensions
or locations of property
ownership lines.

JOB # 2012021

WATER RIGHT SERVICES, LLC

PO BOX 1830, BEND, OR 97709

WWW.OREGONWATER.US 541-389-2837

CCB # 197121 johnshort@usa.com