

FINAL PROOF SURVEY  
PERMIT ~~G-13875~~ G-13785

T6N, R35E, Section 15  
NW1/4 OF SW1/4 OF SE1/4 and  
W1/2 OF NE1/4 OF SW1/4 OF SE 1/4.

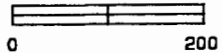

Scale: 1"=200'

5/32" Nozzles on 14' x 3/4" galvanized iron risers. Spaced in diamond pattern. 60' north-south and 54' east west.

9.5 acres - Certificate 1762

4.8 acres - Certificate 1782

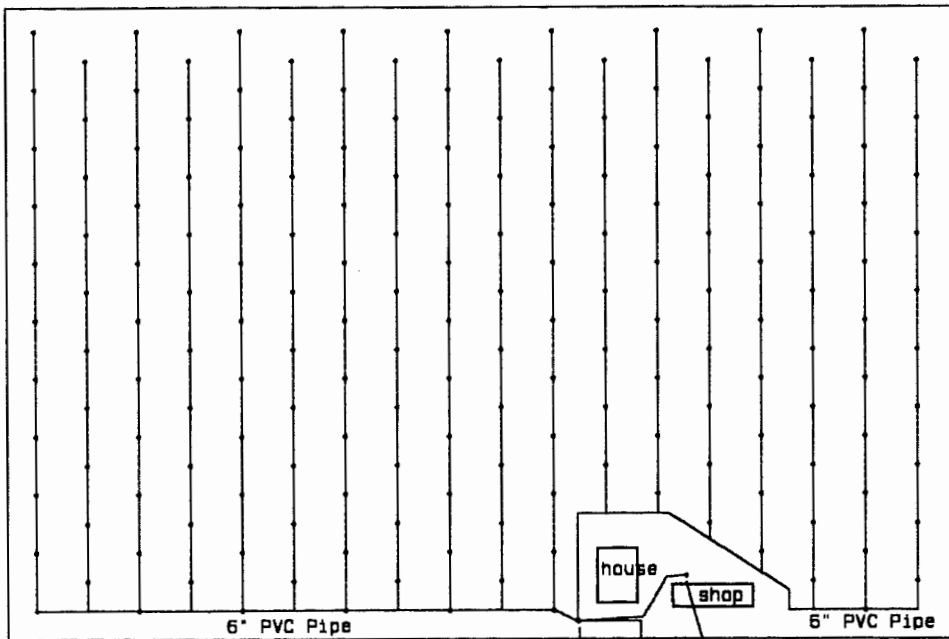

6" PVC main supplies 2" to 1 1/2" laterals with valve at main line.

7.5 HP centrifugal Berkely alternate pump

Open Ditch

PERMIT G-13875  
Well - 7.5 HP Berkely submersible set at 87 feet yields 125 gpm. Well 702' North and 668' East of south 1/4 corner of Section 15.

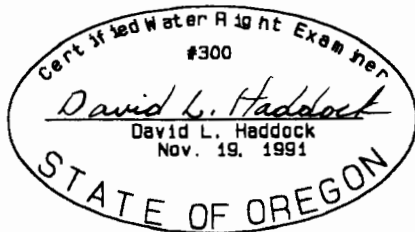

(renews 6-30-01)

NOTE:  
The information shown on this map is solely for Water Rights purposes. The data shown does not represent ownership information.

Survey By:  
CWRE 300  
David Haddock  
P. O. Box 1574  
Pendleton, OR 97801  
(541) 276-2174

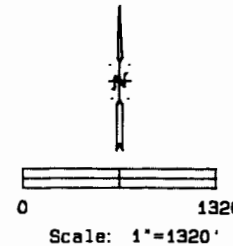

SE 1/4

SEC. 15

County Road 518

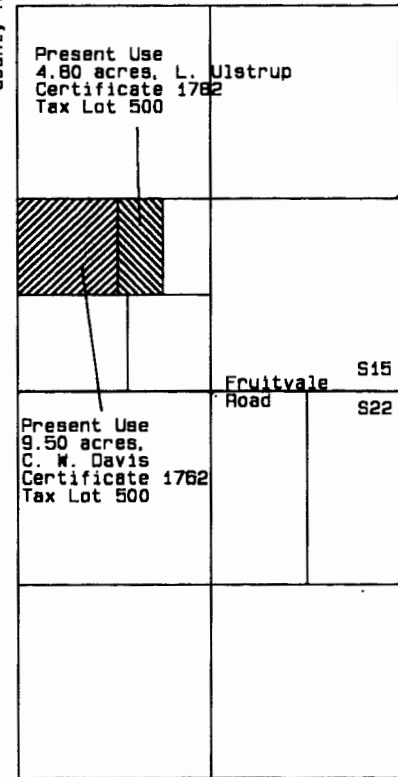

Winesap Road

Fruitvale Road S15 S22

S14 BC S23

NE 1/4

SEC. 22

RECEIVED

OCT 13 2000

WATER RESOURCES DEPT.  
SALEM, OREGON

SURVEY DATE: March 2000

SURVEY FOR  
Mr. James Walliser  
84049 Winesap Road  
Milton-Freewater,  
OR 97862  
(541) 938-3149

David L. Haddock, Surveyor and Engineer  
P.O. Box 1574  
Pendleton, Oregon, 97801  
(541) 276-2174

HADDOCK SURVEYING

GPS  
AND  
TOTAL STATION

Corrected Permit Number MSR/wrn