

T.6S. R.1W., W.M

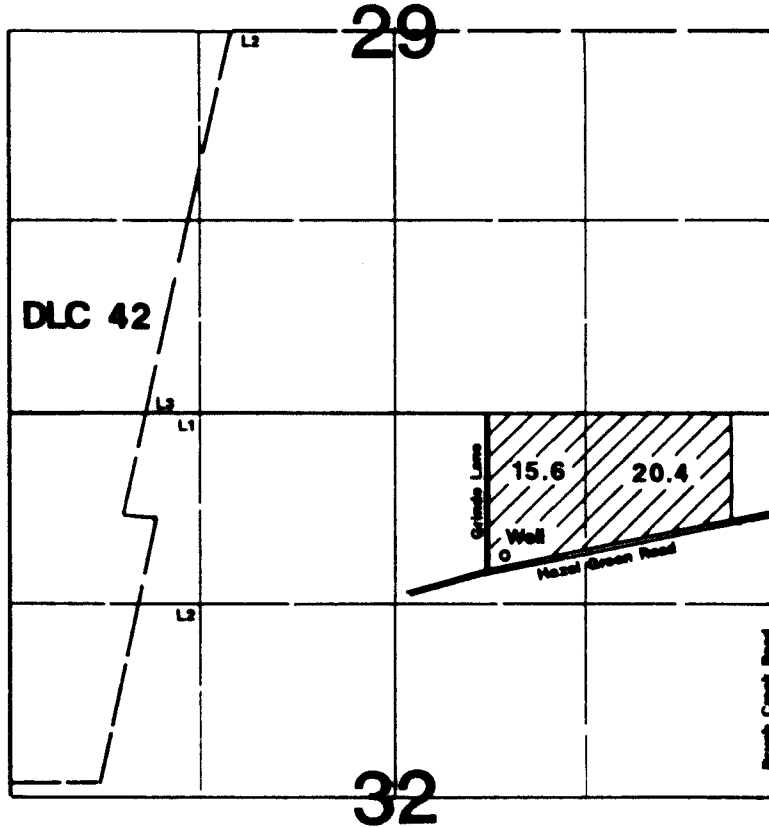

Well is located 1035'S & 1870'W from the NE corner of Section 32.

RECEIVED

DEC 02 1999

**WATER RESOURCES DEPT.
SALEM, OREGON**

Final Proof Survey

Application #: G-14212 Permit #: G-12958

In Name Of

Stanley & Jeanette Olafson

Surveyed on November 27, 1999 by JM Schuette

This Map Was Prepared For The Purpose Of Identifying The Location Of A Water Right Only And Is Not Intended To Provide Legal Dimensions Or Location Of Property Ownership Lines.

