

# Township 8 South, Range 2 West, W. RECEIVED

Portions of Sections 3 and 10

NOV 19 1992

WATER RESOURCES DEPT  
SALEM, OREGON

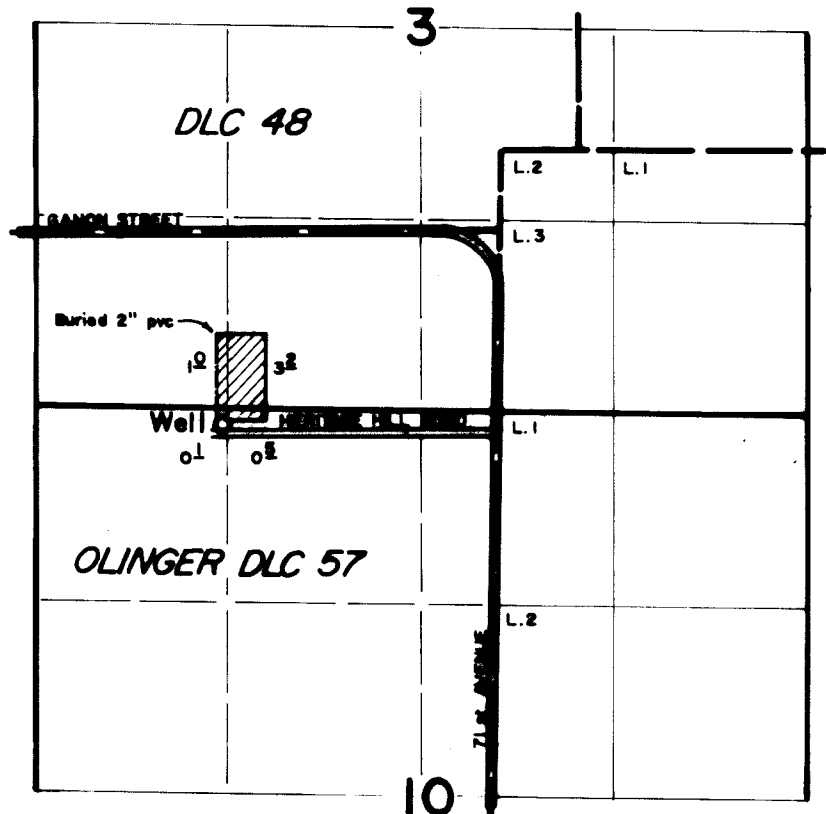

1" = 1320'

Well located 1360' S. and 1880' W. from the NE cor. DLC 57

FINAL PROOF SURVEY  
under

Appl. No. G-12501, Per. No. G-11568

in name of

**MARK KRAUTMAN**

October 7, 1992

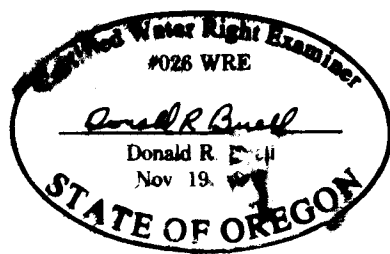

THIS MAP WAS PREPARED FOR THE PURPOSE OF IDENTIFYING THE LOCATION OF A WATER RIGHT ONLY AND IS NOT INTENDED TO PROVIDE LEGAL DIMENSIONS OR LOCATION OF PROPERTY OWNERSHIP LINES.