

RECEIVED
 OCT 14 1993
 WATER RESOURCES DEPT.
 SALEM, OREGON

**MAP FOR
 FINAL PROOF SURVEY**
 Located in the NE 1/4 SW1/4, Sec. 7, T. 39 S., R. 9 E., W. M.
 Klamath Falls, OR.

Applicant: City of Klamath Falls (Water Div.)
 Examiner: Thomas J. DelSanto
 Drawn By: Thomas J. DelSanto
 Checked By: Dale A. Cross
 Date: 2/7/90
 Revised: 10/5/93 For Beneficial Use - Final Proof Survey
 Revisions By: Joanne Bishop
 Checked By: Thomas J. DelSanto

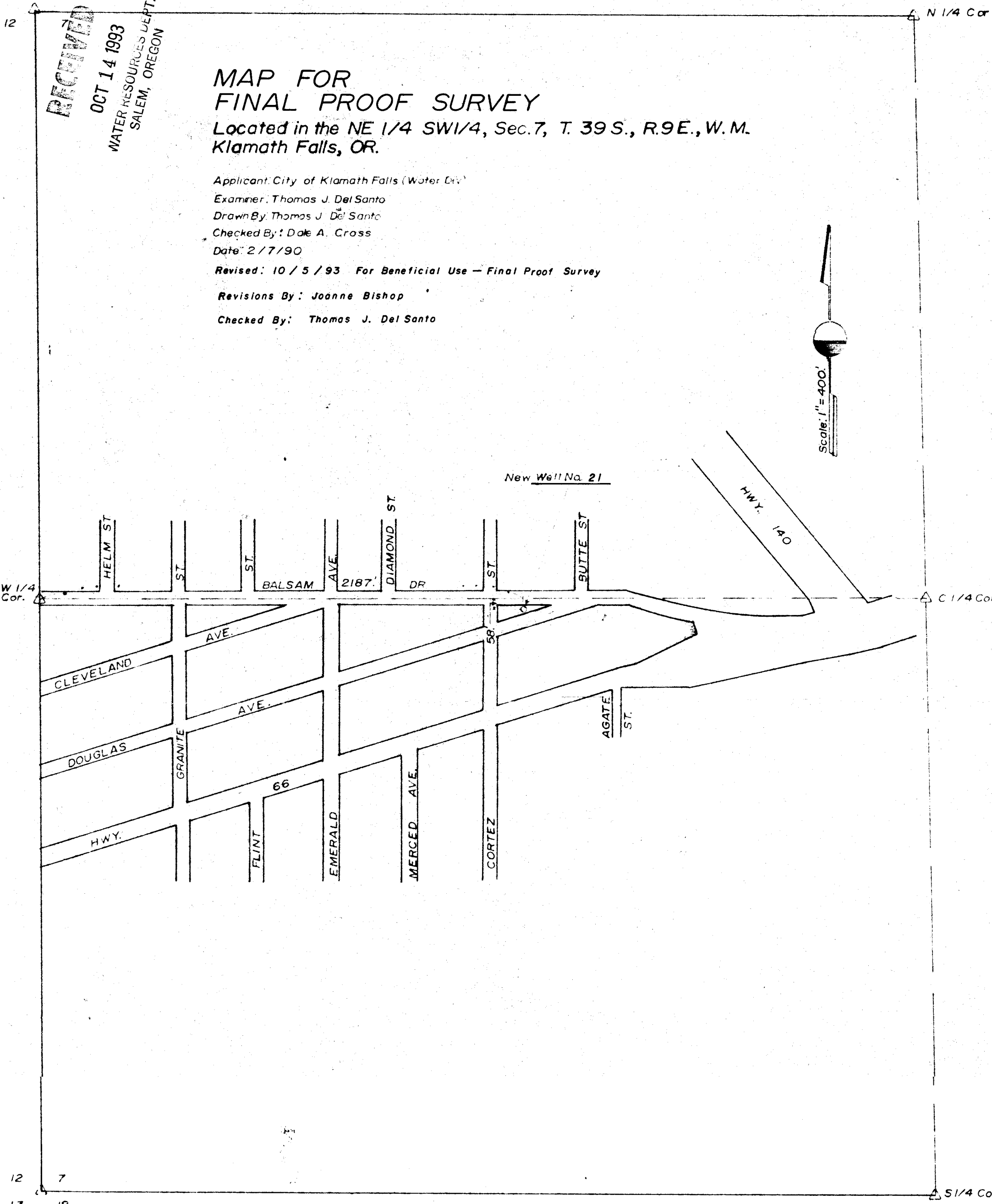

Reference Map: Klamath County Assessors Map 39 09 07

The preparation of this map was for the purpose of identifying the location of the Water Right only and has no intent to provide dimensions or location of property ownership lines.

USAGE AREA
 GROUND WATER FOR MUNICIPAL USE
 Under Permit No. G-11090 and T-6366

T. 39 S.
 T. 39 S.

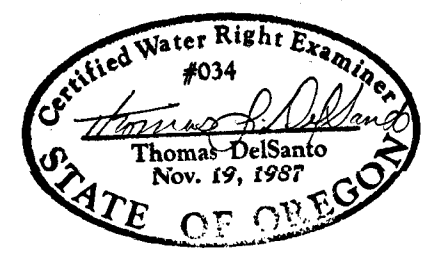
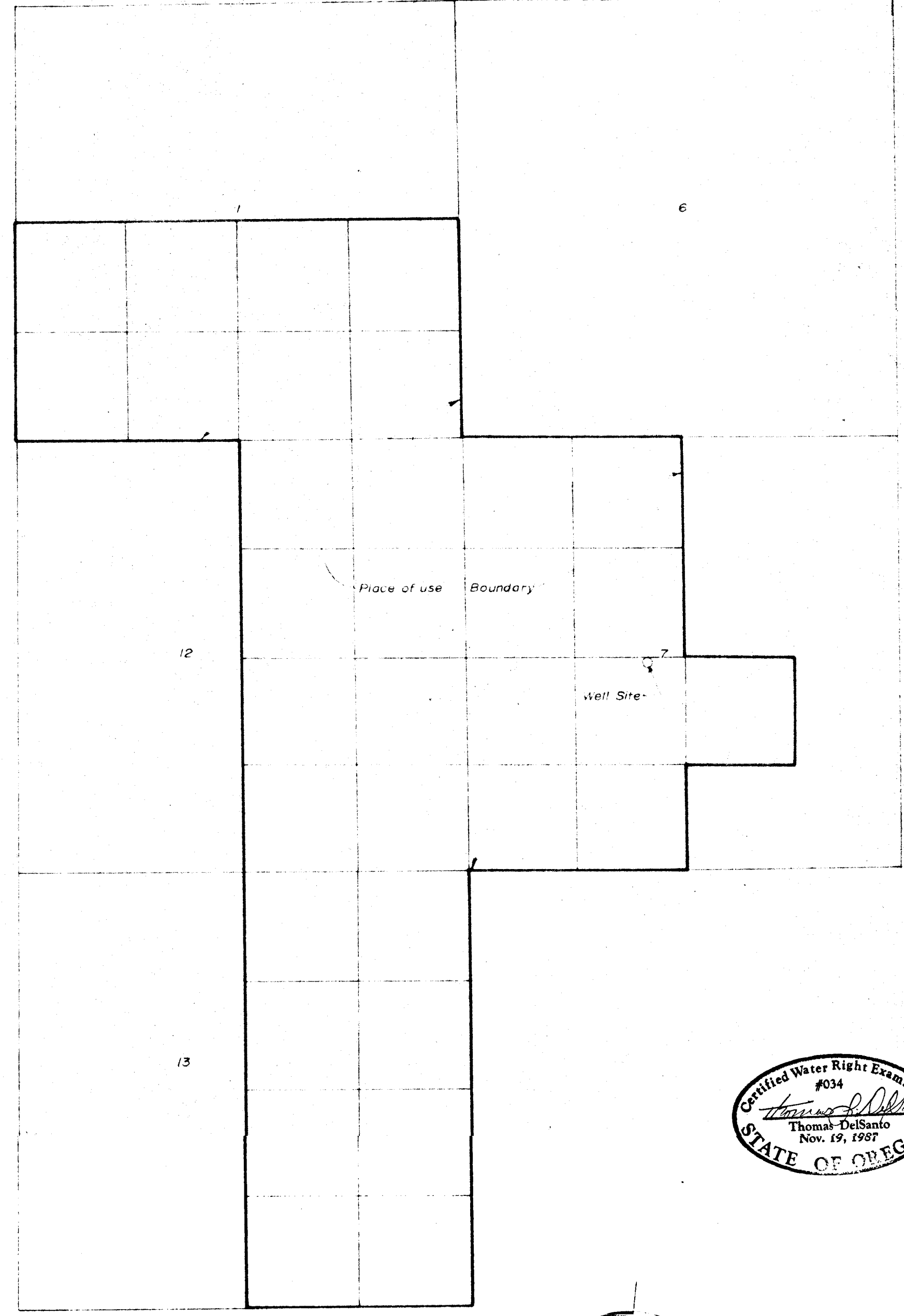

Reference Map: Klamath Falls and Vicinity, prepared by O.D.O.T., revised Jan. 1981

The Place of use Boundary represents the area that will be covered by:
 1) Permit No. G-11090 and T-6366

CITY OF KLAMATH FALLS
 ENGINEERING DIVISION

226 So. 5th Street
 Klamath Falls, OR. 97601
 Ph. No. (503) 883-5370