

T.34S.,R.1W.,W.M.

CTR. 1/4 CORNER  
SECTION 21  
FD. 1 1/4" I. PIPE

NW1/4 SE1/4  
(GOV'T LOT 6)

NE1/4 SE1/4

*Modified by owner  
10-22-14 GJK*

RIVER PUMPING STATION  
SOUTH, 1315 AND WEST, EAST  
1350' FROM CTR. 1/4 COR.

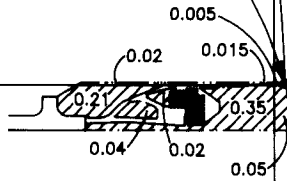

ROGUE RIVER

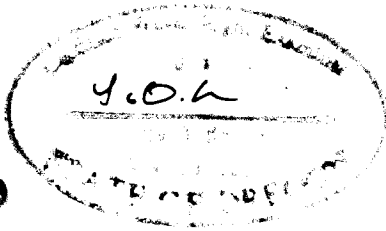

**RECEIVED**

SEP 15 2000

WATER RESOURCES DEPT.  
SALEM OREGON

SW1/4 SE1/4  
(GOV'T LOT 5)

SE1/4 SE1/4

SECTION COR.

21 22  
28 27

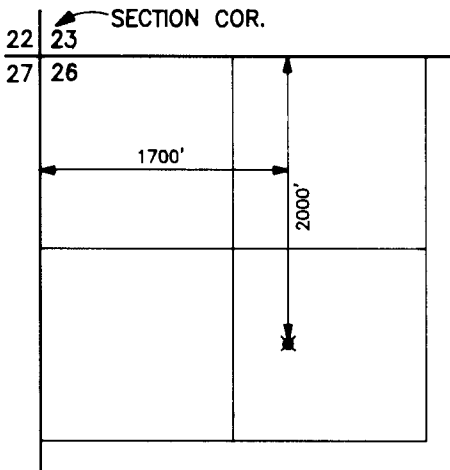

LOST CREEK RESERVIOR  
POINT OF DIVERSION  
T.33S.,R.1E.,W.M.  
SCALE 1" = 1320'

FINAL PROOF MAP

APPLICATION No. S-73353  
PERMIT No. 51881

IN THE NAME OF  
JOE & JEAN GIULIE



SCALE 1" = 400'

MAP PREPARED AUGUST 23, 2000  
BY GARY D. KAISER

NOTE: MAP PREPARED FOR  
WATER RIGHT PURPOSES ONLY,  
NOT FOR PROPERTY BOUNDARY  
LOCATIONS.