

**FINAL PROOF MAP FOR WEYERHAEUSER COMPANY  
FOR INDUSTRIAL USE UNDER T-7526**

LOCATED IN  
SECTIONS 21, 28, 29, 32 & 33  
T.10S., R.3W., W.M.  
LINN COUNTY, OREGON  
SCALE: 1"=1320'-0"  
CITY OF MILLERSBURG

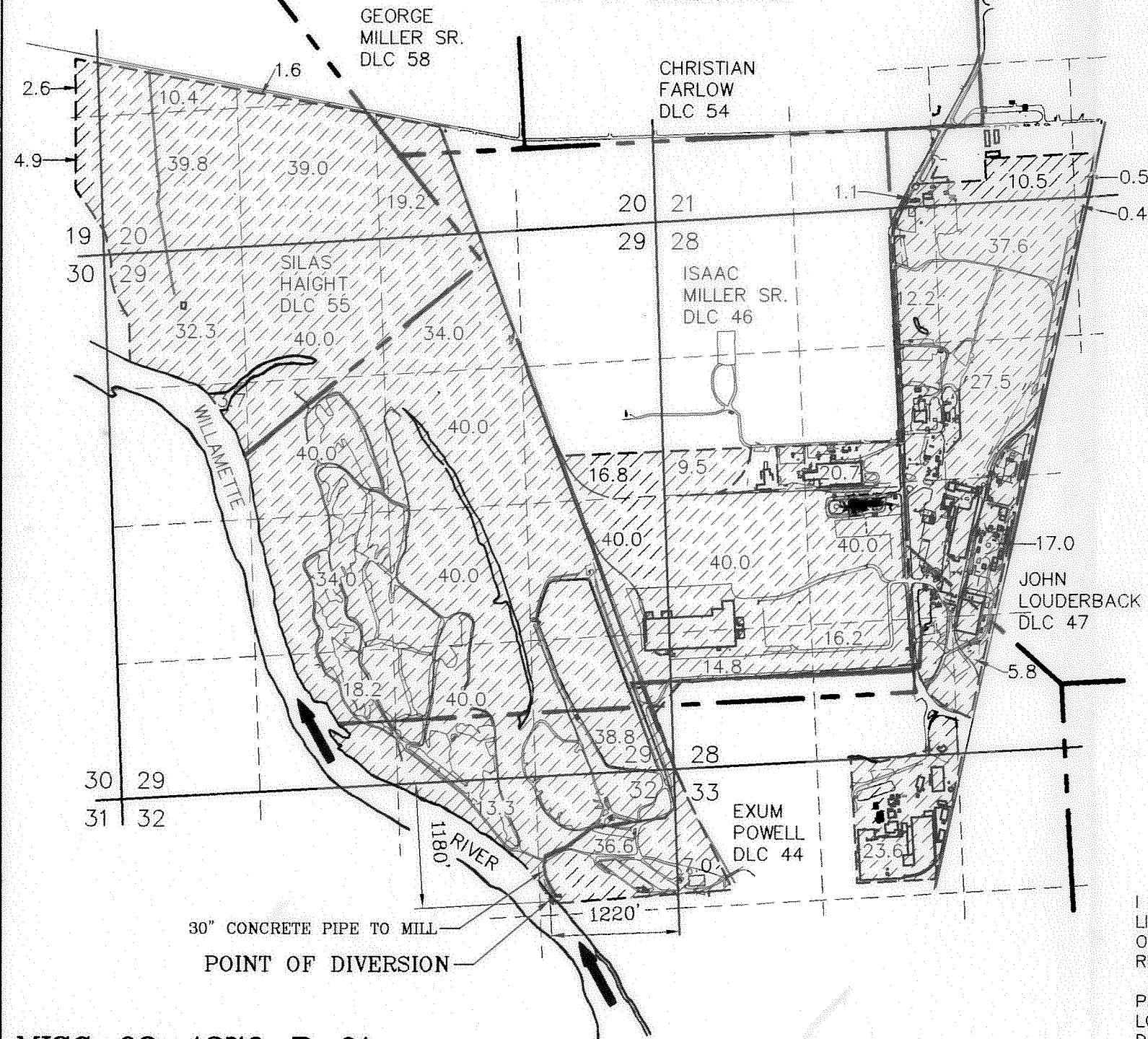

**RECEIVED**

**NOV 20 2002**

**WATER RESOURCES DEPT.  
SALEM, OREGON**

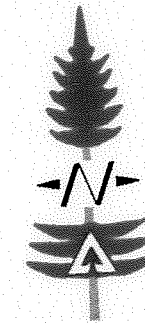

**LEGEND:**

- SECTION LINES
- - - FORTY LINES
- DONATION LAND CLAIM LINES
- - - APPROXIMATE PROPERTY LINE
- /// = AREA TO BE COVERED BY TRANSFER OF WATER RIGHTS 871.9 ACRES

**ACREAGE SUMMARY**

SECTION 19 — SE 1/4, SE 1/4	4.9 ACRES DLC 55
NE 1/4, SE 1/4	2.6 ACRES DLC 55
SECTION 20 — SW 1/4, SW 1/4	39.8 ACRES DLC 55
NW 1/4, SW 1/4	10.4 ACRES DLC 55
SE 1/4, SW 1/4	39.0 ACRES DLC 55
	0.1 ACRES DLC 58
NE 1/4, SW 1/4	1.6 ACRES DLC 55
SW 1/4, SE 1/4	4.0 ACRES DLC 58
	5.6 ACRES DLC 46
	9.6 ACRES DLC 55
SECTION 21 — SE 1/4, SW 1/4	1.1 ACRES DLC 47
SW 1/4, SE 1/4	10.5 ACRES DLC 47
SE 1/4, SE 1/4	0.5 ACRES DLC 47
SECTION 28 — NW 1/4, NE 1/4	37.6 ACRES DLC 47
NE 1/4, NW 1/4	12.2 ACRES DLC 47
NE 1/4, NE 1/4	0.4 ACRES DLC 47
SW 1/4, NE 1/4	27.5 ACRES DLC 47
SE 1/4, NW 1/4	12.2 ACRES DLC 47
	8.5 ACRES DLC 46
NW 1/4, SE 1/4	16.0 ACRES DLC 47
	1.0 ACRES DLC 44
SW 1/4, SE 1/4	5.8 ACRES DLC 44
NE 1/4, SW 1/4	4.5 ACRES DLC 44
	7.4 ACRES DLC 47
	28.1 ACRES DLC 46
SE 1/4, SW 1/4	8.5 ACRES DLC 44
	9.9 ACRES DLC 46
SW 1/4, NW 1/4	9.5 ACRES DLC 46
NW 1/4, SW 1/4	40.0 ACRES DLC 46
SW 1/4, SW 1/4	14.8 ACRES DLC 46
SECTION 29 — SE 1/4, NW 1/4	16.8 ACRES DLC 46
NE 1/4, SE 1/4	40.0 ACRES DLC 46
SE 1/4, SE 1/4	21.0 ACRES DLC 46
	17.8 ACRES DLC 44
NW 1/4, NE 1/4	20.2 ACRES DLC 46
	13.8 ACRES DLC 55
SW 1/4, NE 1/4	40.0 ACRES DLC 46
NW 1/4, SE 1/4	40.0 ACRES DLC 46
SW 1/4, SE 1/4	20.9 ACRES DLC 46
	19.1 ACRES DLC 44
NE 1/4, NW 1/4	1.4 ACRES DLC 46
	38.6 ACRES DLC 55
SE 1/4, NW 1/4	7.0 ACRES DLC 55
	33.0 ACRES DLC 46
NE 1/4, SW 1/4	34.0 ACRES DLC 46
SE 1/4, SW 1/4	12.6 ACRES DLC 46
	5.6 ACRES DLC 44
NW 1/4, NW 1/4	32.3 ACRES DLC 55
SW 1/4, NW 1/4	3.7 ACRES DLC 55
SECTION 32 — NW 1/4, NE 1/4	13.3 ACRES DLC 44
NE 1/4, NE 1/4	36.6 ACRES DLC 44
SECTION 33 — NW 1/4, NW 1/4	7.0 ACRES DLC 44
NE 1/4, NW 1/4	23.6 ACRES DLC 44

**871.9 ACRES TOTAL**

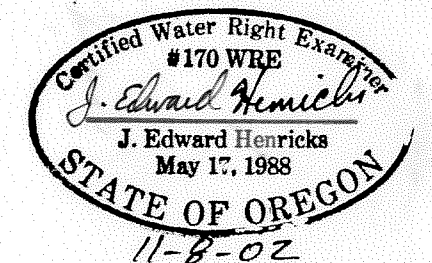

I J. EDWARD HENRICKS, BEING DULY SWORN AS A WATER RIGHT EXAMINER LICENSE NO. 170, HAVE PREPARED THIS MAP FOR WEYERHAEUSER COMPANY ON THIS 8th DAY OF NOVEMBER, 2002. THE AREAS HATCHURED REPRESENT THE AREAS APPLIED TO BENEFICIAL USE.

PREPARATION OF THIS MAP IS FOR THE PURPOSE OF IDENTIFYING THE LOCATION OF THE WATER RIGHT ONLY AND HAS NO INTENT TO PROVIDE DIMENSIONS OR LOCATION OF PROPERTY OWNERSHIP LINES.

MISC-02-4276-P-01

**ONLY DOCUMENTS STAMPED WITH  
RED INK ARE ORIGINALS.**