

0 660 1,320 2,640 3,960 5,280 Feet

T 14 S, R 17 E, WM

CROOK COUNTY, OREGON

1" = 1320'



RECEIVED BY OWRD

JUN 20 2014

SALEM, OR

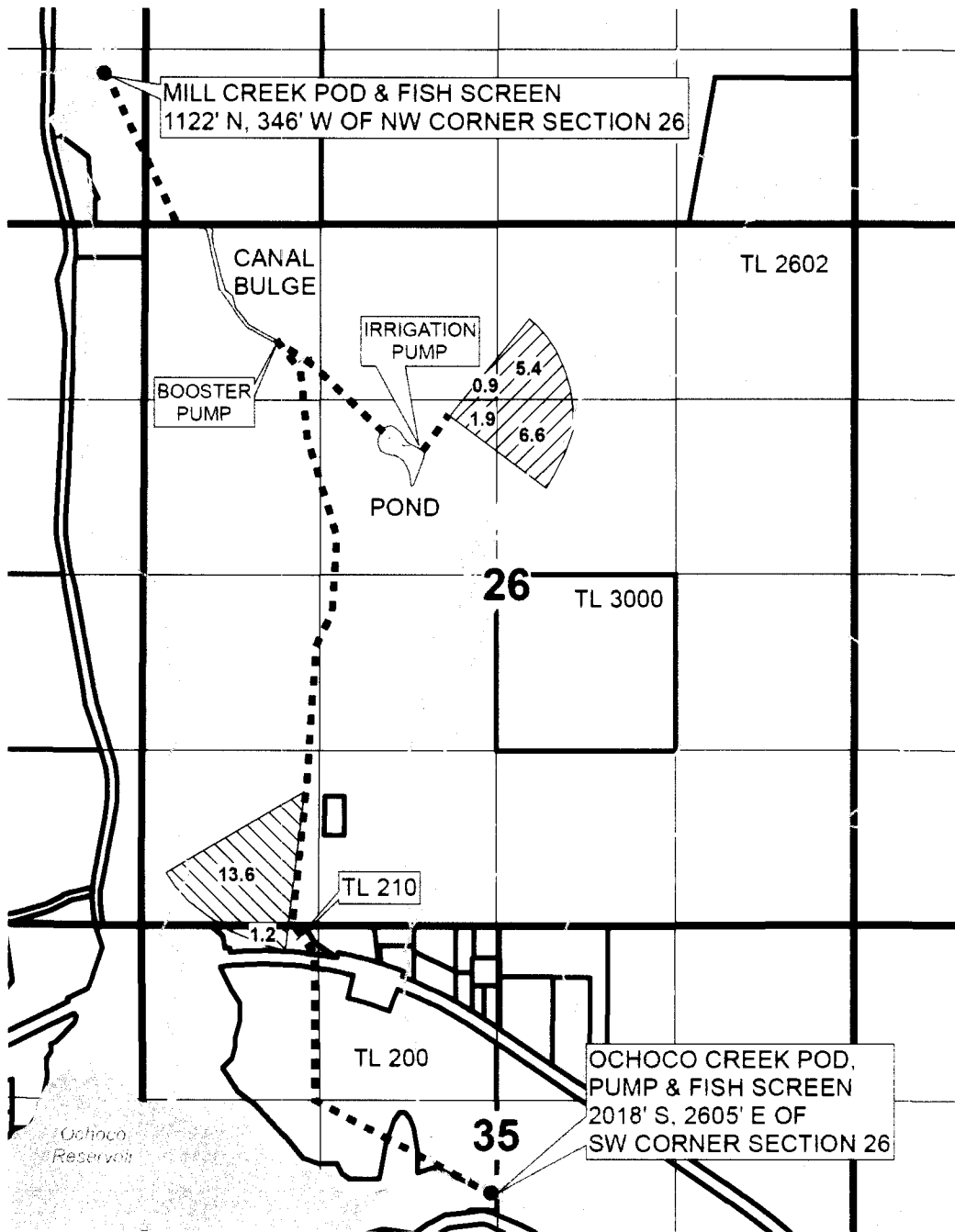

--- BURIED PIPELINES

 1868 MILL CREEK POU BY QQ (FROM 83657)

 1880 OCHOCO CREEK POU BY QQ (FROM 83658)

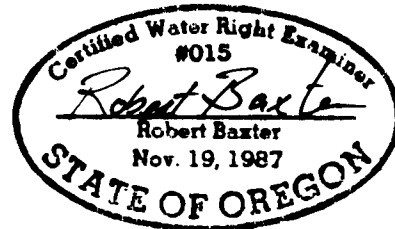

RENEWAL DATE: 12-31-2015



CLAIM OF BENEFICIAL USE MAP FOR MILL CREEK LAND, LLC

TRANSFER T-11465 APR 2, 2014

This map is not intended to provide legal dimensions or locations of property ownership lines.

JOB # 2012021

WATER RIGHT SERVICES, LLC

PO BOX 1830, BEND, OR 97709

WWW.OREGONWATER.US 541-389-2837

CCB # 197121

johnshort@usa.com