

**WATER RIGHT APPLICATION MAP
FOR WILLAMETTE INDUSTRIES, INC.
WARRENTON LUMBER MILL**

SECTIONS 15, 16, & 22
T. 8 N., R. 10 W., W.M.
CLATSOP COUNTY, OREGON

SCALE: 1" = 400' - 0"
115.0 ACRES ±

ONLY DOCUMENTS STAMPED
WITH RED INK ARE ORIGINALS

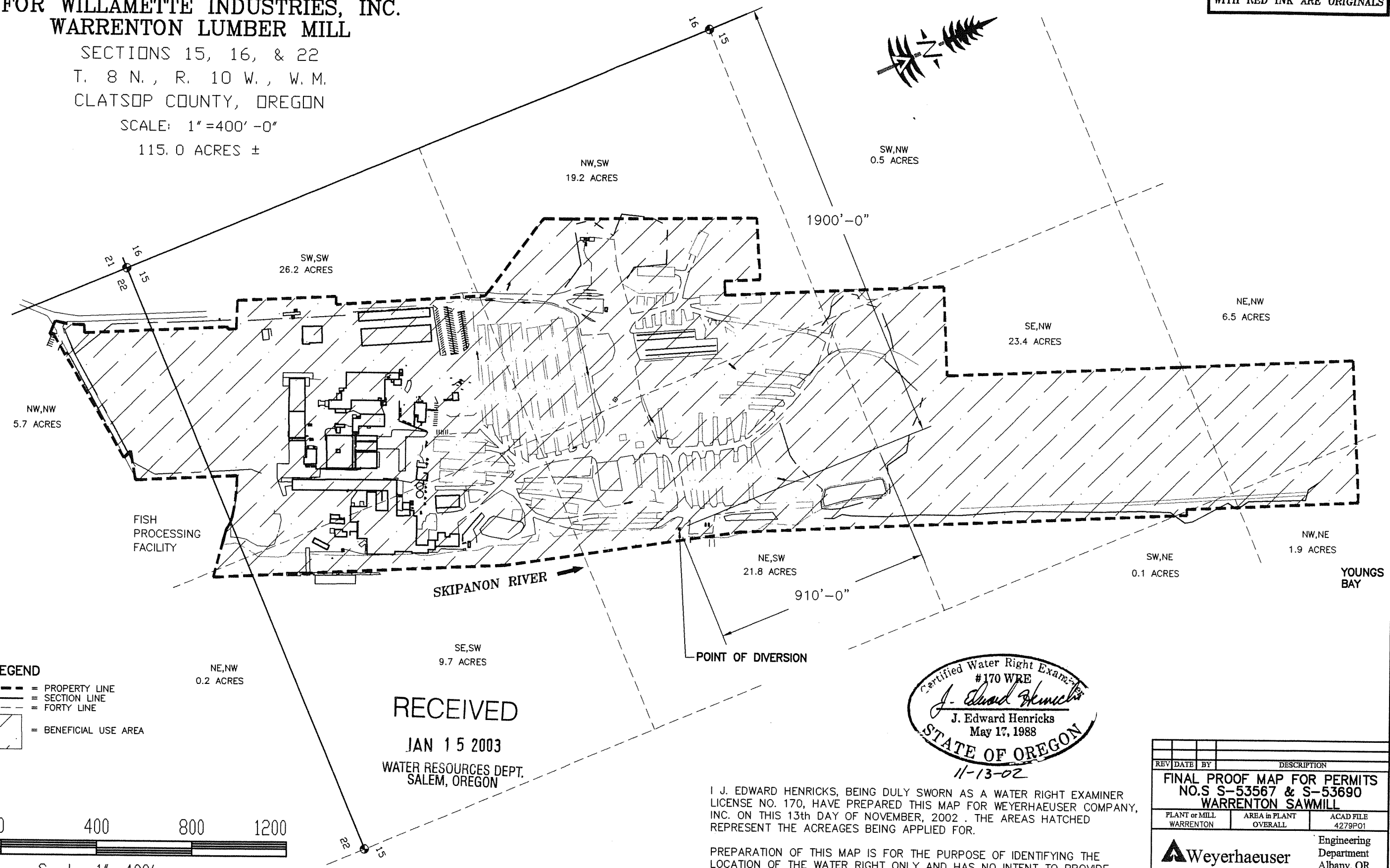

LEGEND
 - - - - - = PROPERTY LINE
 - - - - - = SECTION LINE
 - - - - - = FORTY LINE
 [Hatched Area] = BENEFICIAL USE AREA

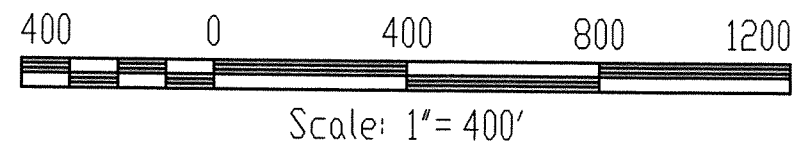

RECEIVED
 JAN 15 2003
 WATER RESOURCES DEPT.
 SALEM, OREGON

Certified Water Right Examiner
 #170 WRE
J. Edward Henricks
 J. Edward Henricks
 May 17, 1988
 STATE OF OREGON
 11-13-02

I J. EDWARD HENRICKS, BEING DULY SWORN AS A WATER RIGHT EXAMINER LICENSE NO. 170, HAVE PREPARED THIS MAP FOR WEYERHAEUSER COMPANY, INC. ON THIS 13th DAY OF NOVEMBER, 2002. THE AREAS HATCHED REPRESENT THE ACREAGES BEING APPLIED FOR.

PREPARATION OF THIS MAP IS FOR THE PURPOSE OF IDENTIFYING THE LOCATION OF THE WATER RIGHT ONLY AND HAS NO INTENT TO PROVIDE DIMENSIONS OR LOCATION OF PROPERTY OWNERSHIP LINES.

REV	DATE	BY	DESCRIPTION
FINAL PROOF MAP FOR PERMITS NO.S S-53567 & S-53690 WARRENTON SAWMILL			
PLANT or MILL WARRENTON	AREA in PLANT OVERALL	ACAD FILE 4279P01	
			Engineering Department Albany, OR
SCALE: 1" = 400'		DATE: NOV. 13, 2002	
DRAWN BY: JEH		PLT @ 1 = 1200	TIME: 09:27
DRAWING: WAR-02-4278-P-01 REV			