

TOWNSHIP 1 SOUTH, RANGE 3 WEST, W.M.

PORTIONS OF SECTION 16
WASHINGTON COUNTY, OREGON

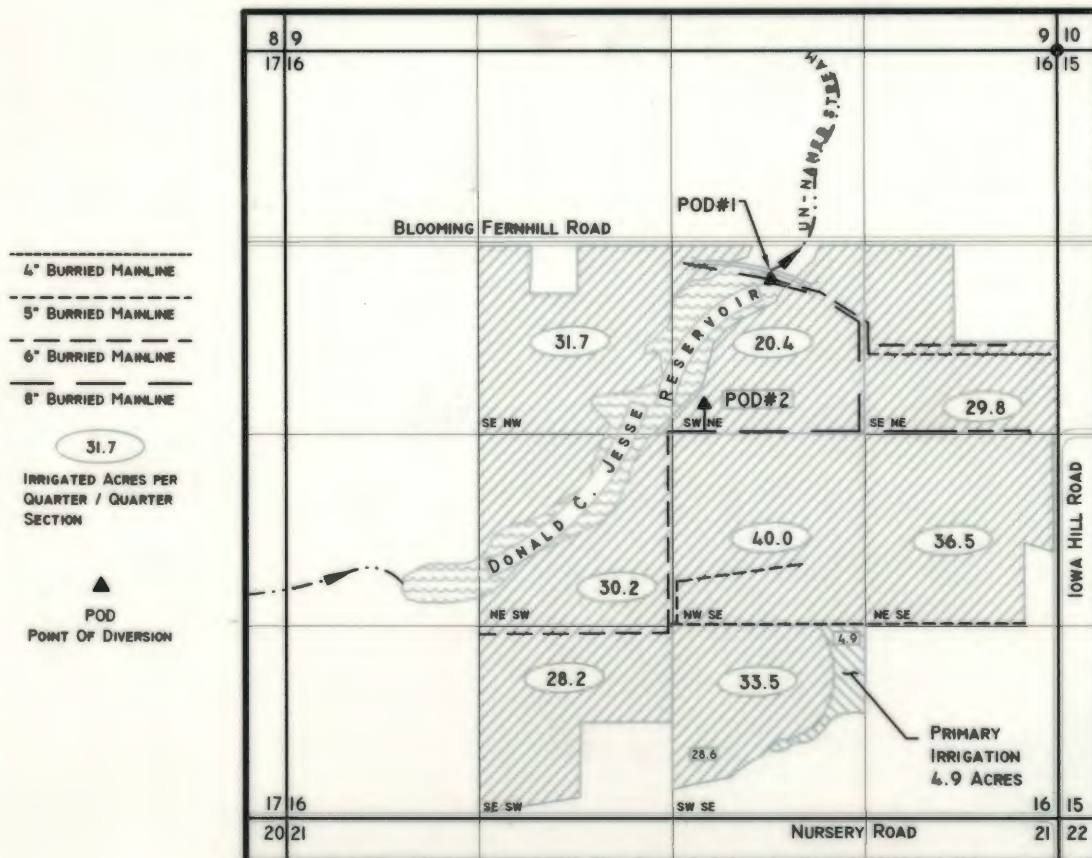

P.O.D. #1 LOCATED 1,546 FEET SOUTH AND 1,956 FEET WEST OF THE NORTHEAST CORNER OF SECTION 16, T.1S., R3W., W.M.

P.O.D. #2 LOCATED 2,399 FEET SOUTH AND 2,418 FEET WEST OF THE NORTHEAST CORNER OF SECTION 16, T.1S., R3W., W.M.

FINAL PROOF SURVEY
UNDER
APPLICATION NO. 83363, PERMIT NO. 53411

IN THE NAME OF
ALAN M. JESSE
JAMES R. FURBY
MAY 29, 2001

RECEIVED

JUN 11 2001

WATER RESOURCES DEPT.
SALEM, OREGON

SOURCE OF WATER: DONALD C. JESSE RESERVOIR
PERMIT NO. R-12479 LOCATED ON AN UN-NAMED
STREAM TRIBUTARY TO THE TUALATIN RIVER.

ALL ACREAGE IS SUPPLEMENTAL IRRIGATION WITH
THE EXCEPTION OF 4.9 ACRES IN THE SW 1/4 SE 1/4
SECTION 16 WHICH IS PRIMARY.

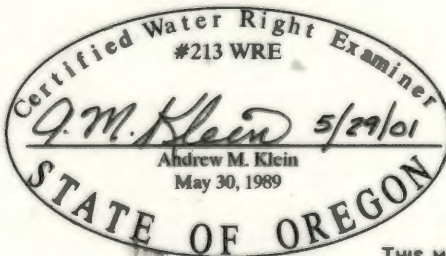

Expires 6/30/2001

THIS MAP WAS PREPARED FOR THE PURPOSE OF
IDENTIFYING THE LOCATION OF WATER RIGHT(S) ONLY
AND IS NOT INTENDED TO PROVIDE LEGAL DIMENSIONS OR
LOCATION OF PROPERTY OWNERSHIP LINES.