

MONROE DROP HYDRO ELECTRIC PROJECT IN SECTION 12 T13S R12E W.M. JEFFERSON COUNTY, OREGON

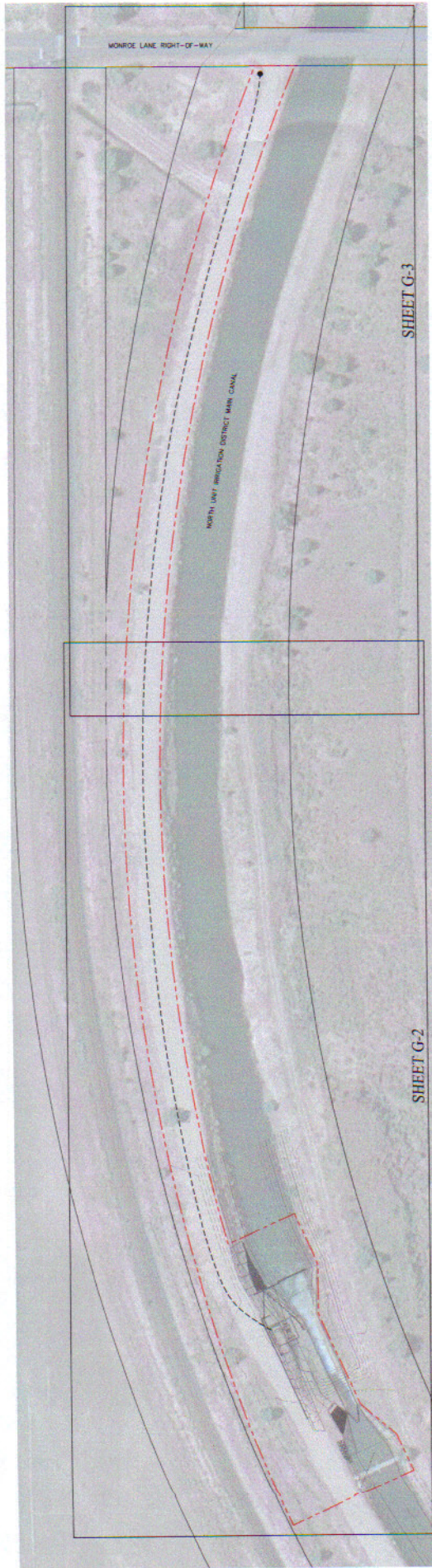

I HEREBY CERTIFY THAT I AM A LICENSED LAND SURVEYOR IN OREGON AND THAT THE MAPPING AND LEGAL BOUNDARY PROVIDED HEREIN COMPLY WITH THE REQUIREMENTS OF THE PROFESSIONAL LAND SURVEYORS BOARD, OREGON, AND THE SURVEYING BOARD, JAN 2012.

REGISTERED PROFESSIONAL LAND SURVEYOR
JAMES S. LUTHERY
RENEWALS 12-31-2014

BLACK ROCK
SURVEYING

MONROE DROP HYDRO ELECTRIC
PROJECT-FERC P-14430

EXHIBIT G	
DESIGN/PROJECT NO.	SCALE: 1" = 50'
DRAWN BY	DATE: 01-24-2013
G-1	