

T.3S. R.<sup>3</sup>4W. W.M.  
YAMHILL COUNTY

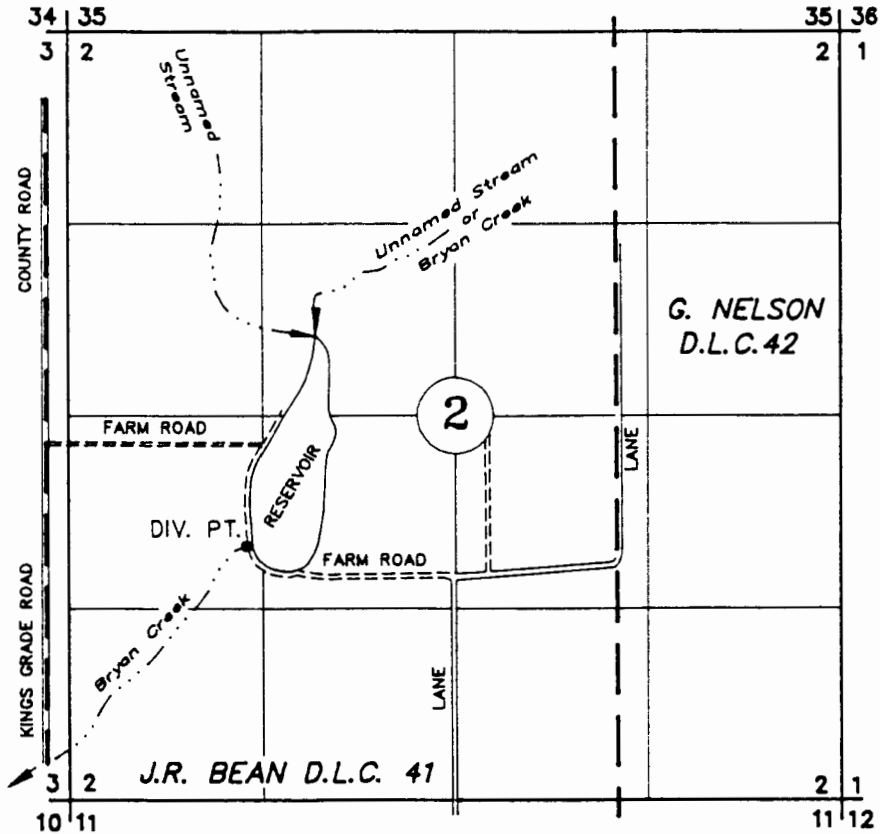

DIV. PT. LOCATION: NW 1/4 SW 1/4, SEC. 2 WITHIN BEAN D.L.C. 41;  
175°N AND 124°E OF SE COR. SEC. 2

**RECEIVED**  
OCT 01 1989  
WATER RESOURCES DEPT  
SALEM, OREGON

**FINAL PROOF SURVEY**  
UNDER

Application No. R-25833 R-28748 R-29637 R-70217 Permit No. R-1407 R-1560 R-1761 R-12495 Transfer No. T-6354

**BAILEY NURSERIES INC**

AUG 21, 1998  
SCALE 1" = 1320'  
REV. 7-8-2003 JMB

NOTE: This map is for the purpose of identifying the location of water rights and has no intent to dimension or locate property ownership lines.

