

# T.6S. R.2W., W.M

RECEIVED

SEP 21 1999

LAND SURVEILLANCE DEPT  
SALEM OREGON

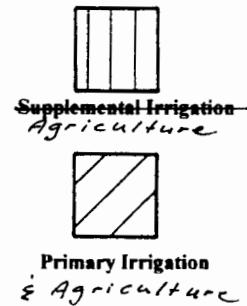
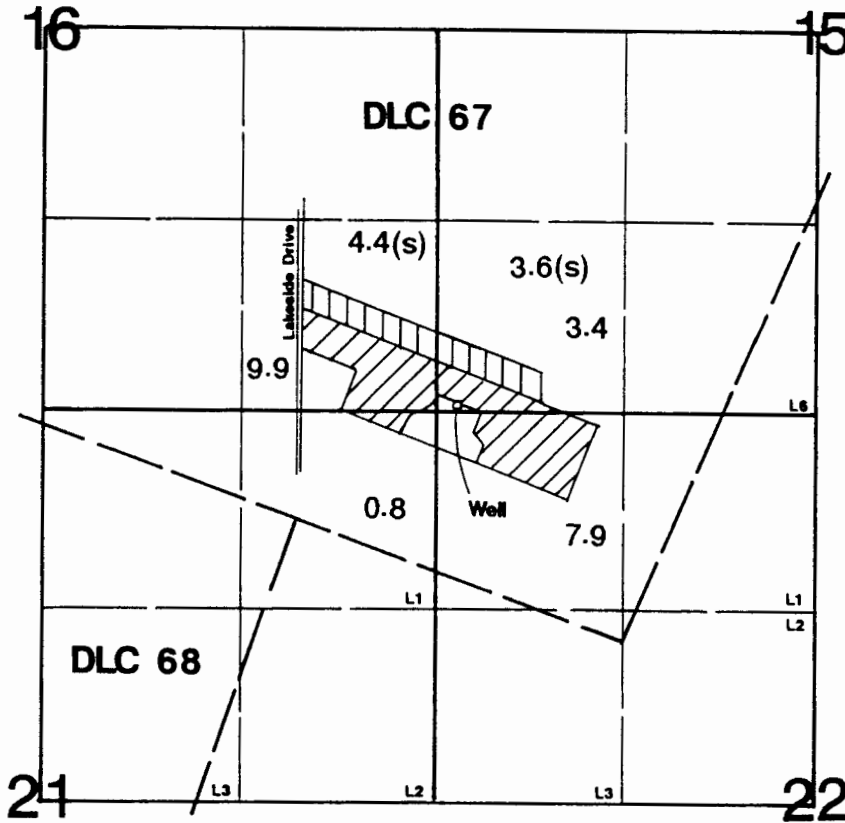

Well is located 780'N & 1090'E from the NE corner of DLC 68.

## Final Proof Survey

Application #: G-13478 Permit #: G-12310

In Name Of

### Melvin R. Franke

Surveyed on September 14, 1999 by JM Schuette

This Map Was Prepared For The Purpose Of Identifying The Location Of A Water Right Only And Is Not Intended To Provide Legal Dimensions Or Location Of Property Ownership Lines.



Updated Legend MB/wrd 9-22-14