

Portland\p:\0\0758077\00\Cad\mudcreek_broodpond.dwg SRB:MMJ 02/20/03

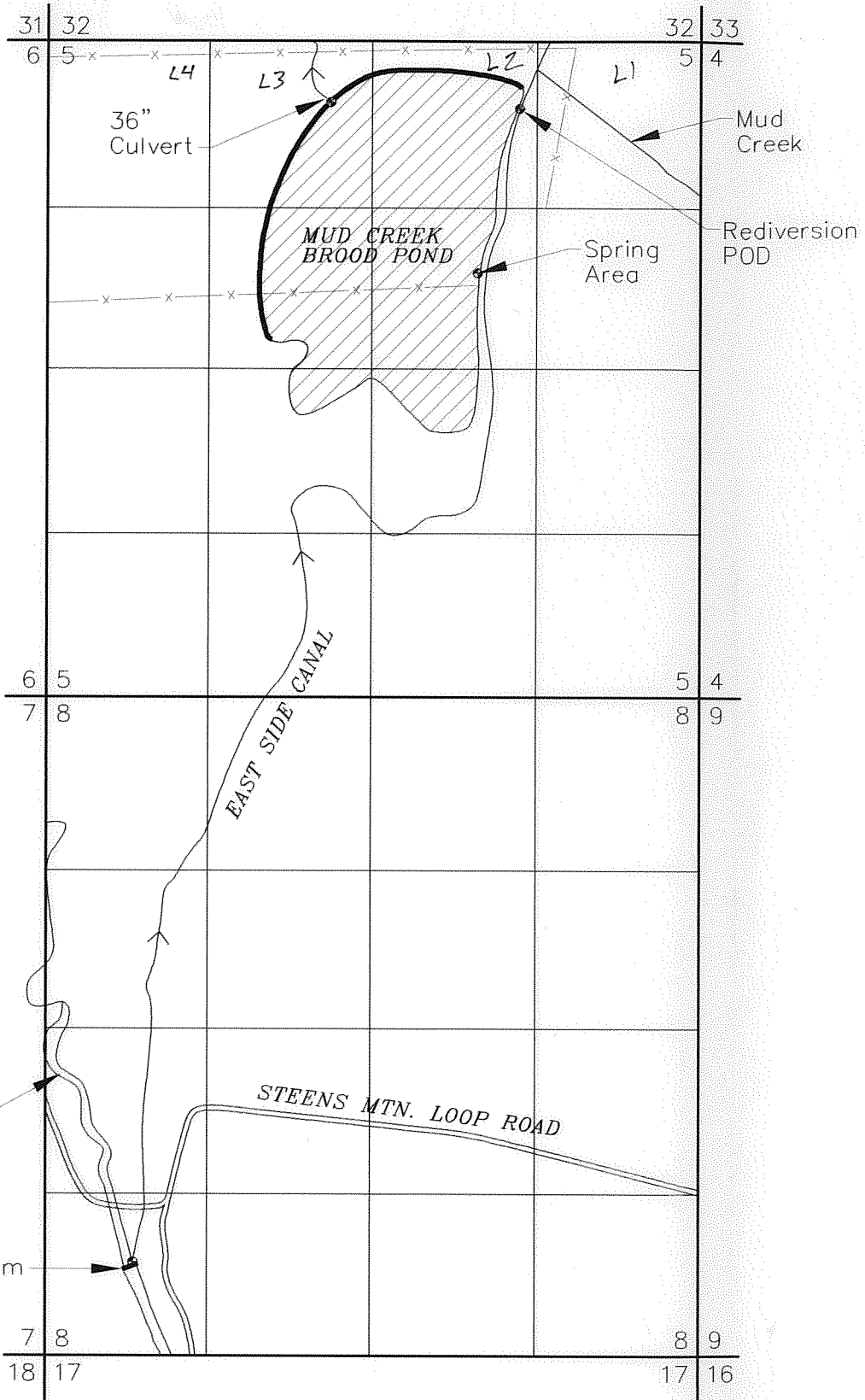

TOWNSHIP 32 SOUTH, RANGE 32 1/2 EAST, W.M.
SECTION 5



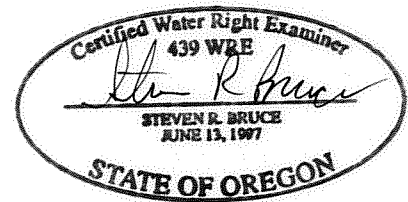

APPLICATION R-81145, PERMIT R-11985
MUD CREEK BROOD POND
MALHEUR NATIONAL WILDLIFE REFUGE

1 INCH = 1320 FEET

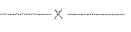

RECEIVED
MAR 03 2003
WATER RESOURCES DEPT.
SALEM, OREGON

EXPLANATION:

-  PLACE OF USE
-  POINT OF DIVERSION (POD)
-  FENCE LINE
-  DAM

NOTES:

1. East Side Canal POD from Page Spring Dam located 780 feet north and 800 feet east of southwest corner of Section 8.
2. Brood Pond rediversion POD on East Side Canal located 540 feet south and 1,450 feet west of northeast corner of section 5.
3. Brood Pond POD on dam located 590 feet south and 3,030 feet west of northeast corner of section 5.
4. Spring area located 1,850 feet south and 1,780 feet west of northeast corner of Section 5.
5. Survey completed on September 26-29, and October 19, 2002.

Government Lot #s added to map
by WRD/JC 12/18/14

THE PURPOSE OF THIS MAP IS TO IDENTIFY THE LOCATION OF THE WATER RIGHT. IT IS NOT INTENDED TO PROVIDE INFORMATION RELATIVE TO THE LOCATION OF PROPERTY OWNERSHIP BOUNDARY LINES.



CLAIM OF BENEFICIAL USE MAP
U.S. FISH AND WILDLIFE SERVICE

FIGURE 1