

T. 6 S., R. 6 W., W. M.

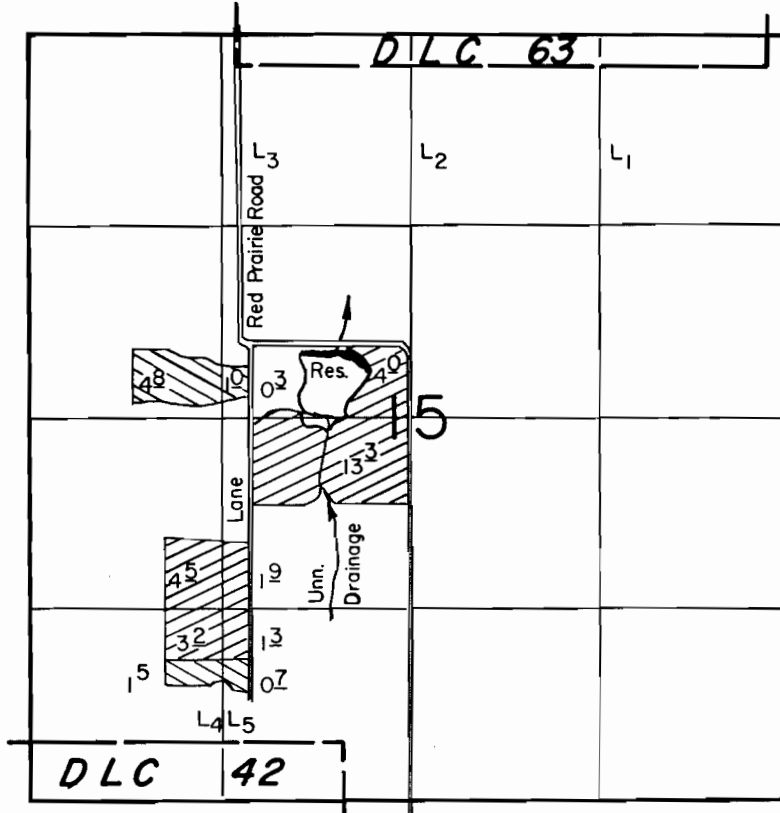

P.O.D. Loc. : 2230' S. & 2130' E. from NW Cor. Sec. 15.

Scale : 1" = 1320'

### FINAL PROOF SURVEY UNDER

R-68350

R-10506

Application No. 68351... Permit No. 49379.....

IN NAME OF

DEPT. OF VETERANS AFFAIRS

Surveyed Oct. 26, 1989, by T. Warren.....

Primary 

Supplemental 