

MAP TO ACCOMPANY CLAIM OF BENEFICIAL USE
FOR
APPLICATION NO. S-70310 AND PERMIT NO. 52737
IN THE NAME OF
H.R. CHRISTENSEN

TOWNSHIP 40 SOUTH, RANGE 19 EAST W.M.
LAKE COUNTY OREGON

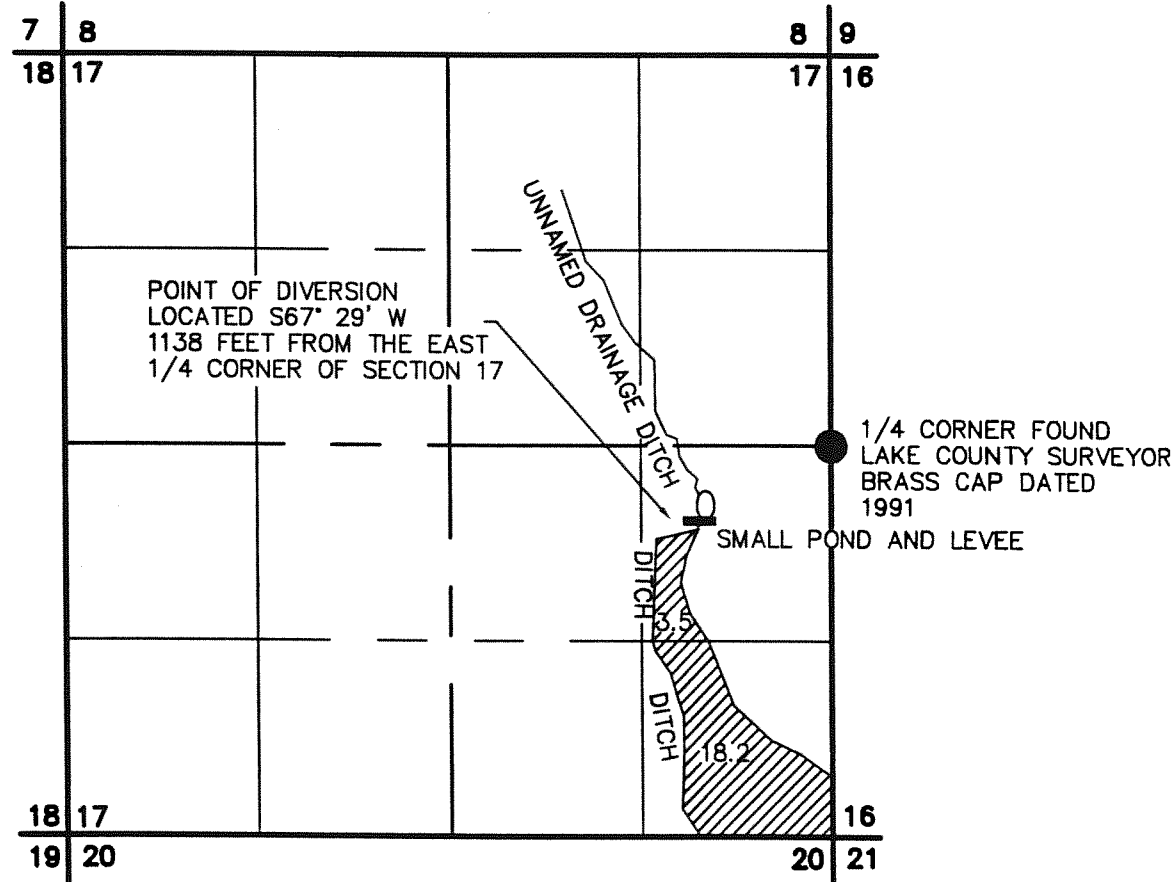

INDICATES AREA BEING IRRIGATED
TOTAL AREA IRRIGATED 21.7 ACRES



SCALE: 1"=1320'

LEGEND

- SECTION LINE
- 1/4 SECTION LINE
- 1/16 SECTION LINE

NOTE: PREPARATION OF THIS MAP IS FOR IDENTIFYING PROPOSED WATER RIGHTS ONLY. IT HAS NO INTENT TO PROVIDE LOCATIONS OR DIMENSIONS OF PROPERTY BOUNDRIES..

RECEIVED
JUL 08 2003
WATER RESOURCES DEPT
SALEM, OREGON

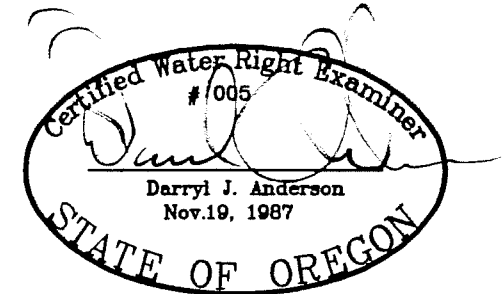

RENEWAL 12/31/95

PREPARED FOR: H.R. CHRISTENSEN 15127 WESTSIDE ROAD LAKEVIEW, OREGON 97630 (541) 947-2988	
PREPARED BY: ANDERSON ENGINEERING & SURVEYING, INC. P.O. BOX 28 P.O. BOX 419 LAKEVIEW, OREGON 97630 REDMOND, OREGON 97756 (541) 947-4407 (541) 923-4307 FAX 947-2321 FAX 923-4308	
DATE: JUNE 2003	DWG. FILE: 2003-29
JOB NO.: 2003-29	SHEET 1 OF 1