

**Map for
Claim of Beneficial Use
City of Eagle Point
T-10160
T 35 & 36 S, R 1 W**

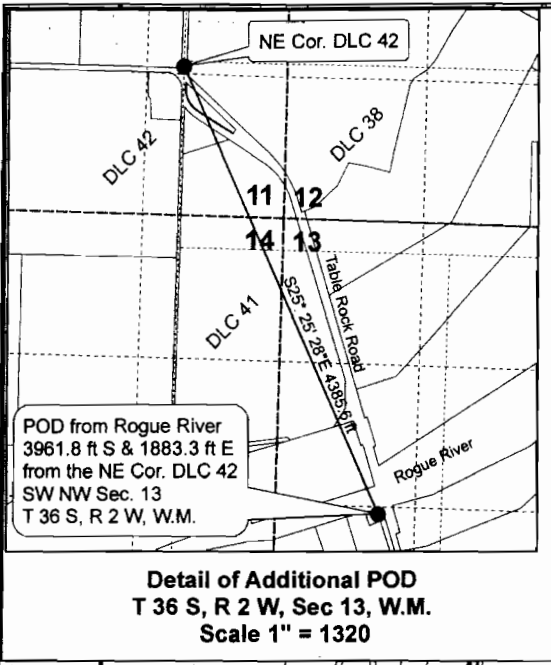
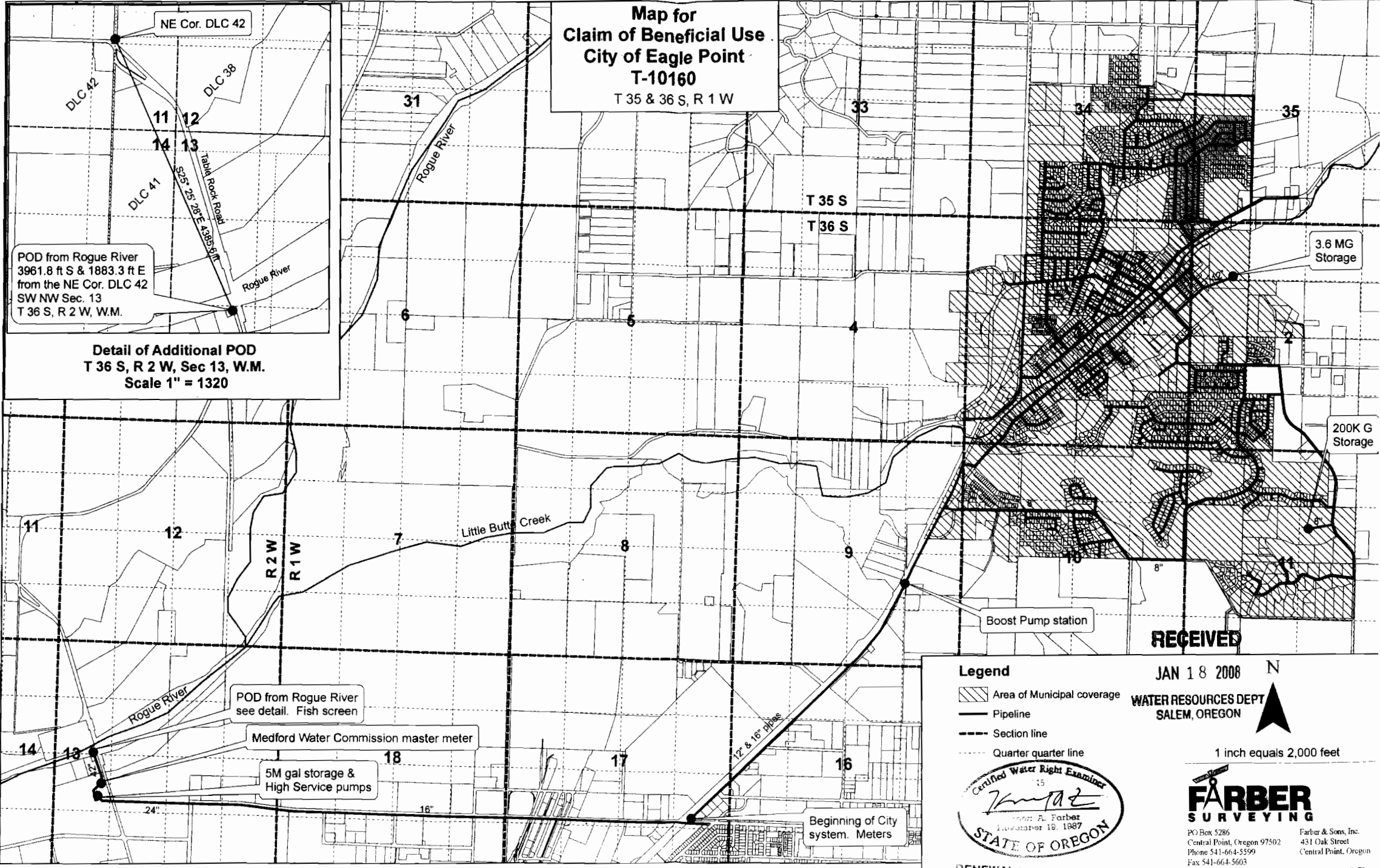

POD from Rogue River
3961.8 ft S & 1883.3 ft E
from the NE Cor. DLC 42
SW NW Sec. 13
T 36 S, R 2 W, W.M.

**Detail of Additional POD
T 36 S, R 2 W, Sec 13, W.M.
Scale 1" = 1320**

Legend

- Area of Municipal coverage
- Pipeline
- Section line
- Quarter quarter line

RECEIVED
JAN 18 2008
WATER RESOURCES DEPT
SALEM, OREGON

1 inch equals 2,000 feet

Certified Water Right Examiner
Mark A. Farber
Mark A. Farber
November 19, 1987
STATE OF OREGON

FARBER SURVEYING
PO Box 5286
Central Point, Oregon 97502
Phone 541-664-5359
Fax 541-664-5603
Email hfarber@charter.net

Farber & Sons, Inc.
431 Oak Street
Central Point, Oregon
Tax ID: 93-1057173

RENEWAL DATE 12-31-07

POD from Rogue River
see detail. Fish screen

Medford Water Commission master meter

5M gal storage &
High Service pumps

Beginning of City
system. Meters