

T. 1 S., R. 21 E., W. M.

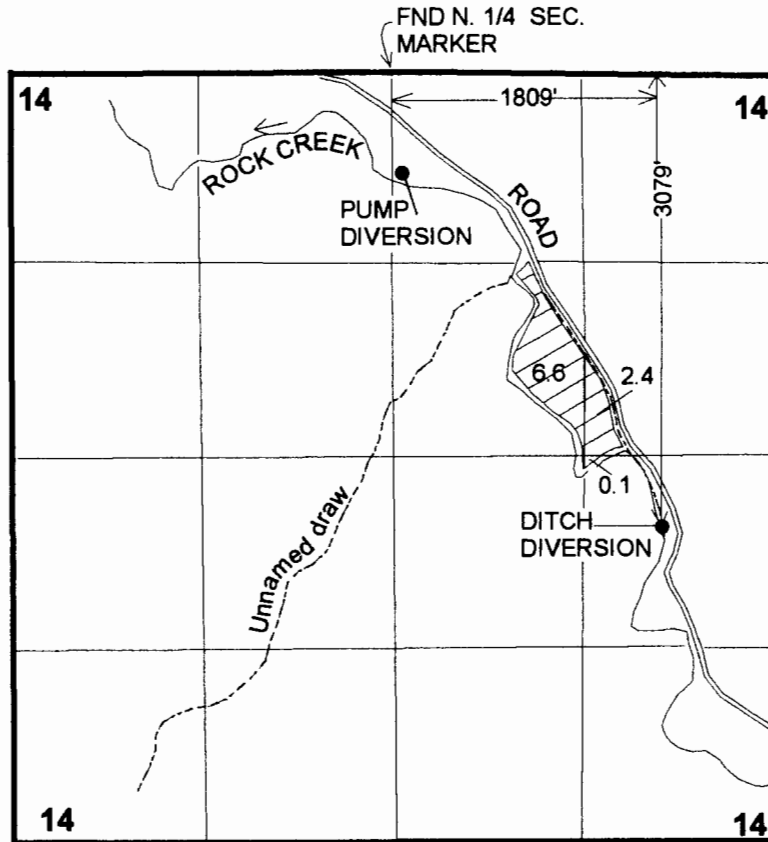

PUMP DIVERSION - 660' S. & 55' E. from the N. 1/4 Cor., Sec. 14.

FINAL PROOF SURVEY
UNDER
Application No. 58847 Permit No. 44677

IN THE NAME OF
ELSIE G. OLSEN

Surveyed Feb. 6, 1991 By K. Kemp

RECEIVED
OCT 03 2002
WATER RESOURCES DEPT
SALEM, OREGON