

T. 9. S., R. 2 W., W.M. <sup>3 80</sup>

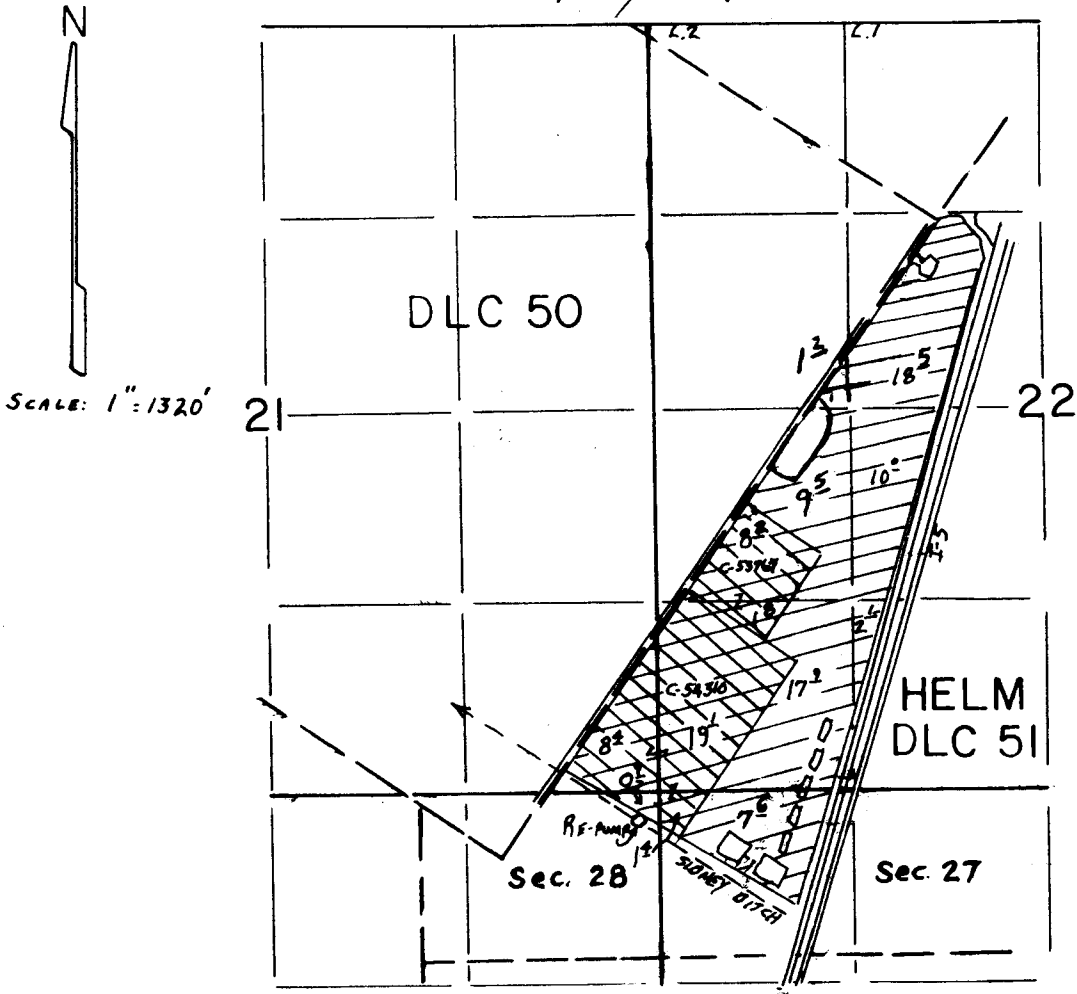

T. 9. S., R. 2 W., W.M.  
SEC. 34

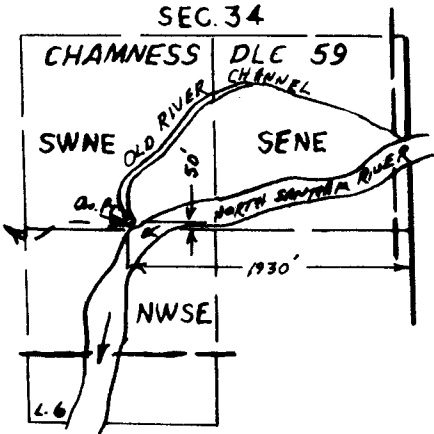

THIS MAP WAS PREPARED SOLELY FOR THE PURPOSE OF DEPICTING THE LOCATION OF A WATER RIGHT, AND HAS NO INTENTION OF BEING USED TO DETERMINE REAL PROPERTY BOUNDARIES.

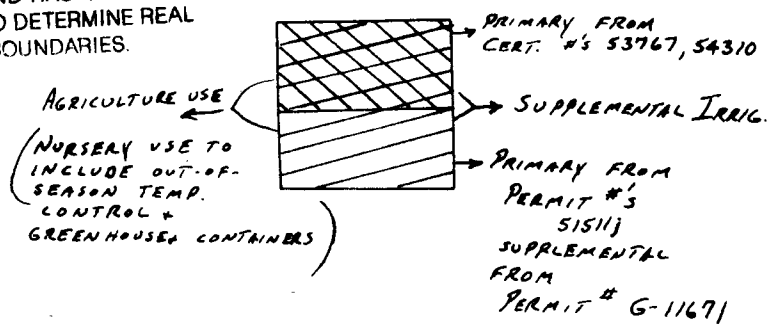

P.O.D. Loc.: 50' N + 1930' W.  
FROM E. 1/4 COR  
SEC. 34

**FINAL PROOF SURVEY UNDER**

App. S-81980 Permit S-53434  
in name of

**HAROLD M. MILLER**

Surveyed 9/18/2003 by T.M. Warren

Tie:  
ASCS photo  
41047-489-135C

&

ODOT  
Project  
Photography

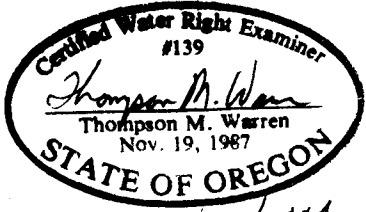

EXPIRES 6/30/2004