

RECEIVED

SEP 17 1998

WATER RESOURCES DEPT
SALEM, OREGON

T.8S., R.1W. & 2W., W.M

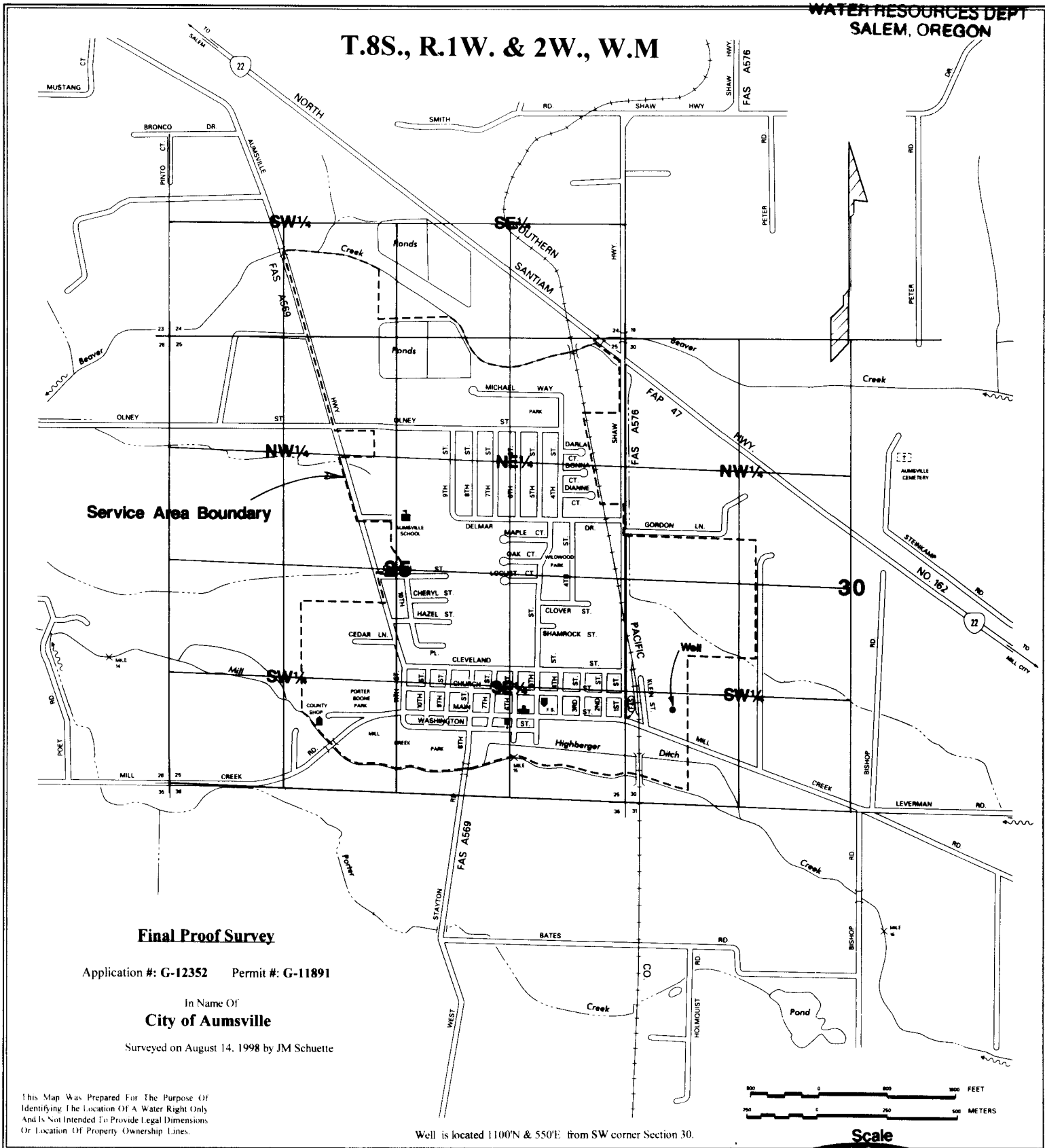

Service Area Boundary

Final Proof Survey

Application #: G-12352 Permit #: G-11891

In Name Of
City of Aumville

Surveyed on August 14, 1998 by JM Schuette

This Map Was Prepared For The Purpose Of
Identifying The Location Of A Water Right Only
And Is Not Intended To Provide Legal Dimensions
Or Location Of Property Ownership Lines.

Well is located 1100'N & 550'E from SW corner Section 30.

