

# FINAL PROOF SURVEY MAP IN THE NAME OF SHANE KENT

APPLICATION S - 81959  
APPLICATION R - 81960

PERMIT 53419  
PERMIT R-12494

SECTION 10, TOWNSHIP 31 SOUTH, RANGE 15 WEST, W.M.



RECEIVED

NOV 07 2003

WATER RESOURCES DEPT  
SALEM, OREGON

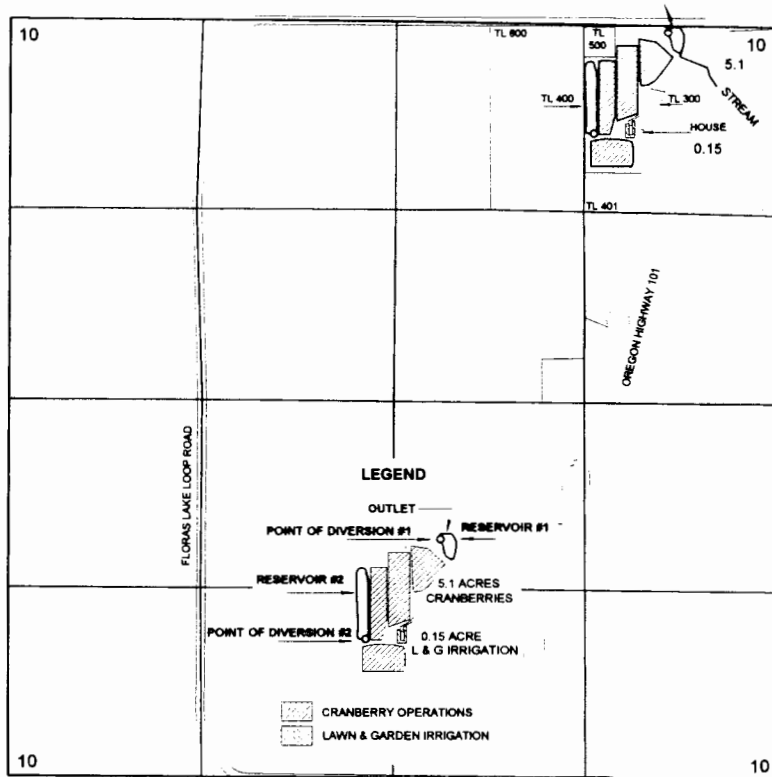

THE POINTS OF DIVERSION ARE LOCATED AS FOLLOWS:

No. 1: 80 FEET SOUTH AND 1840 FEET EAST;

No. 2: 780 FEET SOUTH AND 1335 FEET EAST; BOTH

FROM THE NORTH QUARTER CORNER OF SECTION 10; BEING WITHIN THE NE $\frac{1}{4}$  NE $\frac{1}{4}$  OF SECTION 10, TOWNSHIP 31 SOUTH, RANGE 15 WEST, W.M.; CURRY COUNTY.

THE RESERVOIRS ARE LOCATED AS FOLLOWS:

No. 1: 40 FEET SOUTH AND 1890 FEET EAST (OUTLET IN COUNTY ROAD);

No. 2: 520 FEET SOUTH AND 1320 FEET EAST (CENTER OF RESERVOIR); BOTH

FROM THE NORTH QUARTER CORNER OF SECTION 10; BEING WITHIN THE NE $\frac{1}{4}$  NE $\frac{1}{4}$  OF SECTION 10, TOWNSHIP 31 SOUTH, RANGE 15 WEST, W.M.; CURRY COUNTY.

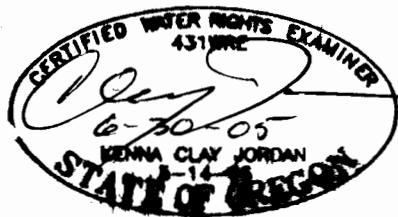

THE PURPOSE OF THIS MAP IS TO IDENTIFY THE LOCATION OF THE WATER RIGHT.  
IT IS NOT INTENDED TO PROVIDE INFORMATION RELATIVE TO THE LOCATION OF  
PROPERTY OWNERSHIP BOUNDARY LINES.