

CLAIM OF BENEFICIAL USE MAP FOR SURFACE WATER RIGHTS IN THE NAME OF EDWARD & MARILYN LIVINGSTON

Application # S-81008

Permit # 53158

LOCATED IN THE SEC. 20, T. 38S, R. 14E., W.M.
KLAMATH COUNTY, OREGON

RECEIVED

NOV 02 2000

WATER RESOURCES DEPT.
SALEM, OREGON

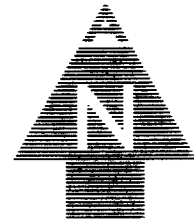

SCALE: 1" = 1320'

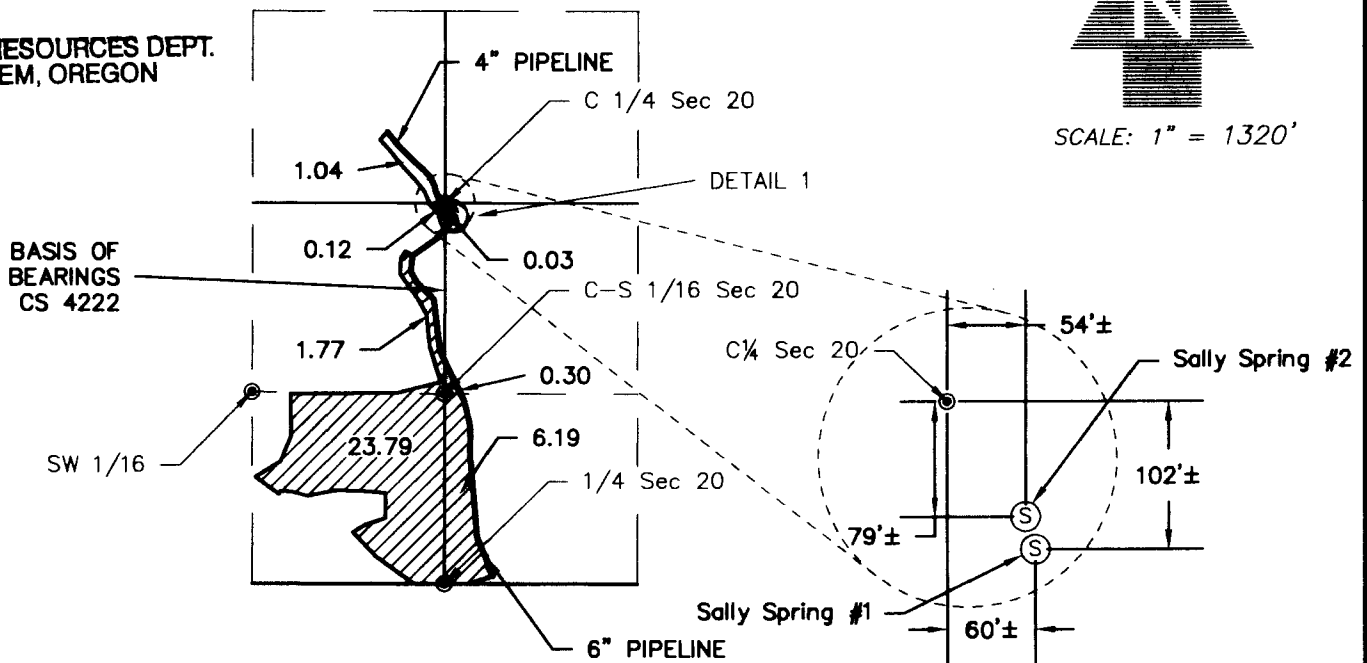

● FOUND MONUMENT PER CS 4222

⊙ SPRING

IRRIGATED ACREAGE

10.0 ACREAGE

DETAIL 1

NTS

MONUMENTS AND IRRIGATED
ACREAGE WERE LOCATED
BY GPS

THIS MAP IS FOR THE PURPOSE OF
IDENTIFYING THE LOCATION OF THE
WATER RIGHT ONLY AND HAS NO
INTENT TO PROVIDE DIMENSIONS OR
LOCATION OF PROPERTY LINES.

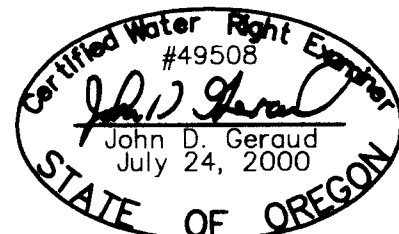

EXPIRES 7/30/01

ADKINS



Engineers ▲ Planners ▲ Surveyors

2950 Shasta Way · Klamath Falls, Oregon 97603 · (541) 884-4666 · FAX (541) 884-5335
Klamath Falls, OR · Medford, OR · Alturas, CA

July 31, 2000

JOB No. 2225-01