

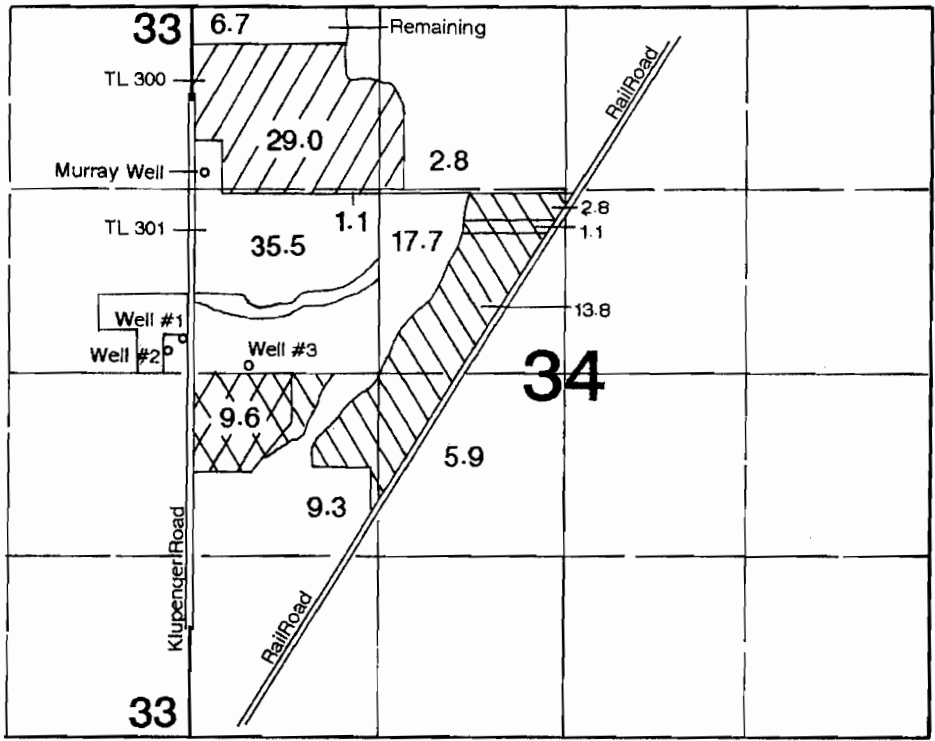



# T.3S., R.1W., W.M.



  
**Transfer From**  
 Cert. #83504 (Well #3)  
 Cert. #84230 (Murray Well)

  
**Transfer To**  
 Cert. #83504 (Well #3)  
 Cert. #84230 (Murray Well)

  
**Change in POA**  
 Cert. #56068  
 (Well #1 & #2 to Well #3)

Well #1 is located 260'N & 30'W from the E-1/4 corner of Section 33.  
 Well #2 is located 150'N & 190'W from the E-1/4 corner of Section 33.  
 Well #3 is located 10'N & 352'E from the W-1/4 corner of Section 34.  
 Murray Well is located 147'N & 132'E from the NW corner of SWNW, Section 34.

## Application Map

# Klupenger Nursery

Transfer #:

# RECEIVED

DEC 19 2012

WATER RESOURCES DEPT  
 SALEM, OREGON

This map was prepared for the purpose of identifying the location of a water right only and is not intended to provide legal dimensions or location of property ownership lines.

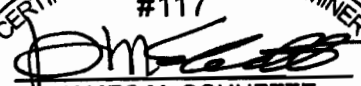
CERTIFIED WATER RIGHT EXAMINER  
 #117  
  
 JAMES M. SCHUETTE  
 NOV. 19, 1987  
 STATE OF OREGON

EXPIRES: 6/30/2014

# T.3S., R.1W., W.M.

RECEIVED

MAY 4 1994

WATER RESOURCES DEPT.  
SALEM, OREGON

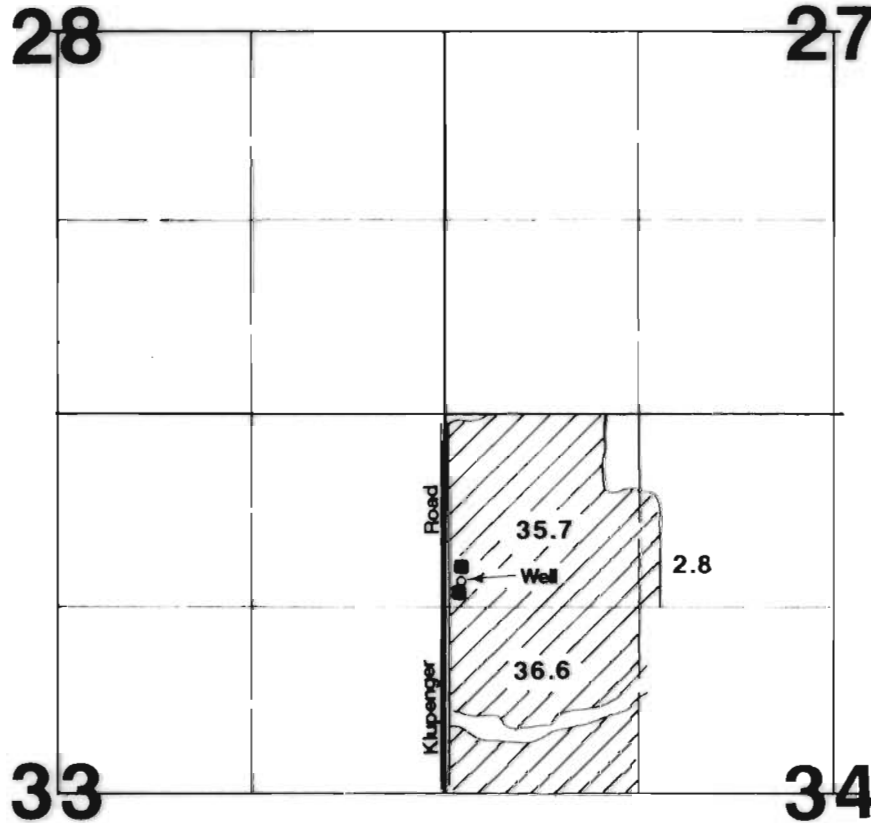

1" = 1320'

Nursery Operations

Well located 147'N & 132'E from NW corner SW¼ NW¼, Section 34.

## Final Proof Survey

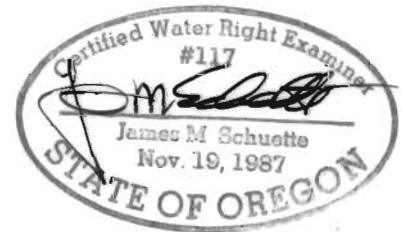

Application #: G-11638

Permit #: G-10852

In Name Of

## Klupengers Nursery & GHSE, Inc.

Surveyed on March 26, 1994 by JM Schuette

THIS MAP WAS PREPARED FOR THE PURPOSE OF IDENTIFYING THE LOCATION OF A WATER RIGHT ONLY AND IS NOT INTENDED TO PROVIDE LEGAL DIMENSIONS OR LOCATION OF PROPERTY OWNERSHIP LINES.