

# CLAIM OF BENEFICIAL USE

APPLICATION No. T-6577

PERMIT No. D-4205

TAX LOT No. 10 38 1000 - BAKER COUNTY  
Deer Creek a tributary of Powder River

Applicant:  
Kenneth Errend  
1925 Washington Street  
Baker City, OR 97814



Scale 1" = 1320'

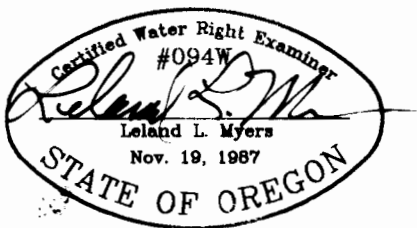
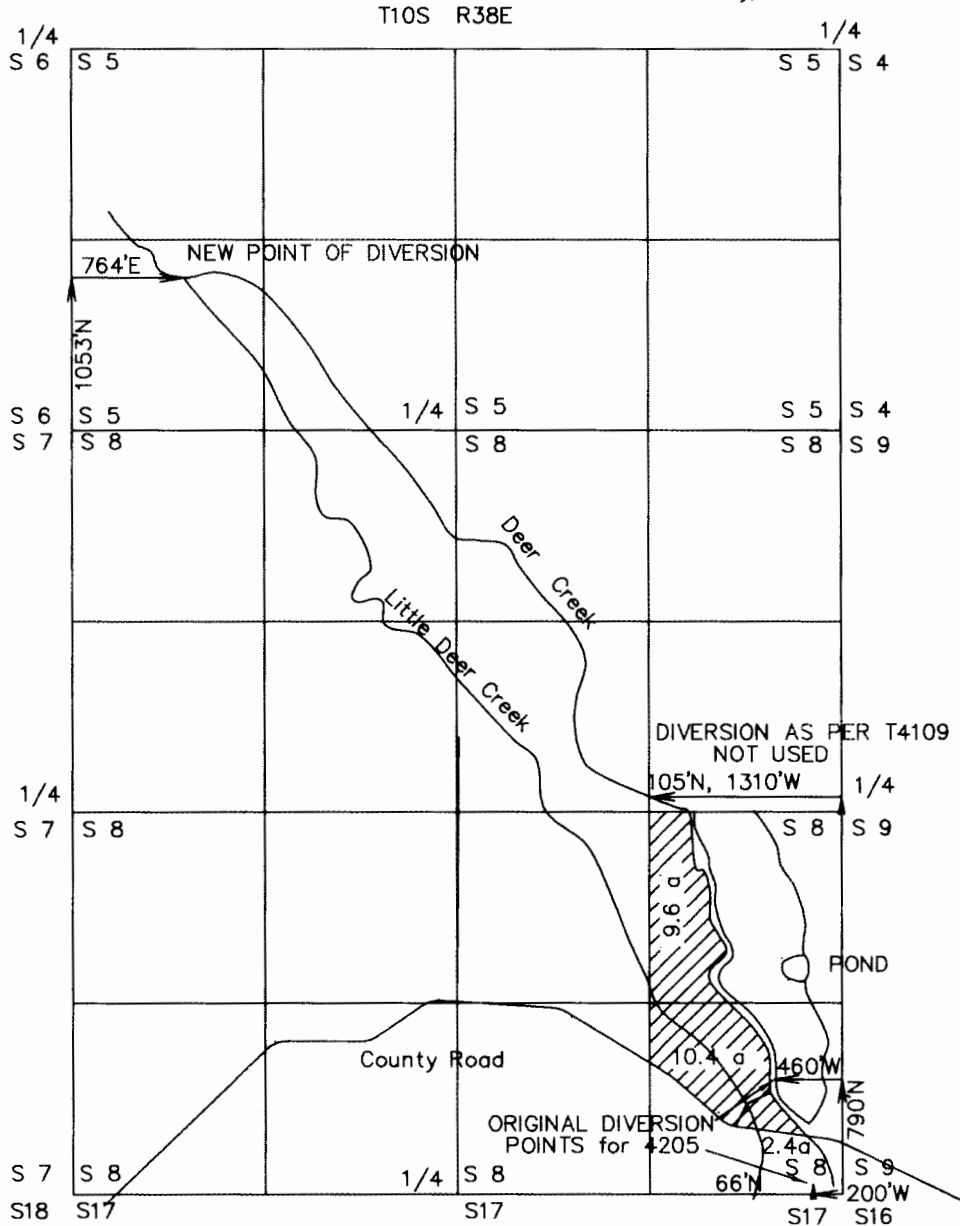

This map is for the purpose of identifying the location of the water right only and has no intent to provide dimensions or location of property ownership lines.

**RECEIVED**

SEP 29 1987

WATER RESOURCES DEPT.  
SALEM, OREGON