

Original mylar in FP cabinet

RECEIVED

SEP 30 1999

WATER RESOURCES DEPT
SALEM, OREGON

FINAL PROOF MAP

T.38S., R.8W., W.M.

APP. #T-7789, PER. #1049

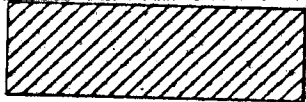
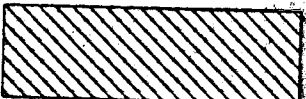

-  IRRIG UNDER APP. #T-7789 & PER. #1049
-  IRRIG UNDER CERT. 75118 NOT AFFECTED BY THIS TRANSFER

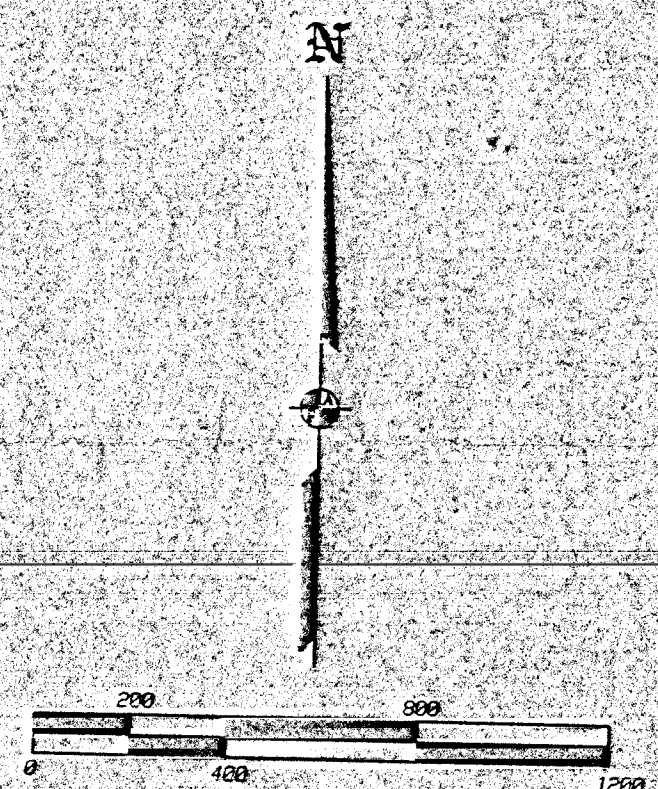
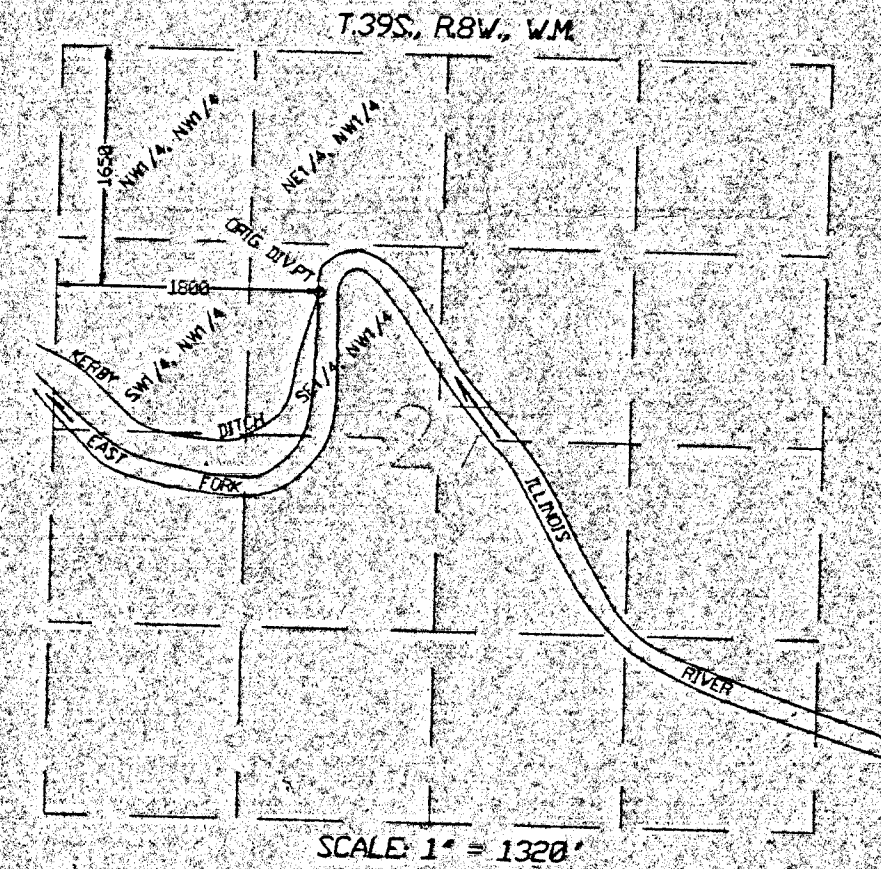

THE PREPARATION OF THIS MAP WAS FOR THE PURPOSE OF IDENTIFYING THE WATER RIGHT ONLY & HAS NO INTENT TO PROVIDE DIMENSION OR LOCATION OF PROPERTY OWNERSHIP LINES.

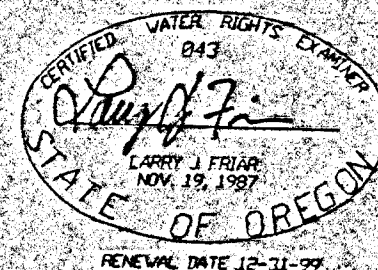

TITLE: FINAL PROOF MAP	DATE: 28 SEP 1999
ASSESSOR'S MAP #: 38-8-33 TL'S 600 & 800	SCALE: 1" = 1320 feet
FOR: JACK L. SAUER 22503 REDWOOD HIGHWAY KERBY, OR 97531 PH: 592-2978	DRAWN BY: JLH L.P. CHK BY:
	ORIGIN:
	ROTATION OF JOB: 97-149 SAUER
	Sheet 1 of 1

L.J. FRIAR & ASSOCIATES P.C.
CONSULTING LAND SURVEYORS
815 W. 8TH ST., HEIFORD, OR
503-778-2782