

# T.6S., R.2 & 3W., W.M.

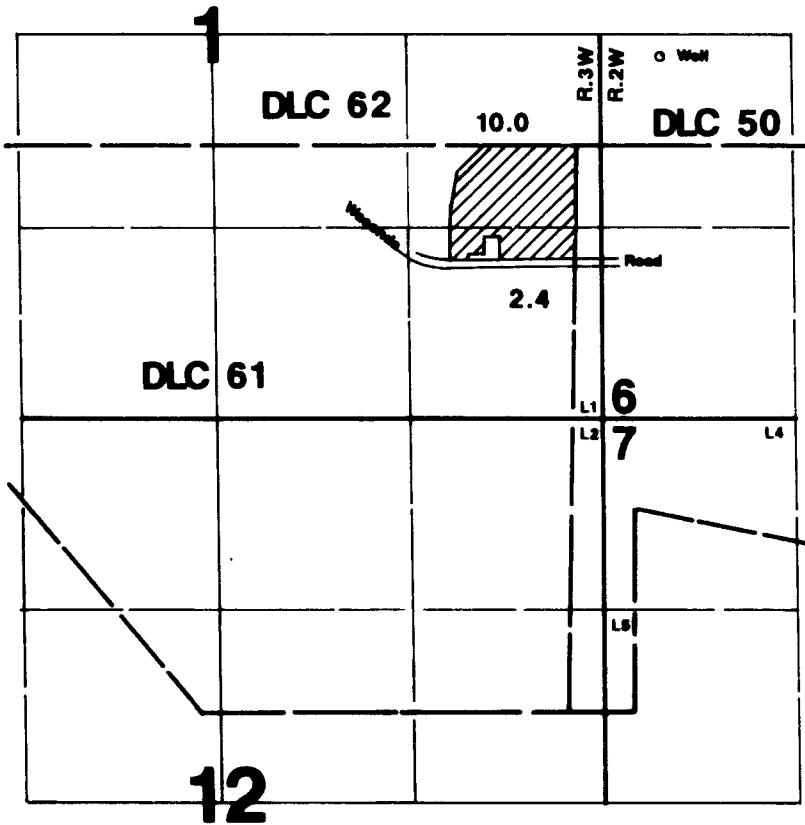

Well located 620'N & 620'E from NE corner DLC 61.

**RECEIVED**

**NOV 26 1997**

**WATER RESOURCES DEPT.  
SALEM, OREGON**

## Final Proof Survey

**Transfer #: T-7269**

In Name Of

## Ted V. Bell

Surveyed on November 24, 1997 by JM Schuette

THIS MAP WAS PREPARED FOR THE PURPOSE OF IDENTIFYING THE LOCATION OF A WATER RIGHT ONLY AND IS NOT INTENDED TO PROVIDE LEGAL DIMENSIONS OR LOCATION OF PROPERTY OWNERSHIP LINES.

