

FINAL PROOF SURVEY

UNDER

APPL. NO. R-70455
& 70456

PERMIT NO. R-11374
& 51232

IN THE NAME OF CRAIG WOODWARD/BIG SUMMIT PRAIRIE, INC.

PERMIT NO. R-11374 DATED JUNE 3, 1991 - 490.0 AC. FT. STORAGE
PERMIT NO. 51232 DATED JUNE 3, 1991 - SUPPL. IRRIGATION 410.0 AC.

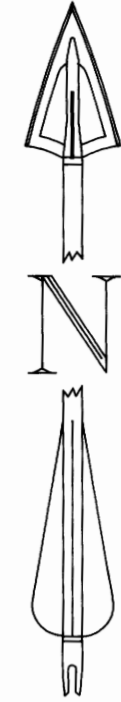

SCALE 1" = 1320'

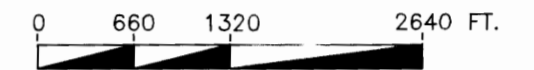

POINT OF DIVERSION TABLE

- #1 - LOCATED 2322' NORTH AND 217' WEST OF THE NORTH 1/4 CORNER SECTION 6, T14S, R21E
- #2 - LOCATED 55' SOUTH AND 383' WEST OF THE NORTH 1/4 CORNER SECTION 6, T14S, R21E
- #3 - LOCATED 180' SOUTH AND 521' WEST OF THE NORTH 1/4 CORNER SECTION 6, T14S, R21E

NOTES

1. PREPARATION OF THIS MAP IS FOR PURPOSES OF IDENTIFYING PROPOSED WATER RIGHTS ONLY. IT HAS NO INTENT TO PROVIDE LOCATIONS OR DIMENSIONS OF PROPERTY BOUNDARIES.
2. REFER ALSO TO FILES R-72027 AND S-72396 SUBMITTED AS SECONDARY APPLICATIONS AFTER PERMITS R-11374 AND 51232 WERE ISSUED.

LEGEND

- FOUND ALUMINUM CAP MONUMENT
- SECTION LINE
- - - 1/4, 1/4 SECTION LINE
- #1 ⊙ POINT OF DIVERSION - REFER TO TABLE FOR LOCATIONS
- EXISTING CREEK CHANNEL
- - - EXISTING DITCH
- ▨ SUPPLEMENTAL IRRIGATION AREAS PROOFED THIS SURVEY UNDER PERMIT NO. 51232 - PRIMARY RIGHTS UNDER PERMITS R-1554, 22573, 23391, R-1710, 23392, 24774, R-2000, 24775, R-5479, 34405, AND PRIOR RIGHTS AS SHOWN BY FINAL PROOF SURVEY FOR BOSTON RANCH CO. DATED JULY, 1970.
- ▨ AREA WITH WATER BEING APPLIED NOT COVERED UNDER PERMIT NO. 51232.
- ← FLOOD IRRIGATION FLOW DIRECTION

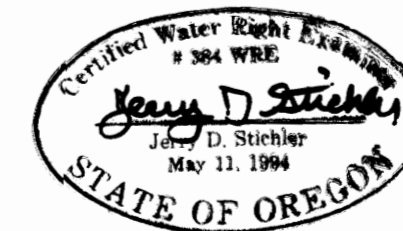
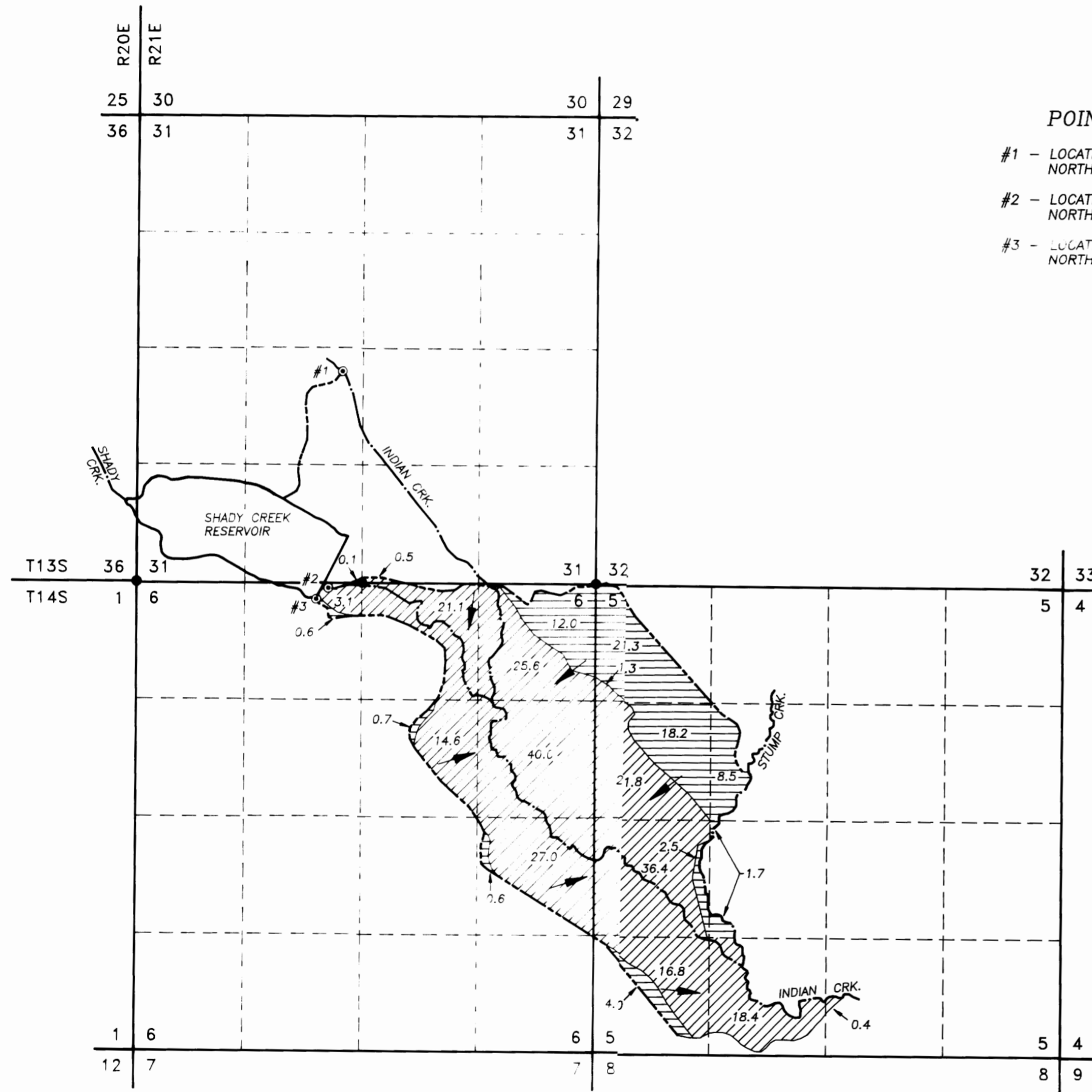

RENEWAL 12/31/94

PREPARED FOR:
BIG SUMMIT PRAIRIE, INC.
P.O. BOX 663
PRINEVILLE, OREGON 97754

PREPARED BY:
ANDERSON ENGINEERING & SURVEYING
539 SW 7TH STREET, P.O. BOX 419
REDMOND, OREGON 97756
(503) 923-4307 (503) 923-4308 FAX
OCT. 24, 1994 SHEET 1 OF 1

DRAWN BY: J.S. JOB NO. 94/49R

COGO: 9449WFP ACAD: 9449WFP