

FINAL PROOF MAP

TO TRANSFER RIGHTS AND
CHANGE POINT OF APPROPRIATION
FOR T-11037
TIM WARKENTIN

TOWNSHIP 25 SOUTH, RANGE 18 EAST, SECTION 9, W.M.
TAX LOTS: 2100 AND 2300

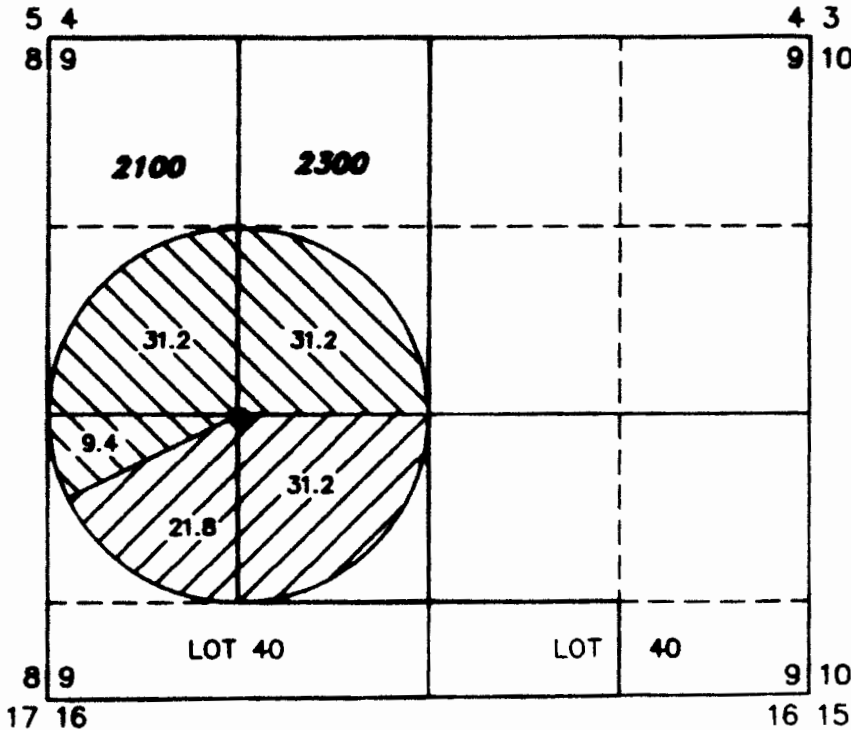

RECEIVED

APR 17 2012

WATER RESOURCES DEPT
SALEM, OREGON

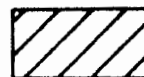

53.0 ACRES WATER RIGHTS FROM
CERTIFICATE #00220 (G-10326),
AS SHOWN.



71.8 ACRES WATER RIGHTS FROM
CERTIFICATE #00221 (G-0074),
AS SHOWN.



RENEWAL DATE: 12/31/2012

● **LAKE 51272**

NEW WELL LOCATED IN THE NE 1/4 SW 1/4 SECTION 9,
T25S R18E, W.M. AND 20 FEET SOUTH AND 1390 FEET
EAST FROM THE WEST 1/4 CORNER OF SECTION 9.

NEWLY INSTALLED METER IS APPROXIMATELY 11.0
FEET EAST ALONG DELIVERY PIPE FROM WELL.

THIS MAP IS FOR THE PURPOSE OF LOCATING A WATER
RIGHT ONLY AND HAS NO INTENT TO PROVIDE LEGAL
DIMENSIONS OR THE LOCATION OF PROPERTY LINES

PREPARED FOR:

TIM WARKENTIN
P.O. BOX 12
CHRISTMAS VALLEY, OR 97641

PREPARED BY:



ALL POINTS ENGINEERING AND SURVEYING, INC.
P.O. BOX 767 (CRR) TERREBONNE, OR 97760
(541) 548-5833
www.APEandS.com